

PLANT LIST

Qty.	Common Name	Botanical Name	Size	Remarks	Key
3	Regal Prince English Oak	Quercus robur 'Regal Prince'	4.0"	B&B	QRRP #
11	Triumph Elm	Ulmus 'Morton Glossy'	2.5"	B&B	UMG
1	Autumn Brilliance Serviceberry	Amelanchier grandiflora	6'	B&B	AGAB
18	Norway Spruce	Picea abies	11'-12'	B&B	PA
16	Black Hills Spruce	Picea glauca 'Densata'	11'-12'	B&B	PGD
13	Douglas Fir	Pseudotsuga menziesii	8'-9	B&B	PM
30	Techny Arborvitae	Thuja occidentalis 'Techny'	6'	B&B	TOT
23	Low Scape Mound Chokeberry	Aronia melanocarpa 'Low Scape Mound'	24"	Cont.	AMLS
3	Green Gem Boxwood	Buxus 'Green Gem'	24"	Cont.	BGG
77	Sunrise Forsythia	Forsythia ovata 'Sunrise'	30"	Cont.	FOS
5	Incrediball Hydrangea	Hydrangea arborescens 'Abetwo'	24"	Cont.	HAA
3	Green Sargent Juniper	Juniperus chinensis 'Green Sargent'	24"	Cont.	JCGS
11	Miss Kim Lilac	Syringa patula 'Miss Kim'	24"	Cont.	SPMK
174	Blue Muffin Viburnum	Viburnum dentatum 'Blue Muffin'	30"	Cont.	VDBM
86	Happy Returns Daylily	Heemerocallis 'Happy Returns'	#1	Pots	HHR

# High Branched



SCALE: 1"=30'



REVISIONS:  
12.20.20 (VILLAGE REVIEW)  
01.12.21 (VILLAGE REVIEW)  
02.03.21 (VILLAGE REVIEW)

DOWNDEN DESIGN GROUP  
P.O. BOX 415, LIBERTYVILLE, IL 60048  
DOWNDENDSGROUP.COM PHONE: (847) 362-1254

HAMILTON PARTNERS ARLINGTON HEIGHTS INDUSTRIAL  
PHASE 2 (FRITO-LAY)  
WEST ALCONQUIN ROAD  
ARLINGTON HEIGHTS, ILLINOIS

LANDSCAPE  
PLAN

DATE: 11.09.20  
SCALE: 1"=30'  
DARIUS CJD

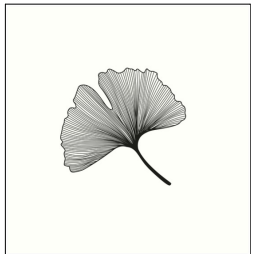

LIOI



EAST BUILDING ENTRANCE

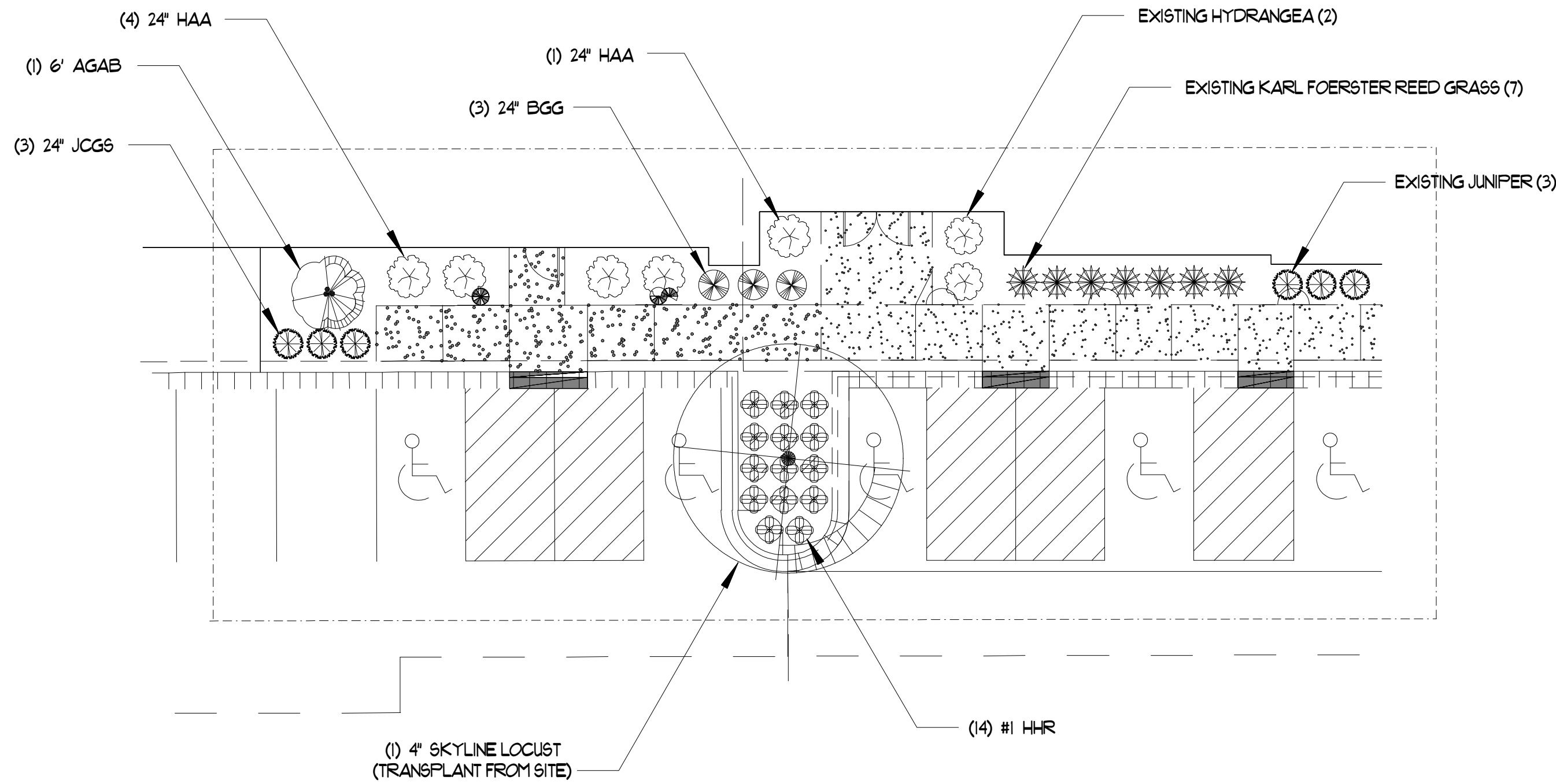

SCALE: 1"=10'

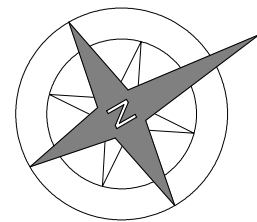

NOTES:

- 1) THE CONTRACTOR SHALL PROVIDE AND INSTALL ALL PLANT MATERIALS IN QUANTITIES SUFFICIENT TO COMPLETE PLANTING AS SHOWN ON THE DRAWING. ALL PLANTS SHALL COMPLY WITH THE REQUIREMENTS OF THE CURRENT AMERICAN STANDARD FOR NURSERY STOCK, PUBLISHED BY THE AMERICAN NURSERY AND LANDSCAPE ASSOCIATION. PLANTS SHALL MEET SIZE, GENUS, SPECIES AND VARIETY AND BE IN GOOD HEALTH, FREE OF INSECTS, DISEASES, OR DEFECTS. NO "PARK GRADE" MATERIAL SHALL BE ACCEPTED. TREES NOT EXHIBITING A CENTRAL (OR SINGLE) LEADER WILL BE REJECTED UNLESS CALLED IN THE PLANT LIST AS MULTI-STEM. QUANTITY LISTS ARE SUPPLIED AS A CONVENIENCE. THE LANDSCAPE CONTRACTOR SHALL VERIFY ALL QUANTITIES AND, IN CASE OF DISCREPANCY, THE PLAN SHALL PREVAIL. NO PLANTS ARE TO BE CHANGED OR SUBSTITUTED WITHOUT APPROVAL FROM A REPRESENTATIVE OF JAMES DOWDEN & ASSOCIATES, INC.
- 2) ALL PLANTS SHALL BE WATERED DURING THE FIRST 24 HOUR PERIOD FOLLOWING INSTALLATION. A WATERING SCHEDULE MUST BE AGREED UPON WITH THE OWNER (BEFORE PLANTINGS ARE INSTALLED) OF WHOM, WHEN AND HOW PLANT MATERIALS ARE TO BE PROPERLY WATERED. THE LANDSCAPE CONTRACTOR SHALL VERIFY PROPER WATERING IS BEING DONE FOR THE ESTABLISHMENT AND HEALTH OF ALL PLANT MATERIALS. THE LANDSCAPE CONTRACTOR SHALL WARRANTY ALL PLANT MATERIALS FOR ONE YEAR FROM THE TIME OF INSTALLATION AND PROJECT ACCEPTANCE.
- 3) PLANTS SHALL BE BALLED AND BURLAPPED UNLESS OTHERWISE NOTED ON THE LANDSCAPE PLAN. NO ROOT BOUND MATERIAL SHALL BE ACCEPTED AND ALL WRAPPING MATERIALS MADE OF SYNTHETICS OR PLASTICS SHALL BE REMOVED AT THE TIME OF PLANTING. IT IS THE OPTION OF THE LANDSCAPE CONTRACTOR TO ROLL BACK BURLAP FROM THE TOP OF THE ROOT BALL.
- 4) RECOMMENDED MULCH DEPTH IS THREE INCHES (3") OF SHREDDED HARDWOOD BARK. THE LANDSCAPE CONTRACTOR SHALL AVOID OVERMULCHING AND THE CREATION OF "MULCH VOLCANOES". MULCH BEDS SHALL EXTEND A MINIMUM OF TWO FEET (2') BEYOND THE CENTER OF A TREE OR SHRUB. MULCH MUST BE PULLED BACK AT LEAST TWO INCHES (2") FROM THE BASE OF A TREE SO THE BASE OF THE TRUNK AND ROOT CROWN ARE EXPOSED.
- 5) PREPARE ALL PERENNIAL BEDS WITH ONE CUBIC YARD OF GARDEN COMPOST PER 100 SF AND THE COMPOST SHALL BE ROTOTILLED TO AN 8" DEPTH.
- 6) ALL PLANTS SHALL BE SET PLUMB. IT IS THE OPTION OF THE LANDSCAPE CONTRACTOR TO STAKE DECIDUOUS TREES BUT IT IS ALSO THE RESPONSIBILITY OF THE LANDSCAPE CONTRACTOR TO GUARANTEE THE PLANTS REMAIN PLUMB UNTIL THE END OF THE GUARANTEE PERIOD.
- 7) TREES SHALL BE INSTALLED A MINIMUM OF FIVE FEET (5') HORIZONTALLY FROM UNDERGROUND ELECTRICAL FEEDERS, SANITARY SEWERS, SANITARY SERVICES, WATER MAINS, AND WATER SERVICES. TREES SHALL BE INSTALLED A MINIMUM OF TEN FEET (10') HORIZONTALLY FROM UTILITY STRUCTURES INCLUDING, BUT NOT LIMITED TO, MANHOLES, VALVE VAULTS AND VALVE BOXES. SHADE TREES SHALL BE A MINIMUM OF TEN FEET (10') FROM ALL LIGHT POLES AND ALL SHRUBS SHALL BE A MINIMUM OF THREE TO FIVE FEET (3'-5') FROM ALL FIRE HYDRANTS.
- 8) THE LANDSCAPE CONTRACTOR SHALL LOCATE THE EXISTENCE OF ALL UNDERGROUND UTILITIES PRIOR TO STARTING WORK. THE LANDSCAPE CONTRACTOR MUST ALSO KEEP THE PAVEMENT AND WORK AREAS IN NEAT AND ORDERLY CONDITION THROUGHOUT THE CONSTRUCTION PROCESS. THE LANDSCAPE CONTRACTOR SHALL ACQUAINT HIMSELF WITH, AND VERIFY, WORKING CONDITIONS IN ADVANCE OF SUBMITTING A PROPOSAL. FAILURE TO RECOGNIZE INHERENT RESPONSIBILITIES DOES NOT RELIEVE THE CONTRACTOR OF OBLIGATIONS DUE TO MISCALCULATIONS.
- 9) PROPERTY OWNERS SHALL BE RESPONSIBLE FOR MAINTAINING ALL LANDSCAPING SHOWN ON THE APPROVED PLANS THROUGHOUT THE LIFE OF THE DEVELOPMENT.
- 10) ALL TURF SHALL BE PREMIUM BLUEGRASS MIX (4-5 LBS/1,000 SF) WITH NORTH AMERICAN GREEN D675, OR EQUIVALENT, EROSION CONTROL BLANKET IN ALL DISTURBED AREAS.

PREMIUM BLUEGRASS MIX 4-5 LBS PER 1,000 SF

- 20% MIDNIGHT KENTUCKY BLUEGRASS
- 20% DENIM KENTUCKY BLUEGRASS
- 20% LANGARA KENTUCKY BLUEGRASS
- 20% BLUESTAR KENTUCKY BLUEGRASS
- 10% PRIZM PERENNIAL RYEGRASS
- 10% SUNSHINE PERENNIAL RYEGRASS

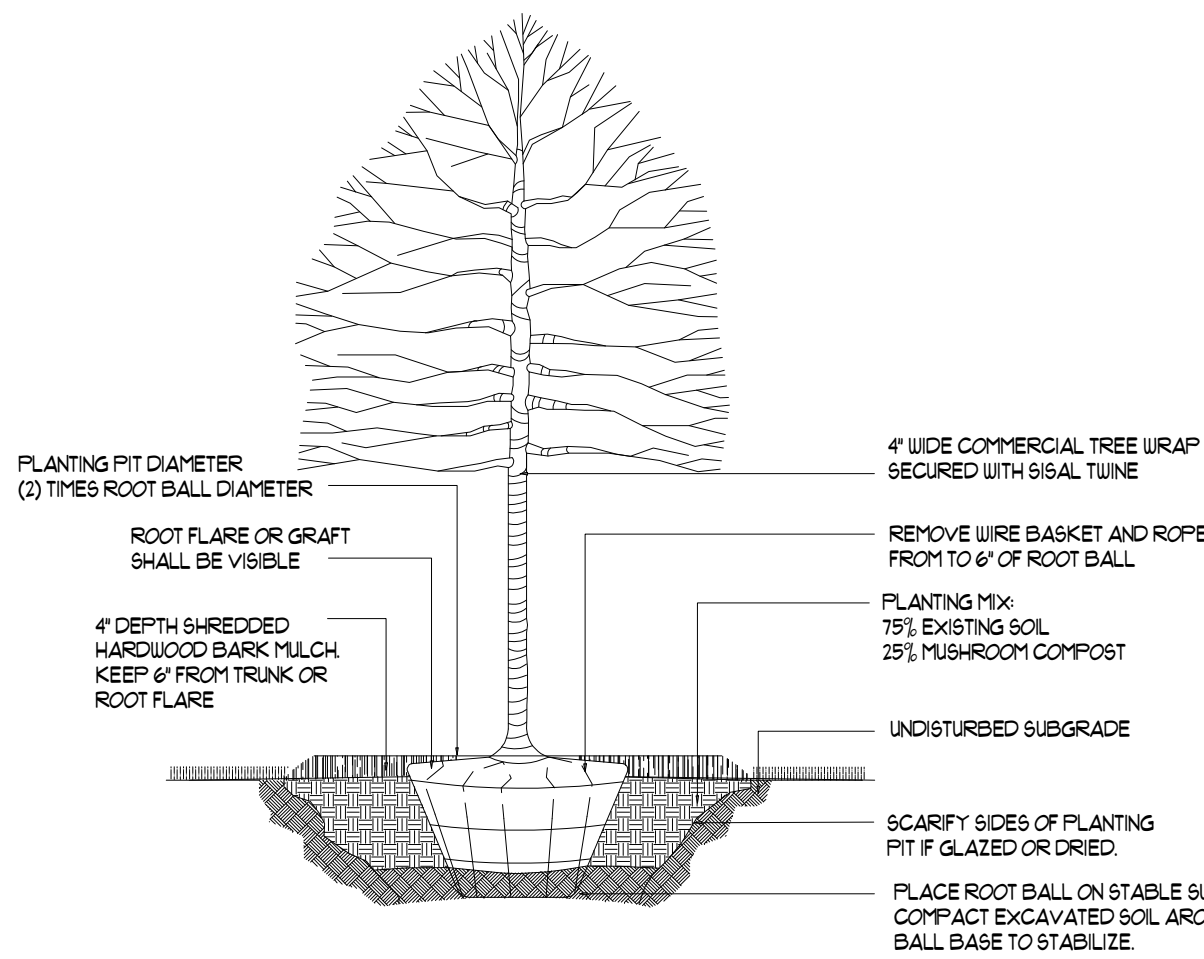

DETAIL  
DECIDUOUS TREE PLANTING

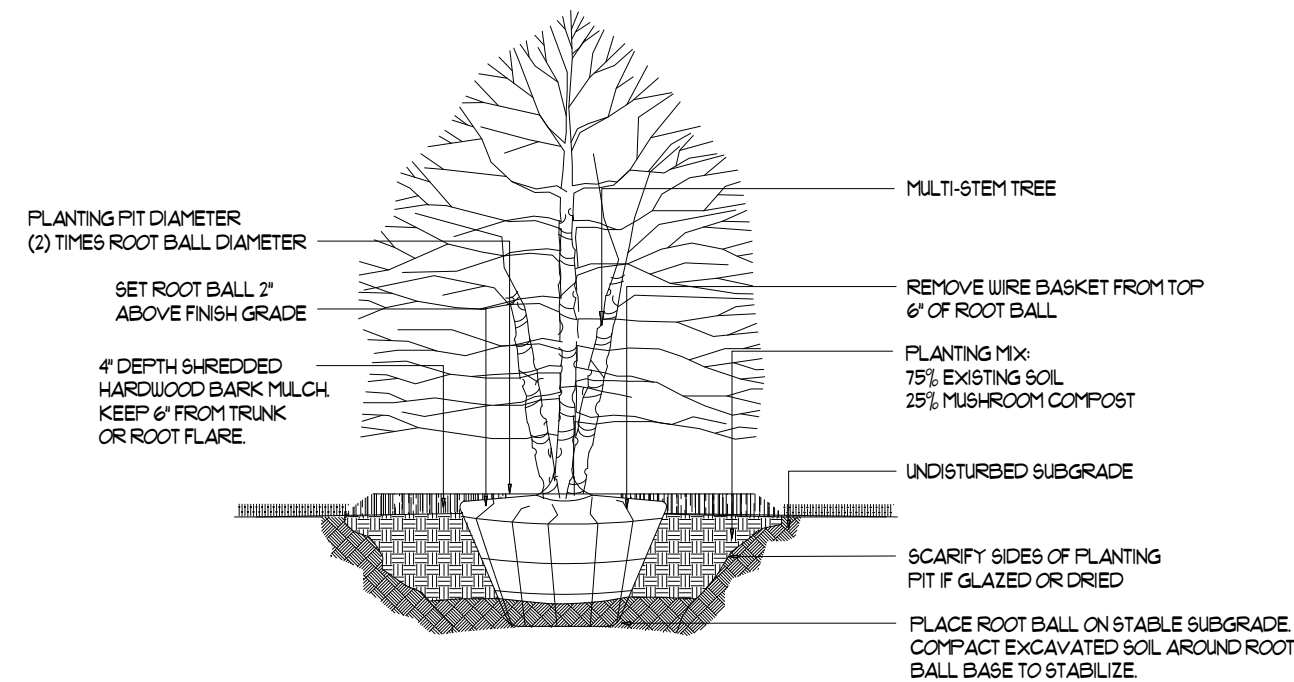

DETAIL  
DECIDUOUS ORNAMENTAL TREE PLANTING

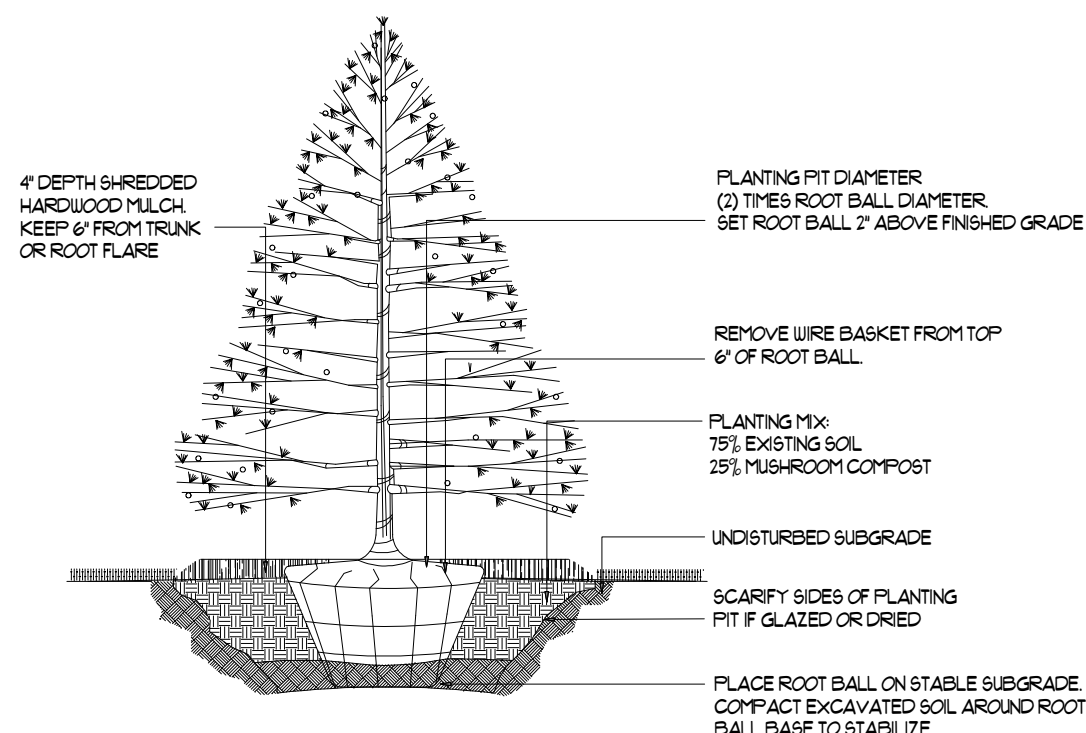

DETAIL  
EVERGREEN TREE PLANTING

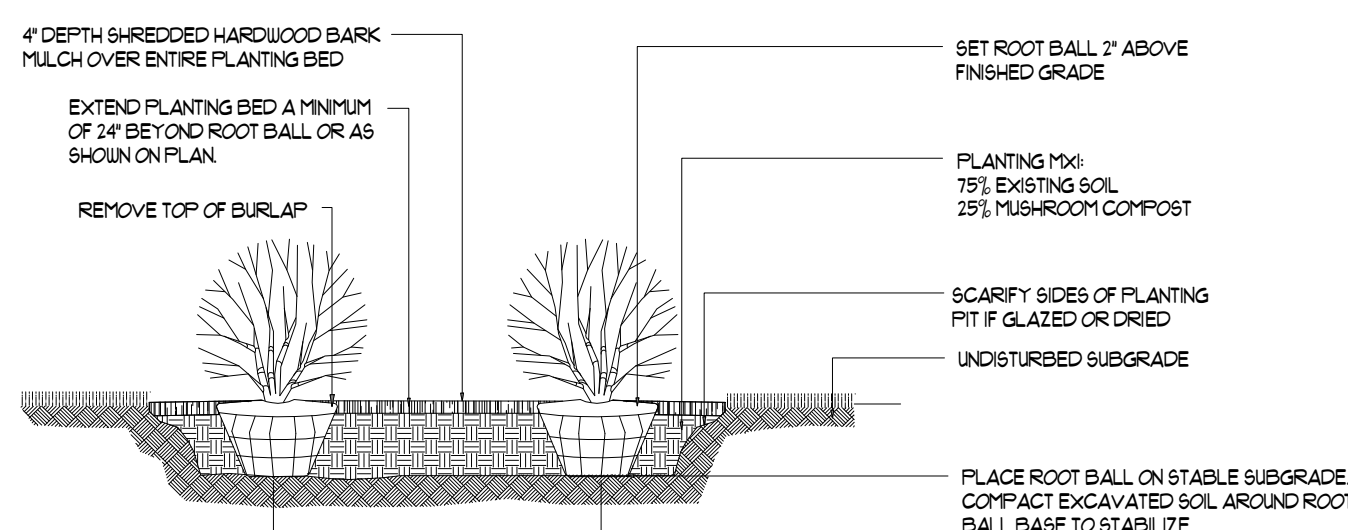

DETAIL  
SHRUB PLANTING

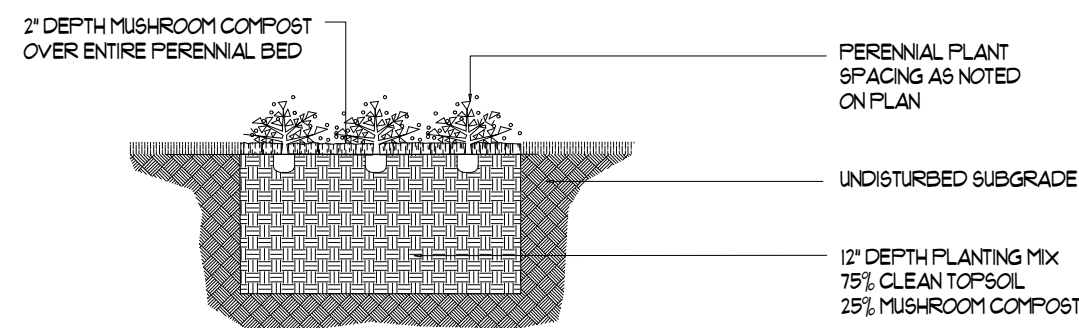

DETAIL  
PERENNIAL PLANTING

REVISIONS:  
12.20.20 (VILLAGE REVIEW)  
01.13.21 (VILLAGE REVIEW)  
02.09.21 (VILLAGE REVIEW)

DOWDEN DESIGN GROUP  
P.O. BOX 415, LIBERTYVILLE, IL, 60048  
DOWDENDESIGNGROUP.COM PHONE: (847) 362-1254

HAMILTON PARTNERS ARLINGTON HEIGHTS INDUSTRIAL  
PHASE 2 (FRITO-LAY)  
WEST ALCONQUIN ROAD  
ARLINGTON HEIGHTS, ILLINOIS

LANDSCAPE  
PLAN

DATE: 11.09.20  
SCALE: 1"=10'  
DRAWN: CJD

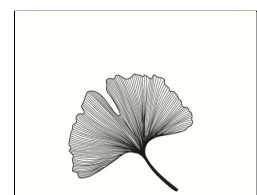

L102



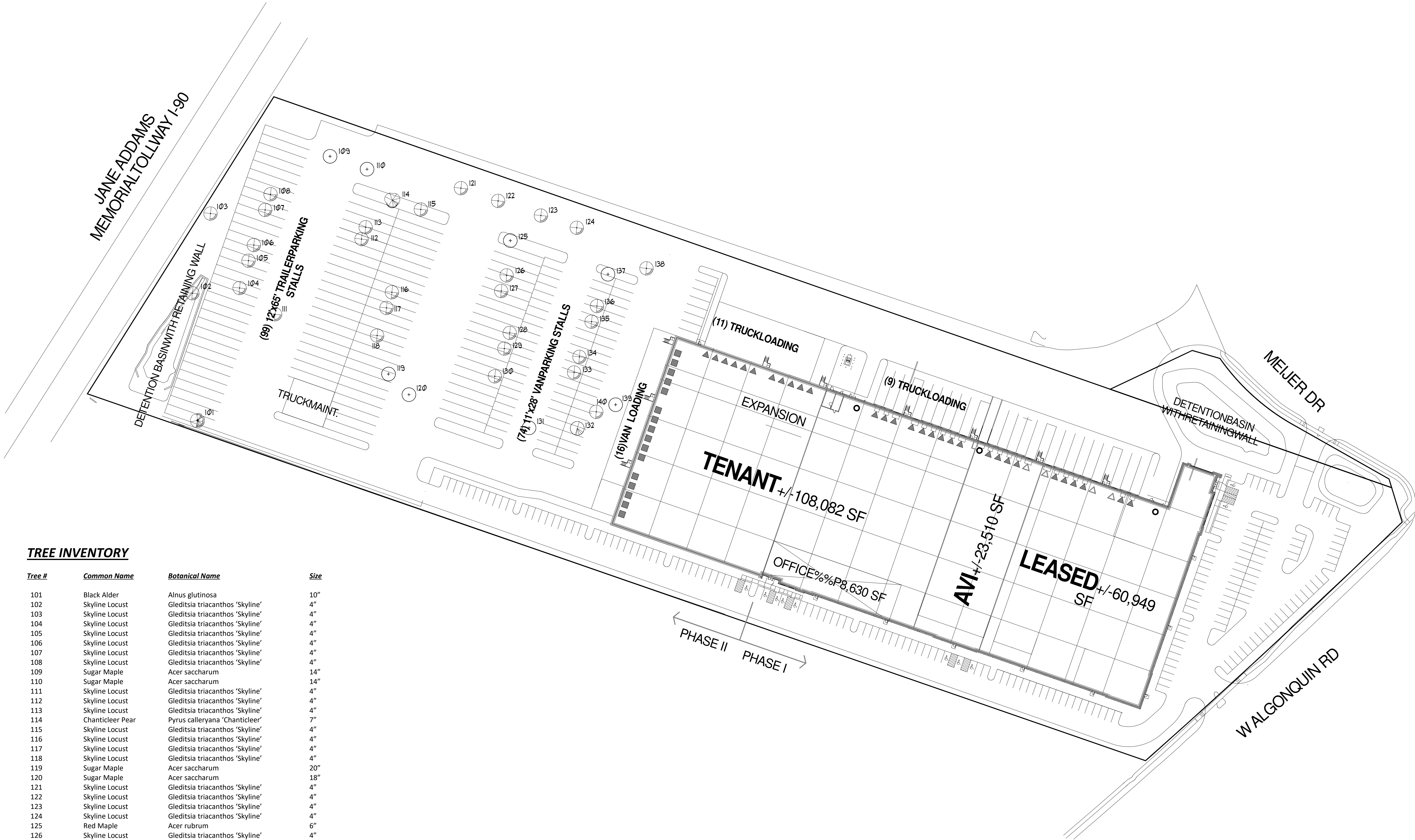

TREE INVENTORY

Tree #	Common Name	Botanical Name	Size
101	Black Alder	Alnus glutinosa	10"
102	Skyline Locust	Gleditsia triacanthos 'Skyline'	4"
103	Skyline Locust	Gleditsia triacanthos 'Skyline'	4"
104	Skyline Locust	Gleditsia triacanthos 'Skyline'	4"
105	Skyline Locust	Gleditsia triacanthos 'Skyline'	4"
106	Skyline Locust	Gleditsia triacanthos 'Skyline'	4"
107	Skyline Locust	Gleditsia triacanthos 'Skyline'	4"
108	Skyline Locust	Gleditsia triacanthos 'Skyline'	4"
109	Sugar Maple	Acer saccharum	14"
110	Sugar Maple	Acer saccharum	14"
111	Skyline Locust	Gleditsia triacanthos 'Skyline'	4"
112	Skyline Locust	Gleditsia triacanthos 'Skyline'	4"
113	Skyline Locust	Gleditsia triacanthos 'Skyline'	4"
114	Chanticleer Pear	Pyrus calleryana 'Chanticleer'	7"
115	Skyline Locust	Gleditsia triacanthos 'Skyline'	4"
116	Skyline Locust	Gleditsia triacanthos 'Skyline'	4"
117	Skyline Locust	Gleditsia triacanthos 'Skyline'	4"
118	Skyline Locust	Gleditsia triacanthos 'Skyline'	4"
119	Sugar Maple	Acer saccharum	20"
120	Sugar Maple	Acer saccharum	18"
121	Skyline Locust	Gleditsia triacanthos 'Skyline'	4"
122	Skyline Locust	Gleditsia triacanthos 'Skyline'	4"
123	Skyline Locust	Gleditsia triacanthos 'Skyline'	4"
124	Skyline Locust	Gleditsia triacanthos 'Skyline'	4"
125	Red Maple	Acer rubrum	6"
126	Skyline Locust	Gleditsia triacanthos 'Skyline'	4"
127	Skyline Locust	Gleditsia triacanthos 'Skyline'	4"
128	Skyline Locust	Gleditsia triacanthos 'Skyline'	4"
129	Skyline Locust	Gleditsia triacanthos 'Skyline'	4"
130	Skyline Locust	Gleditsia triacanthos 'Skyline'	4"
131	Sugar Maple	Acer saccharum	16"
132	Common Hackberry	Celtis occidentalis	10"
133	Skyline Locust	Gleditsia triacanthos 'Skyline'	4"
134	Skyline Locust	Gleditsia triacanthos 'Skyline'	4"
135	Skyline Locust	Gleditsia triacanthos 'Skyline'	4"
136	Skyline Locust	Gleditsia triacanthos 'Skyline'	4"
137	Red Maple	Acer rubrum	6"
138	Skyline Locust	Gleditsia triacanthos 'Skyline'	4"
139	Sugar Maple	Acer saccharum	12"
140	Skyline Locust	Gleditsia triacanthos 'Skyline'	4"

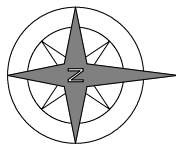
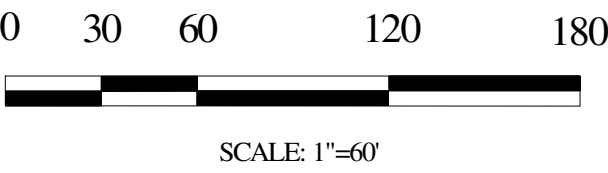

REVISIONS:  
12.20.20 (VILLAGE REVIEW)  
01.12.21 (VILLAGE REVIEW)  
02.09.21 (VILLAGE REVIEW)

DOWNDEN DESIGN GROUP  
P.O. BOX 415, LIBERTYVILLE, IL, 60048  
DOWNDENDSGROUP.COM PHONE: (847) 362-1254

HAMILTON PARTNERS ARLINGTON HEIGHTS INDUSTRIAL  
PHASE 2 (FRITO-LAY)  
WEST ALGONQUIN ROAD  
ARLINGTON HEIGHTS, ILLINOIS

LANDSCAPE  
PLAN

DATE: 11.03.20  
SCALE: 1"=60'  
DRAWN: CJD

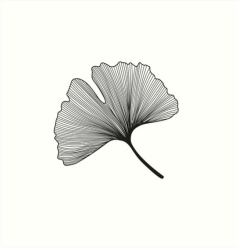

LI03