



To: Sam Hubbard
Development Planner
Department of Planning and Community Development
Village of Arlington Heights

RECEIVED
NOV 22 2022
PLANNING & COMMUNITY
DEVELOPMENT DEPARTMENT

From: Ryan Schulz
Director of Facilities Management
Arlington Heights School District 25

Date: November 18th, 2022

Re: Dryden Elementary School Expansion Neighborhood Meeting October 19th, 2022

Sam,

On October 19th, 2022 at 6:00 pm, we hosted the required neighborhood meeting for property owners within 250' of the subject property to give a brief overview of the project scope and answer any questions they may have. The meeting was held in the commons at Dryden Elementary School. There was (1) neighbor in attendance at the meeting. Below are the questions the attendee asked during the presentation and our initial response based on the current progress of the design. I have also included a copy of the sign-in sheet as well as the presentation that was used for the neighbors.

- **What is the potential impact of stormwater from the site?**
 - AHSD25 and the Village of Arlington Heights are collaborating on stormwater solutions for the site and potentially will be working on a joint venture project to capture stormwater from the Dryden site and also portions of the surrounding neighborhood.
- **Will rooftop equipment be screened?**
 - AHSD25 intends to screen any larger rooftop equipment as required under Village zoning requirements or per the recommendation of the contractor.
- **Will there be any impact on playground spaces at the building?**
 - We do not anticipate any changes to the existing playground structure at Dryden. The existing asphalt play areas will be impacted and will likely need to be relocated after the completion of the project. We anticipate the new asphalt play area will continue to be on the southern side of the school building in its new configuration.

- **Will the traffic pattern for the school be impacted after construction?**
 - We anticipate the current drop-off and pick-up flow for the building will remain relatively unchanged after construction as the current parking lot provides adequate opportunity for bus traffic and vehicular traffic during the drop-off and pick-up periods of the day.

AHSD25 Meeting Attendees: Dr. Lori Bein, Superintendent, Mrs. Stacey Mallek, Assistant Superintendent for Business, Ryan Schulz, Director of Facilities Management.

Sincerely,

A handwritten signature in black ink, appearing to read "Ryan Schulz", with a stylized flourish at the end.

Ryan Schulz
Director of Facilities Management



Arlington Heights School District 25 - Neighborhood Meeting Sign In Sheet

Meeting: Dryden Elementary School Addition

Facilitator: Arlington Heights School District 25

Place/Room: Dryden Elementary School Commons

Date: October 19th, 2022

Time: 6:00 pm

PRINT NAME	Address	Phone
1. <u>CARRIE McNAMARA</u>	<u>705 S. Lincoln, Arlington Heights IL</u>	
2.	<u>60005</u>	
3.		
4.		
5.		
6.		
7.		
8.		
9.		
10.		
11.		
12.		
13.		
14.		
15.		
16.		
17.		
18.		
19.		
20.		
21.		
22.		
23.		
24.		
25.		



Dryden Expansion

Neighborhood Review Meeting

October 19th, 2022





Dryden Expansion

Why Now?

- **Full Day Kindergarten Program**
 - *Need additional classrooms since currently (1) single classroom can be shared between AM section and PM section.*
- **Increase in Enrollment**
 - *Anticipated Kindergarten enrollment bump due to transition to full day model.*
 - *Slight General Enrollment Increase.*
- **Gym Expansion**
 - *Currently the only AHSD25 elementary school without a dedicated commons / lunch room.*

Proposed addition will support future enrollment, full day K, provide dedicated commons / lunch and allow the building flexibility in their programming and support services.

Dryden Anticipated Enrollment

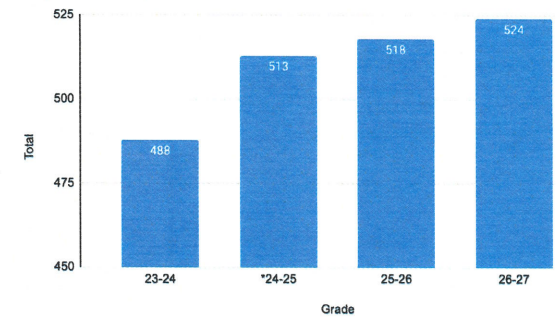

**24-25 First Year of Full Day K

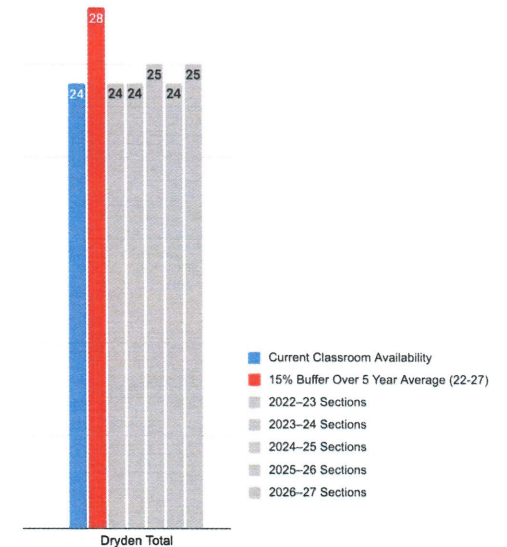



Half Day K Model

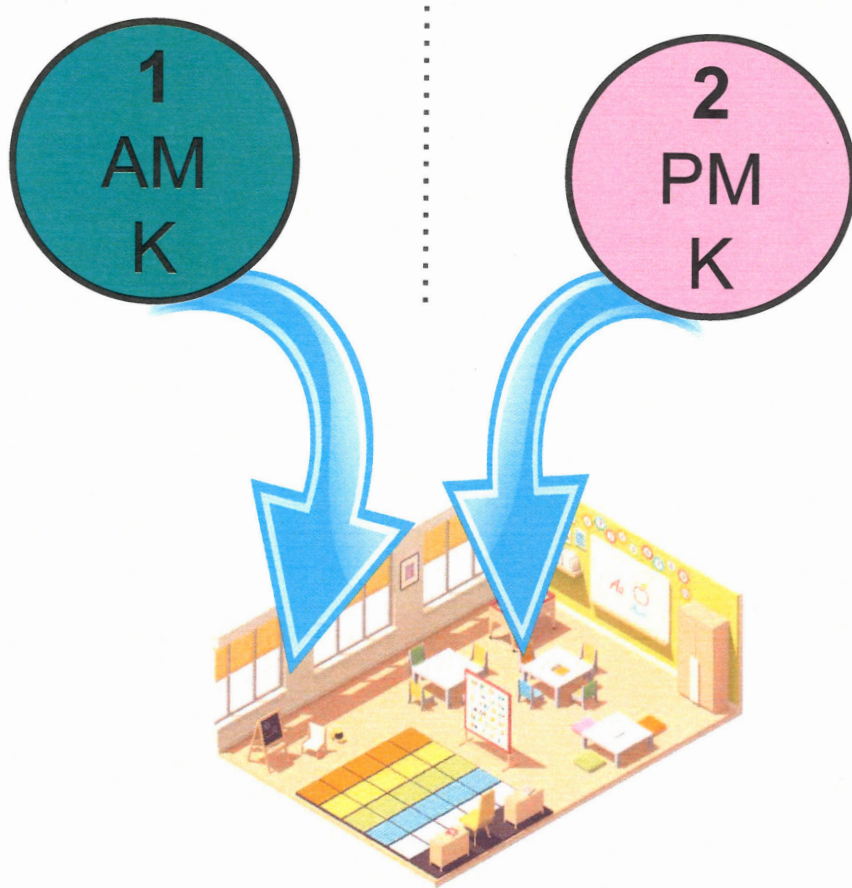

Full Day K Model

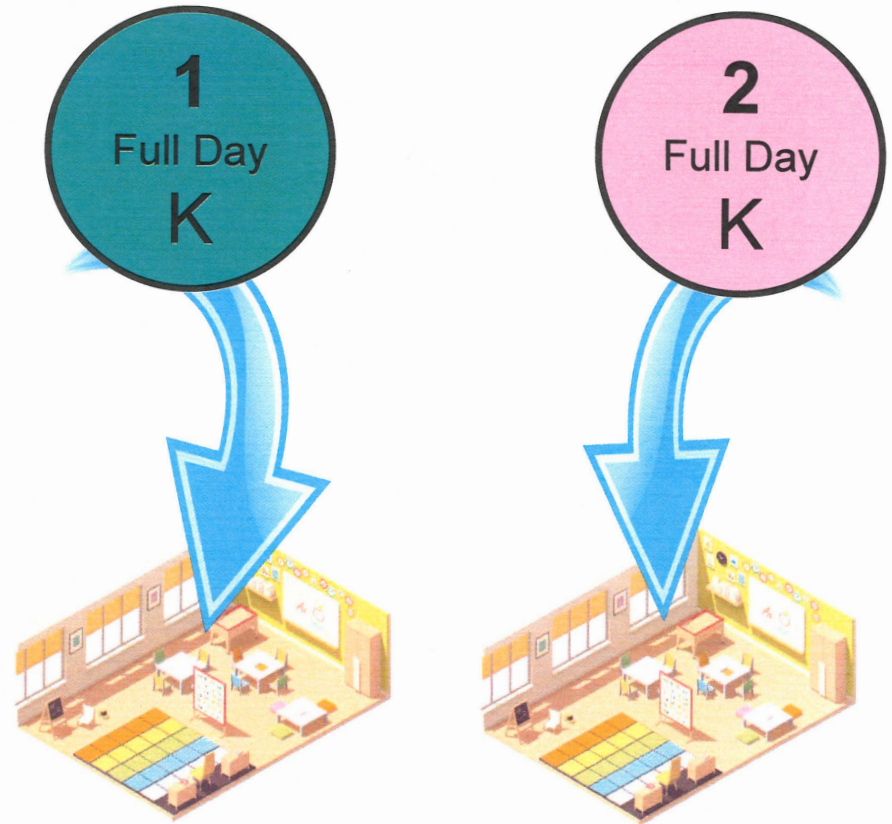



Anticipated Kindergarten Enrollment Bump

- Kindergarten enrollment is currently lower than first grade enrollment due to the current ½ day kindergarten model
- Parents currently choose other kindergarten options to provide full day learning opportunities.
- Kindergarten enrollment is expected to be more aligned with first grade enrollment once Full Day K is implemented as parents choose to send their child to their neighborhood school

Dryden K vs 1st Grade Enrollment

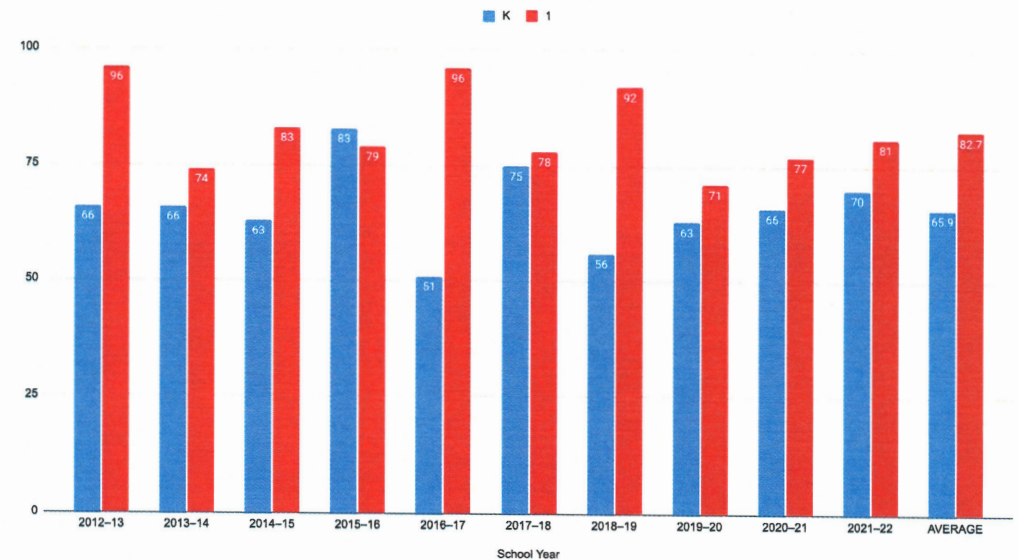



Dryden Elementary School

722 S Dryden Place | Arlington Heights, IL 60005



CONCEPTUAL LOCATION MAP

October 19th, 2022





Parking and Traffic

- Dryden uses a combination of street and parking lot lanes for drop off and pick up
- Variation to decrease the number of required onsite parking spaces from 68 to 57. Note Dryden has access to 187 parking spaces due to a license agreement with nearby church.
 - This sharing arrangement is more efficient and allows more green space to be maintained for community use

October 19th, 2022

Dryden Elementary School

722 S Dryden Place | Arlington Heights, IL 60005





Dryden Elementary School

722 S Dryden Place | Arlington Heights, IL 60005

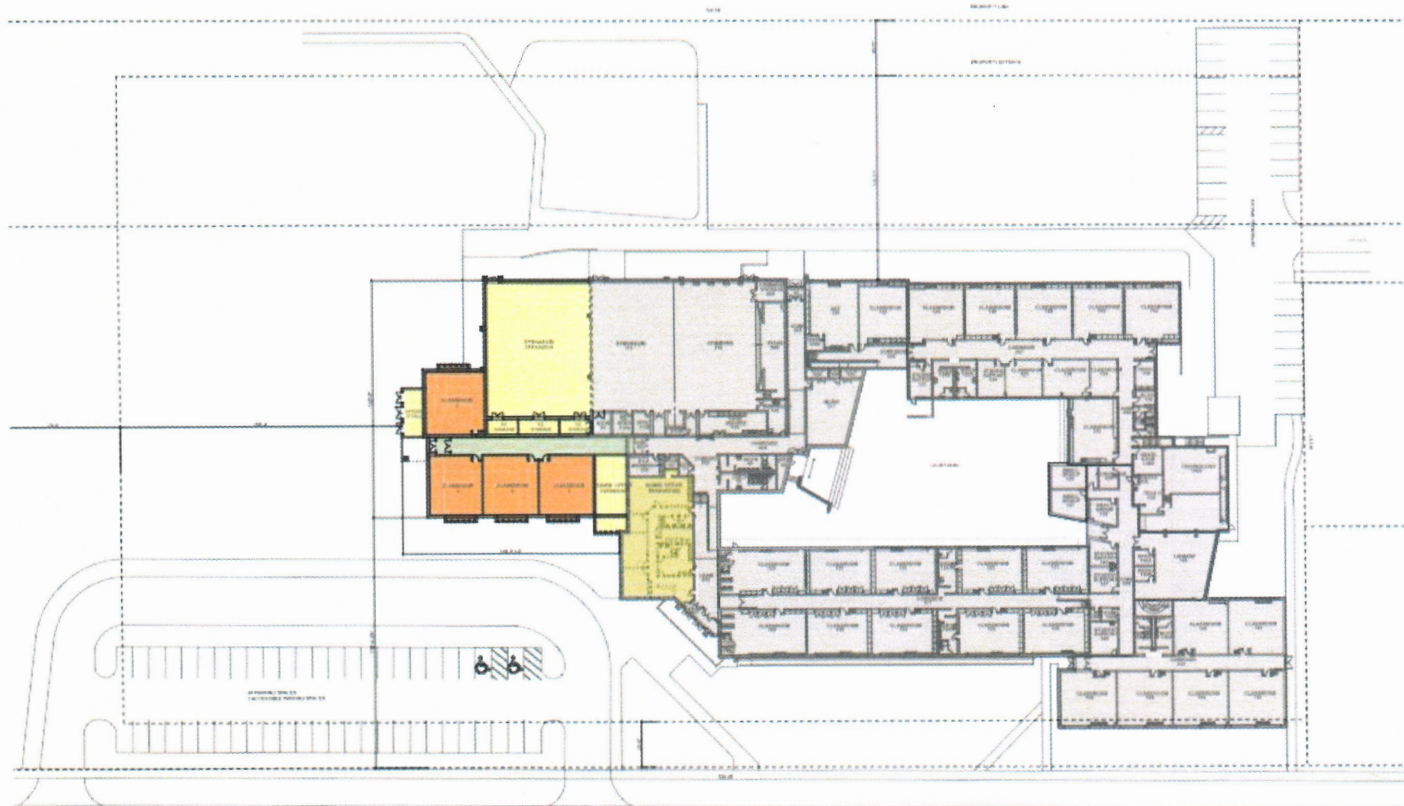

1 SITE PLAN
SCALE 1" = 10'



SITE PLAN - CONCEPTUAL

October 19th, 2022 7



Dryden Elementary School

722 S Dryden Place | Arlington Heights, IL 60005



1 FLOOR PLAN
SCALE: 1/16" = 1'-0"

FLOOR PLAN - CONCEPTUAL

October 19th, 2022 8



Dryden Elementary School

722 S Dryden Place | Arlington Heights, IL 60005



Preliminary Renderings Subject to Change

1 SOUTHEAST VIEW
SCALE: 1/32" = 1'-0"



2 SOUTHWEST VIEW
SCALE: 1/32" = 1'-0"

October 19th, 2022



Dryden Elementary School
722 S Dryden Place | Arlington Heights, IL 60005



Next Steps

- VAH Staff, Committee and Trustee reviews
- Continued design development
- Project(s) out to bid in spring of 2023
- Break ground Spring 2023
- Projects complete Fall 2024
 - Full Day Kindergarten begins Fall of 2024



Dryden Elementary School
722 S Dryden Place | Arlington Heights, IL 60005



Questions?

