

North Arlington Heights Road

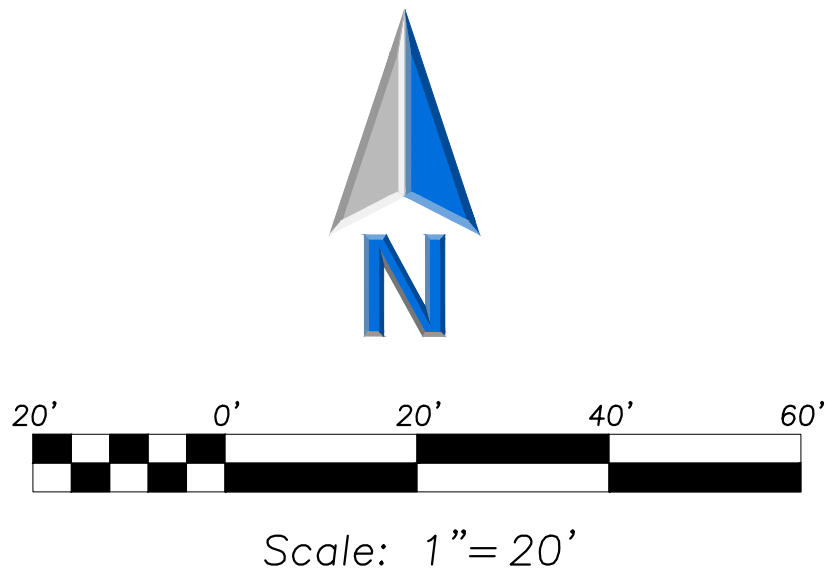
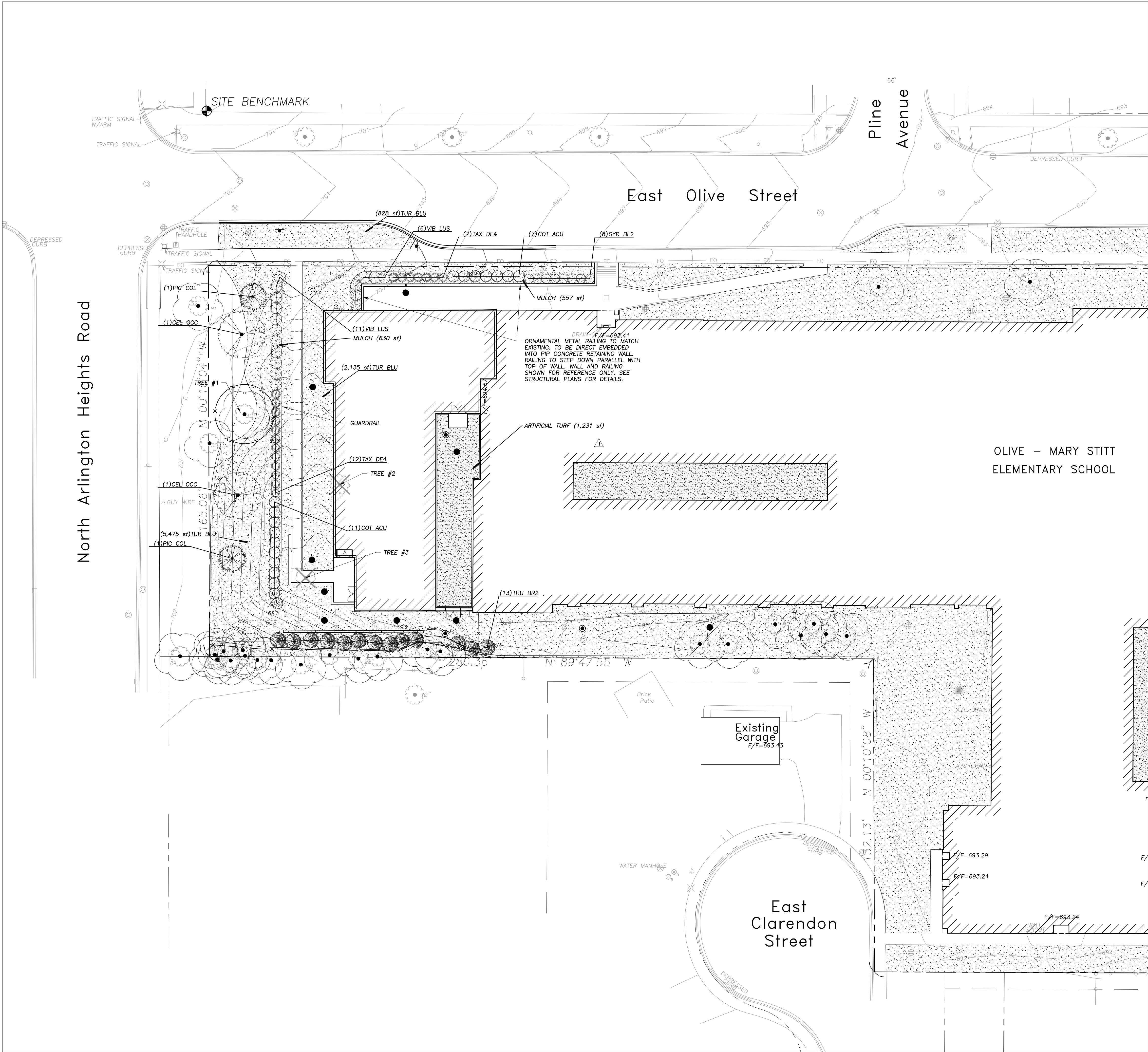

#### PLANT SCHEDULE

CANOPY TREES	BOTANICAL / COMMON NAME	COND	SIZE	QTY
CEL OCC	CELSTIS OCCIDENTALIS / COMMON HACKBERRY	B & B	2.5" CAL.	2
EVERGREEN TREES	BOTANICAL / COMMON NAME	COND	SIZE	QTY
PIC COL	PICEA PUNGENS 'COLORADO GREEN' / COLORADO GREEN SPRUCE	B & B	8' HT.	2
THU BR2	THUJA OCCIDENTALIS 'BRABANT' / BRABANT ARBORVITAE	B & B	5' HT.	13
DECIDUOUS SHRUBS	BOTANICAL / COMMON NAME	COND	SIZE	QTY
COT ACU	COTONEASTER ACUTIFOLIUS / PEKING COTONEASTER	B & B	36" HT.	18
SYR BL2	SYRINGA X 'BLOOMERANG' / BLOOMERANG LILAC	B & B	30" HT.	8
VIB LUS	VIBURNUM DENTATUM 'CHICAGO LUSTER' / CHICAGO LUSTER ARROWWOOD	B & B	36" HT.	17
EVERGREEN SHRUBS	BOTANICAL / COMMON NAME	COND	SIZE	QTY
TAX DE4	TAXUS X MEDIA / DENSE YEW	B & B	24" HT.	19
TURF GRASS	BOTANICAL / COMMON NAME	COND	SIZE	QTY
TUR BLU	TURF SOD BLUEGRASS / KENTUCKY BLUEGRASS	SOD	S.F.	9,864 SF

#### SITE MATERIALS SCHEDULE

MULCH	1,187 SF
ARTIFICIAL TURF	1,231 SF

#### LANDSCAPE NOTES:

- PLANT QUANTITIES SHOWN IN THE PLANT SCHEDULE ARE FOR CONVENIENCE ONLY. THE CONTRACTOR IS RESPONSIBLE FOR PROVIDING AND INSTALLING ALL MATERIALS SHOWN ON THE PLAN AND SHOULD NOT RELY ON THE PLANT SCHEDULE FOR DETERMINING QUANTITIES.
- ALL PLANT MATERIALS SHALL BE NURSERY GROWN STOCK AND SHALL BE FREE FROM ANY DEFORMITIES, DISEASES OR INSECT DAMAGE. ANY MATERIALS WITH DAMAGED OR CROOKED/DISTORTED LEADERS, BARK ABRASION, SUNSCALD, INSECT DAMAGE, ETC. ARE NOT ACCEPTABLE AND WILL BE REJECTED. TREES WITH MULTIPLE LEADERS WILL BE REJECTED UNLESS CALLED OUT IN THE PLANT SCHEDULE AS MULTI-STEM. NO PRUNING TO BE DONE AT THE TIME OF INSTALLATION EXCEPT FOR DEAD OR BROKEN LIMBS.
- ALL LANDSCAPE IMPROVEMENTS SHALL MEET MUNICIPALITY REQUIREMENTS AND GUIDELINES, WHICH SHALL BE VERIFIED BY MUNICIPAL AUTHORITIES.
- ALL PLANTING OPERATIONS SHALL BE COMPLETED IN ACCORDANCE WITH STANDARD HORTICULTURAL PRACTICES. THIS MAY INCLUDE, BUT NOT BE LIMITED TO, PROPER PLANTING BED AND TREE PIT PREPARATION, PLANTING MIX, PRUNING, STAKING AND GUYING, WRAPPING, SPRAYING, FERTILIZATION, PLANTING AND ADEQUATE MAINTENANCE OF MATERIALS DURING CONSTRUCTION ACTIVITIES.
- ALL PLANT MATERIALS SHALL BE INSPECTED AND APPROVED BY THE LANDSCAPE ARCHITECT PRIOR TO INSTALLATION. ANY MATERIALS INSTALLED WITHOUT APPROVAL MAY BE REJECTED.
- THE CONTRACTOR SHALL GUARANTEE PLANT MATERIALS FOR A PERIOD OF ONE YEAR FROM DATE OF ACCEPTANCE BY OWNER. THE CONTRACTOR SHALL OUTLINE PROPER MAINTENANCE PROCEDURES TO THE OWNER AT THE TIME OF ACCEPTANCE. DURING THE GUARANTEE PERIOD, DEAD OR DISEASED MATERIALS SHALL BE REPLACED AT NO COST TO THE OWNER. AT THE END OF THE GUARANTEE PERIOD THE CONTRACTOR SHALL OBTAIN FINAL ACCEPTANCE FROM THE OWNER.
- ANY EXISTING TREES TO BE RETAINED SHALL BE PROTECTED FROM SOIL COMPACTION AND OTHER DAMAGES THAT MAY OCCUR DURING CONSTRUCTION ACTIVITIES BY ERECTING FENCING AROUND SUCH MATERIALS AT A DISTANCE OF 8.5' FROM THE TRUNK.
- ALL GRASS, CLUMPS, OTHER VEGETATION, DEBRIS, STONES, ETC., SHALL BE RAKED OR OTHERWISE REMOVED FROM PLANTING AND LAWN AREAS PRIOR TO INITIATION OF INSTALLATION PROCEDURES.
- THE CONTRACTOR SHALL VERIFY THE LOCATIONS OF ALL UNDERGROUND UTILITIES PRIOR TO INITIATING PLANTING OPERATIONS. THE CONTRACTOR SHALL REPAIR/ REPLACE AND UTILITY, PAVING, CURBING, ETC., WHICH IS DAMAGED DURING PLANTING OPERATIONS.
- SIZE AND GRADING STANDARDS OF PLANT MATERIALS SHALL CONFORM TO THE LATEST EDITION OF ANSI Z60.1, AMERICAN STANDARDS FOR NURSERY STOCK, BY THE AMERICAN NURSERY & LANDSCAPE ASSOCIATION.
- REFER TO PLAT OF SURVEY FOR LEGAL DESCRIPTION, BOUNDARY DIMENSIONS AND EXISTING CONDITIONS.
- ALL PLANT MATERIAL ON THIS PLANTING PLAN REPRESENTS THE INTENTION AND INTENSITY OF THE PROPOSED LANDSCAPE MATERIAL. THE EXACT SPECIES AND LOCATIONS MAY VARY IN THE FIELD DO TO MODIFICATIONS IN THE SITE IMPROVEMENTS AND THE AVAILABILITY OF PLANT MATERIAL AT THE TIME OF INSTALLATION. ANY SUCH CHANGES MUST FIRST BE APPROVED BY THE CITY IN WRITING.
- ALL PLANT MATERIAL SHALL BE PLANTED WITH A MINIMUM OF SIX INCHES OF ORGANIC SOIL AND MULCHED WITH A SHREDDED BARK MATERIAL TO A MINIMUM 3" DEPTH.
- ALL BEDS SHALL BE EDGED, HAVE WEED PREEMERGENTS APPLIED AT THE RECOMMENDED RATE.
- ALL PARKWAYS SHALL HAVE LAWN ESTABLISHED WITH SEED A GROUND COVER, UNLESS OTHERWISE NOTED.
- ALL LAWN AREAS ON THIS PLAN SHALL BE GRADED SMOOTH AND TOPPED WITH AT LEAST 6" OF TOPSOIL. ALL LAWN AREAS TO BE ESTABLISHED USING SEED BLANKET UNLESS OTHERWISE NOTED. BLANKET TO BE S75 OR APPROVED EQUAL.
- THIS LANDSCAPE PLAN ASSUMES THE SITE WILL BE PREPARED WITH TOP SOIL SUITABLE FOR THE ESTABLISHMENT OF THE LANDSCAPE MATERIAL PRESENTED ON THIS PLAN. IF ADDITIONAL TOP SOIL IS REQUIRED IT IS UP TO THE LANDSCAPE CONTRACTOR ON THE PROJECT TO PROVIDE, SPREAD AND PREPARE THE SITE AS NEEDED FOR THE IMPLEMENTATION OF THIS LANDSCAPE PLAN.
- CONTRACTORS MUST VERIFY ALL QUANTITIES AND OBTAIN ALL PROPER PERMITS AND LICENSES FROM THE PROPER AUTHORITIES.
- ALL MATERIAL MUST MEET INDUSTRY STANDARDS AND THE LANDSCAPE ARCHITECT HAS THE RIGHT TO REFUSE ANY POOR MATERIAL OR WORKMANSHIP.
- LANDSCAPE ARCHITECT IS NOT RESPONSIBLE FOR UNSEEN SITE CONDITIONS.
- ALL PLANTINGS SHALL BE SPACED EQUAL DISTANT, BACK FILLED WITH AMENDED SOIL IN A HOLE TWICE THE ROOTBALL DIAMETER, WATERED, FERTILIZED, PRUNED, AND HAVE ALL TAGS AND ROPES REMOVED.
- LAWN AND BED AREAS SHALL BE ROTOTILLED, RAKED OF CLUMPS AND DEBRIS.
- REMOVE ALL DEAD AND DISEASED PLANT MATERIAL FROM SITE AND DISPOSE OF PROPERLY.
- PLANTS TO BE PLANTED SO THAT ROOT FLARE IS AT THE GRADE OF THE AREA WHERE PLANTED. NO PRUNING TO BE DONE AT THE TIME OF INSTALLATION EXCEPT TO REMOVE DEAD OR BROKEN LIMBS.

Tree #	BOTANICAL NAME	COMMON NAME	TREE SIZE	CONDITION	COMMENTS
1	Gleditsia triacanthos inermis	Thornless Honeylocust	36" Cal.	Good	
2	Gleditsia triacanthos inermis	Thornless Honeylocust	12" Cal.	Good	
3	Gleditsia triacanthos inermis	Thornless Honeylocust	12" Cal.	Good	Multi-trunk form

#### SURVEY PROVIDED BY:

Plat of Survey and Topography Provided By R.E. Allen and Associates, Ltd. For Eriksson Engineering Associates on July 2, 2015. Order Number F5215.

#### PROJECT BENCHMARKS

Site Benchmark:  
Village Of Arlington Heights Monument 39  
At The Northeast Corner Of W. Olive Street And Arlington Heights Road.  
Elevation= 703.13 NAVD88

Easting: 1080453.94  
Northing: 1978796.95

J.U.L.I.E.

Note: The exact location of all utilities shall be verified by the contractor prior to construction activities. For utility locations call: J.U.L.I.E. 1 (800) 892-0123



145 COMMERCE DRIVE, SUITE A  
GRAYSLAKE, ILLINOIS 60030  
PHONE: (847) 223-4804  
FAX: (847) 223-4864  
EMAIL: INFO@EEA-LTD.COM  
PROFESSIONAL DESIGN FIRM  
LICENSE NO. 184-0033240  
EXPIRES: 04/30/2023

## OLIVE-MARY STITT ELEMENTARY SCHOOL BUILDING ADDITION & INTERIOR RENOVATIONS

303 E OLIVE STREET  
ARLINGTON HEIGHTS, ILLINOIS

Reserved for Seal:

No.	Date	Description
1	11/17/2022	ISSUE FOR PLAN COMMISSION
2	01/20/2023	REVISED FOR PLAN COMMISSION
3	02/01/2023	REVISED FOR PLAN COMMISSION

Design By: SSG  
Approved By: JC  
Date: 11/11/2022

Sheet Title:

LANDSCAPE  
PLAN

Sheet No:

L100



EEA - P:\Josh\Arlington Heights School Dist 25\2022 Kindergarten Additions\Drawings\Olive\Landscape Plan - Olive-Mary Stitt.dwg  
Plotted: 2/01/23 @ 2:26pm By: janderson

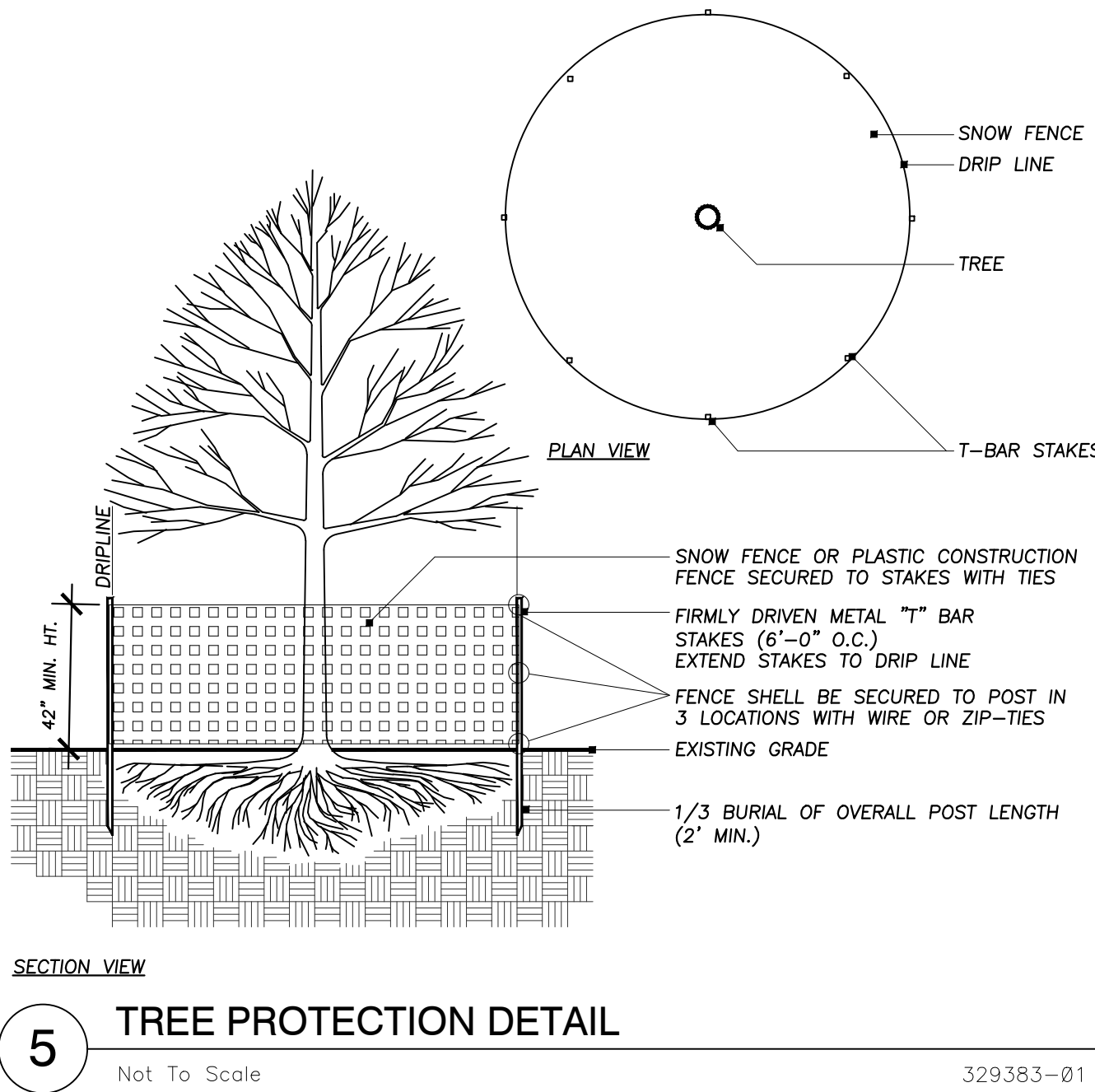
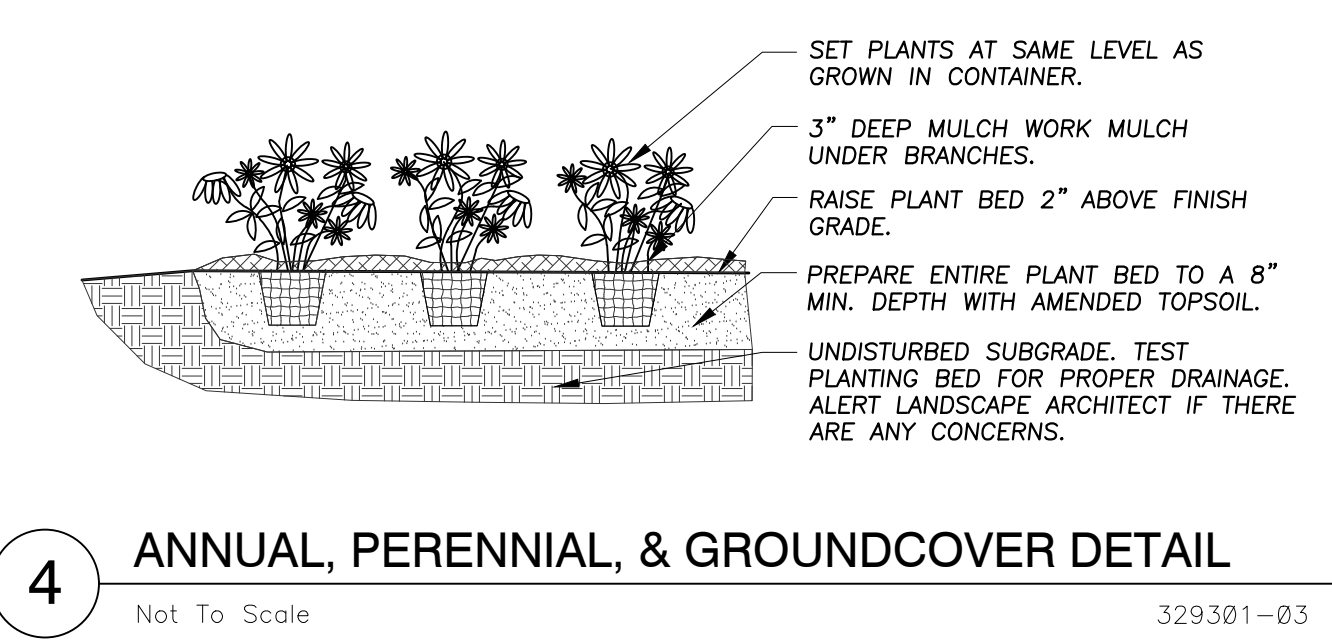
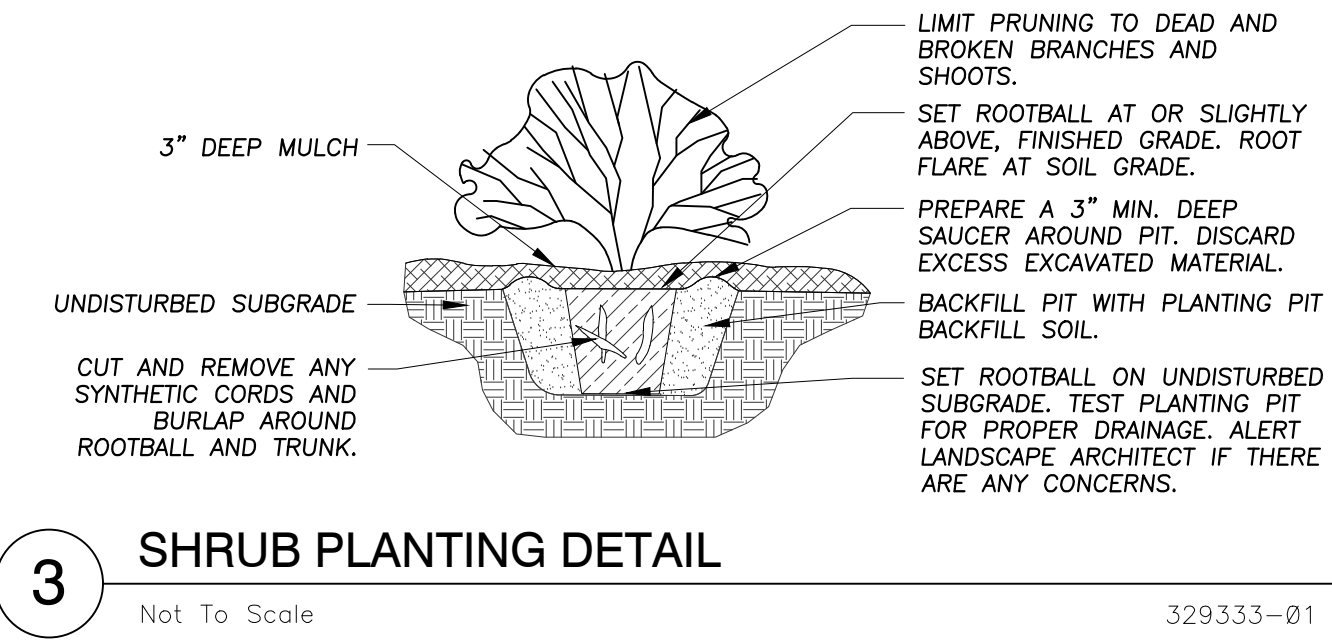
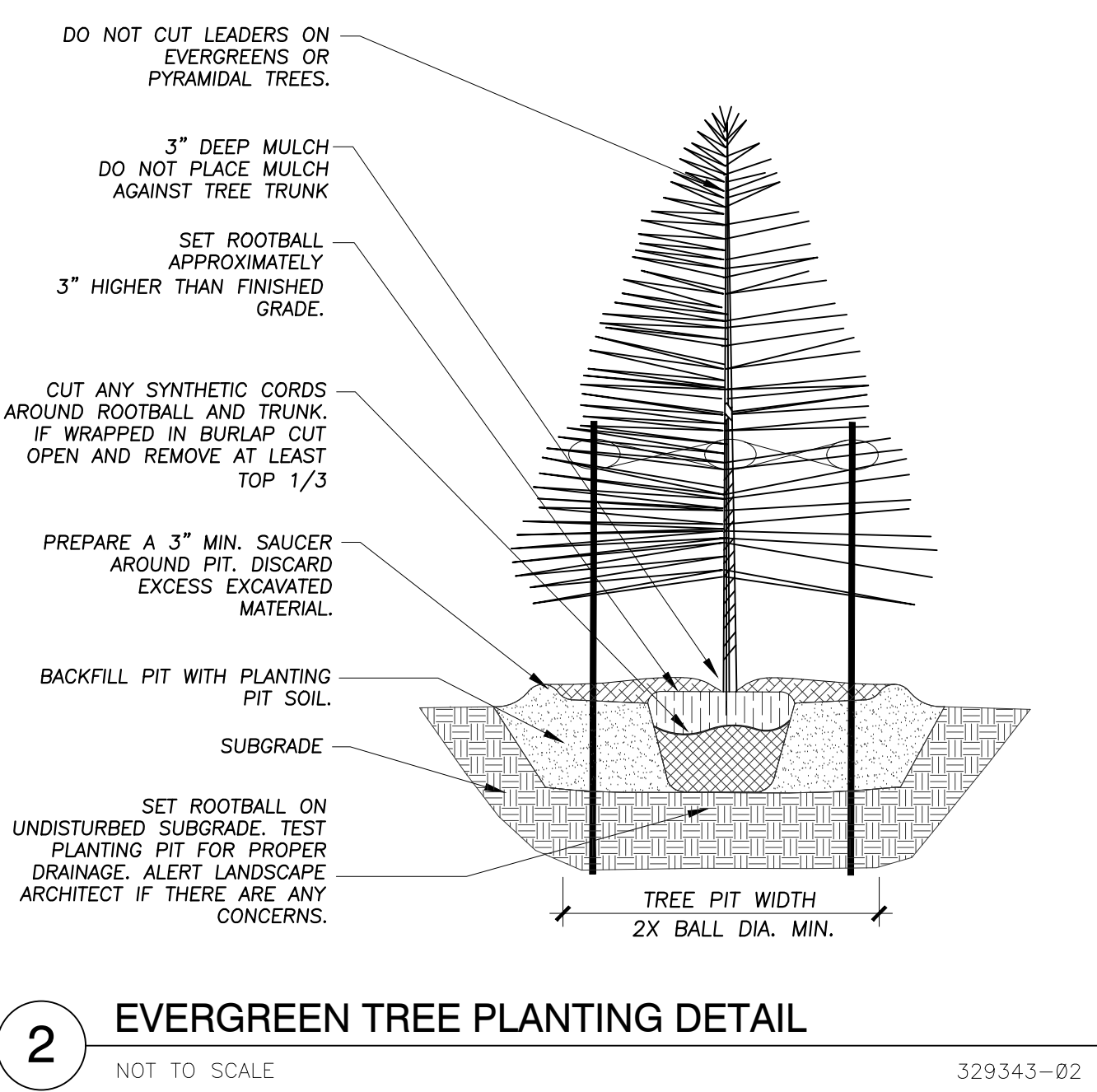
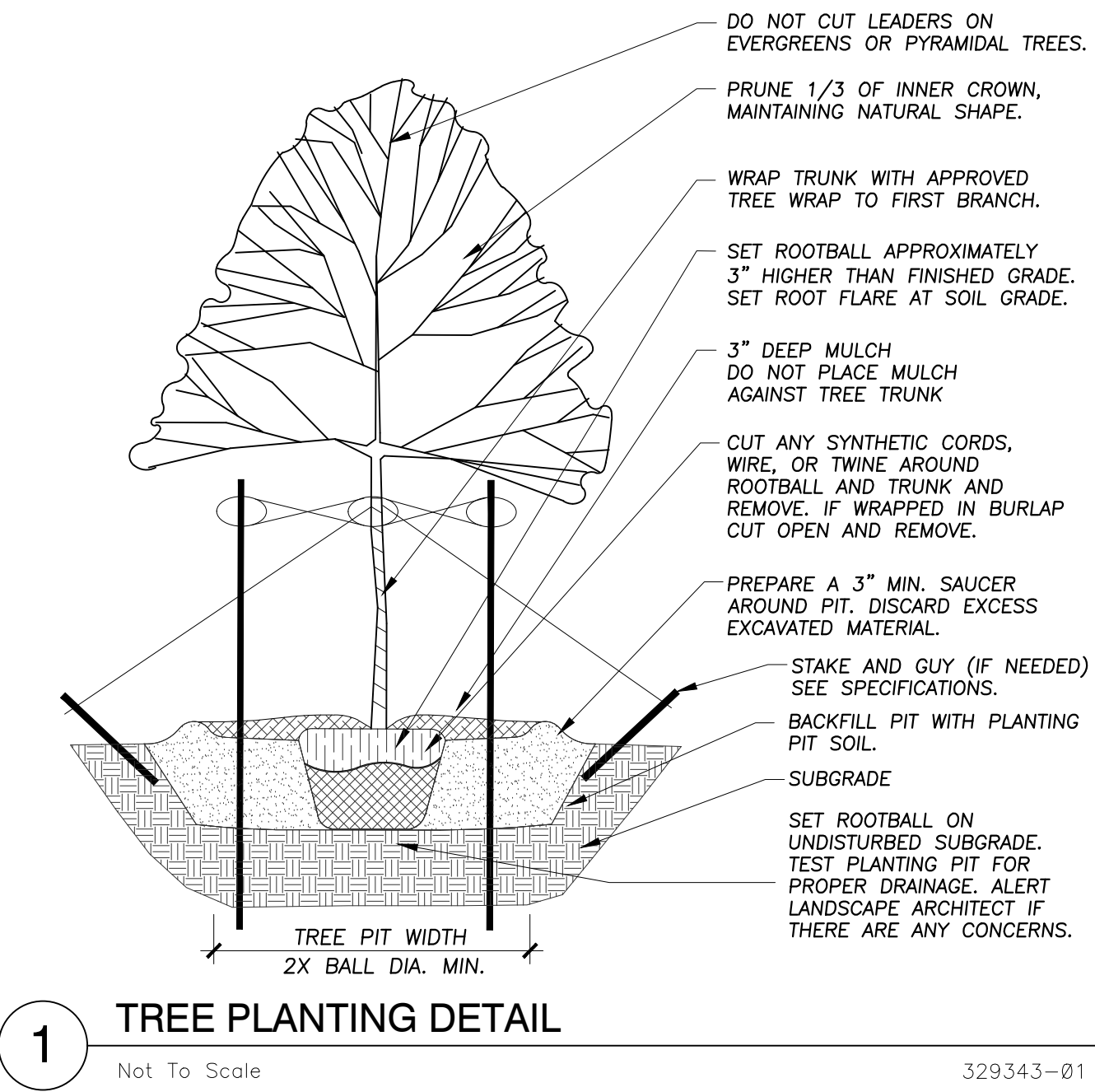



**ERIKSSON  
ENGINEERING  
ASSOCIATES, LTD.**

145 COMMERCE DRIVE, SUITE A  
GRAYSLAKE, ILLINOIS 60030  
PHONE: (847) 223-4804  
FAX: (847) 223-4864  
EMAIL: INFO@EEA-LTD.COM  
PROFESSIONAL DESIGN FIRM  
LICENSE NO. 184-0033240  
EXPIRES: 04/30/2023

**OLIVE-MARY STITT ELEMENTARY SCHOOL  
BUILDING ADDITION & INTERIOR RENOVATIONS**

303 E OLIVE STREET  
ARLINGTON HEIGHTS, ILLINOIS

Reserved for Seal:

No.	Date	Description
	11/17/2022	ISSUE FOR PLAN COMMISSION
	01/20/2023	REVISED FOR PLAN COMMISSION
	02/01/2023	REVISED FOR PLAN COMMISSION

© ERIKSSON ENGINEERING ASSOCIATES, LTD. 2022  
THIS PLAN & DESIGN ARE THE PROPERTY OF ERIKSSON ENGINEERING ASSOCIATES, LTD.  
NO REPRODUCTION OR USE OF ANY PART OF THIS PLAN IS PERMITTED WITHOUT THE WRITTEN  
CONSENT OF ERIKSSON ENGINEERING ASSOCIATES, LTD.

Design By:	Approved By:	Date:
SSG	JC	11/11/2022

Sheet Title:

**LANDSCAPE  
DETAILS**

Sheet No:

**L200**