

ARLINGTON HEIGHTS POLICE STATION STUDY

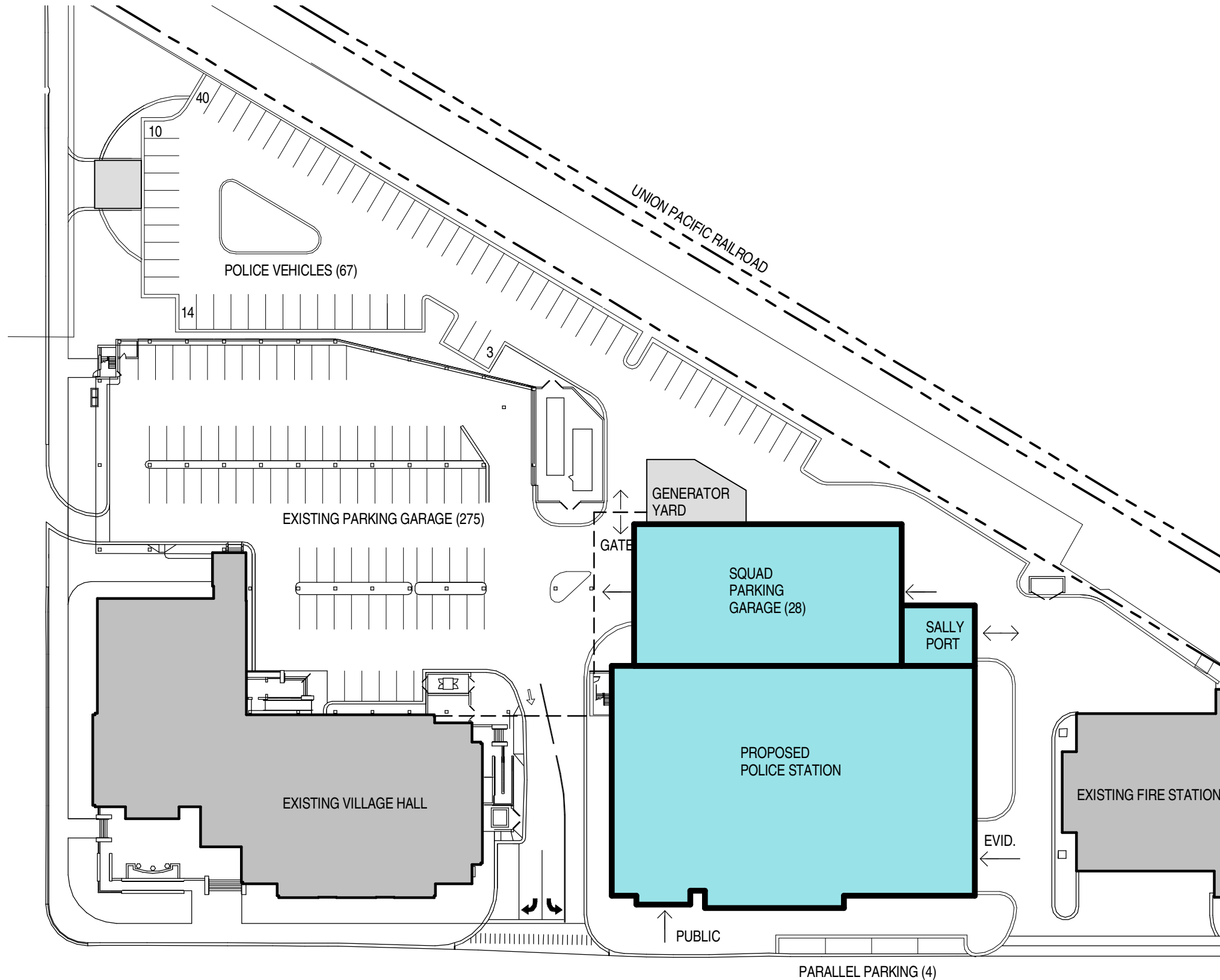

BUILDING AREA

- LOWER LEVEL: 23,000 SF
- MAIN LEVEL (INCLUDES SALLYPORT): 24,500 SF
- SECOND LEVEL: 23,000 SF

TOTAL : 70,500 SF

PARKING GARAGE AREA

- INDOOR SQUAD PARKING GARAGE: 10,360 SF

PARKING BREAKDOWN

POLICE VEHICLES (81 REQUIRED)

- INDOOR PARKING GARAGE: 28
- ON GRADE (INCLUDES 31 AT NW CORNER): 67
 - OPTION A (PARKING DECK ABOVE) 28
 - OPTION B (FUTURE PARKING DECK ABOVE) 0
 - OPTION C,D,E, (NO PARKING DECK) 0

SUB-TOTAL POLICE VEHICLES

- SUB-TOTAL OPTION A 123
- SUB-TOTAL OPTION B 95
- SUB-TOTAL OPTION C, D, E, 95

STAFF AND PUBLIC

- EXISTING PARKING DECK 275
- EXISTING LOTS ON SIGWALT 94
- PARALLEL PARKING AT FRONT 4

SUB-TOTAL STAFF AND PUBLIC 373

TOTAL SITE PARKING:

TOTAL 468 - 496

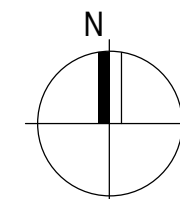

SCALE : 1" = 60'-0"

05/13/15

14-1933.01

ARLINGTON HEIGHTS POLICE STATION STUDY

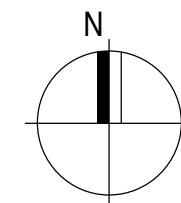

SCALE : 1/32" = 1'-0"

05/13/15

14-1933.01

ARLINGTON HEIGHTS POLICE STATION STUDY

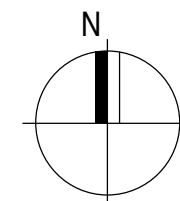
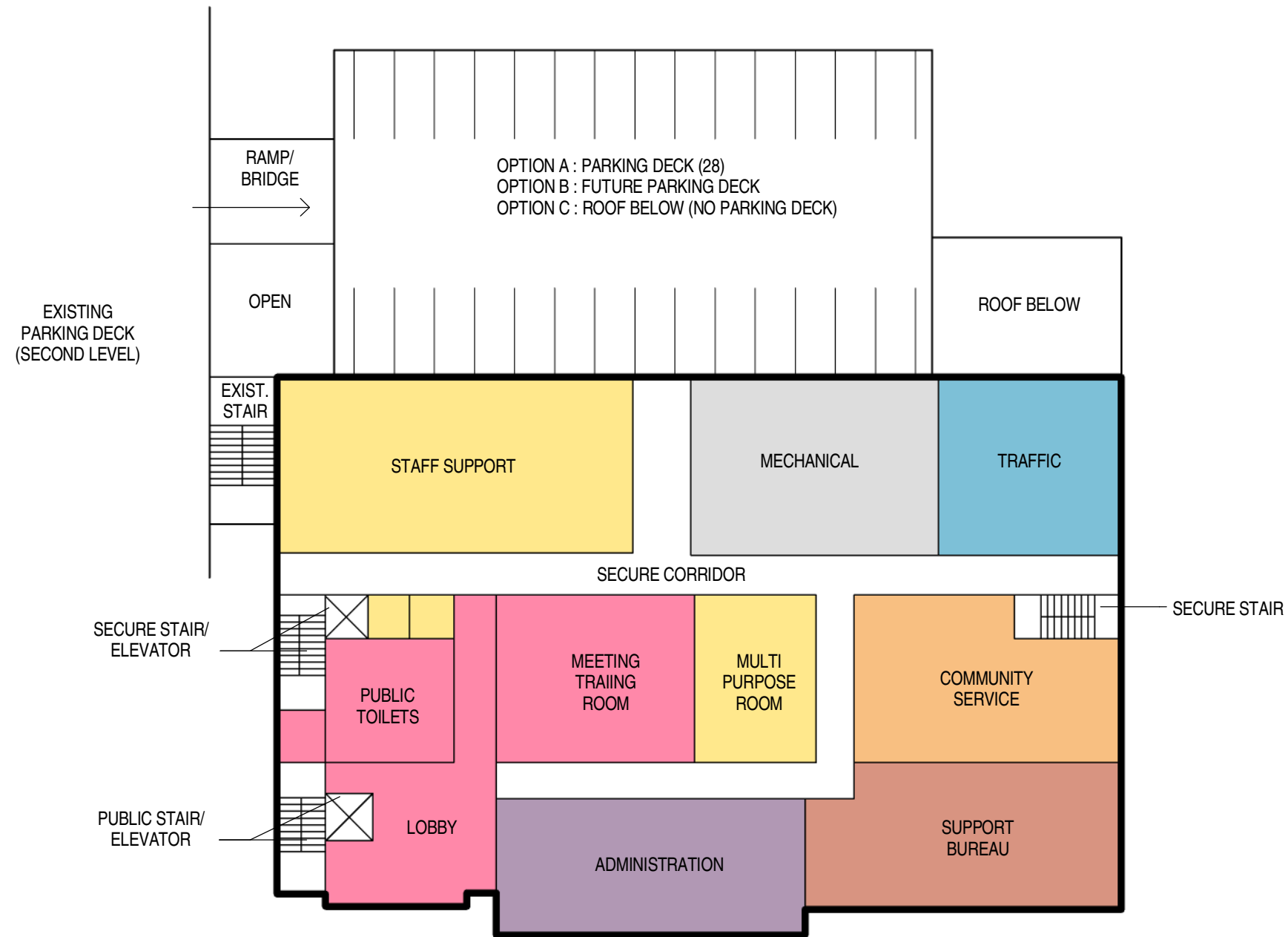

SCALE : 1/32" = 1'-0"

05/13/15

14-1933.01

ARLINGTON HEIGHTS POLICE STATION STUDY

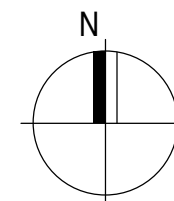
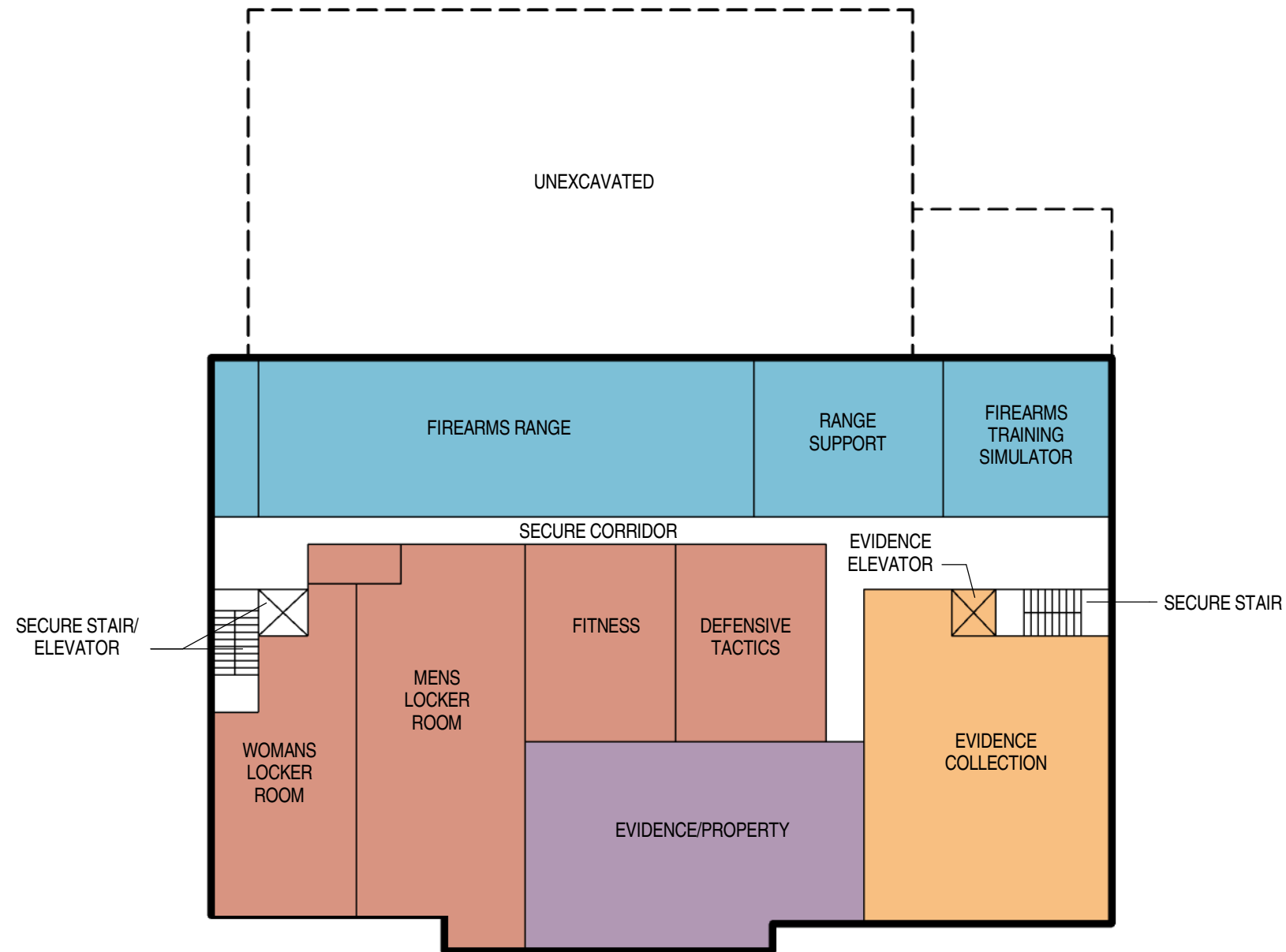

SCALE : 1/32" = 1'-0"

05/13/15

14-1933.01

ARLINGTON HEIGHTS POLICE STATION STUDY

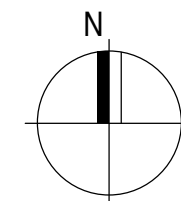
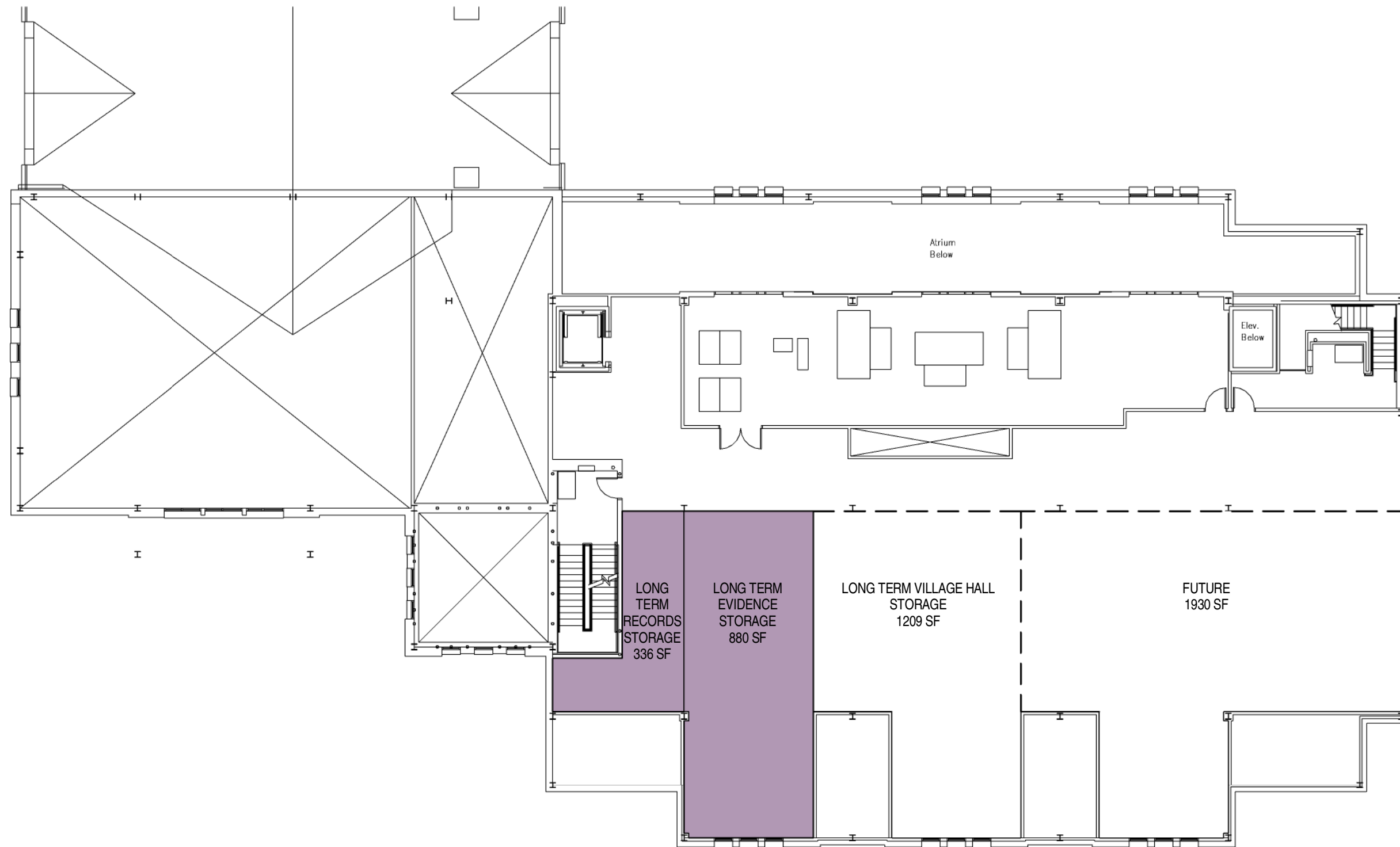

SCALE : 1/16" = 1'-0"

05/13/15

14-1933.01

ARLINGTON HEIGHTS POLICE STATION STUDY

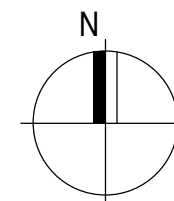

SCALE : 1/32" = 1'-0"

05/13/15

14-1933.01

ARLINGTON HEIGHTS POLICE STATION STUDY

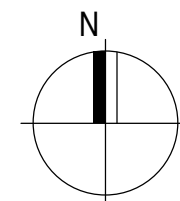

SCALE : 1/32" = 1'-0"

05/13/15

14-1933.01

ARLINGTON HEIGHTS POLICE STATION STUDY

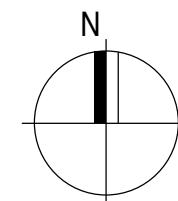
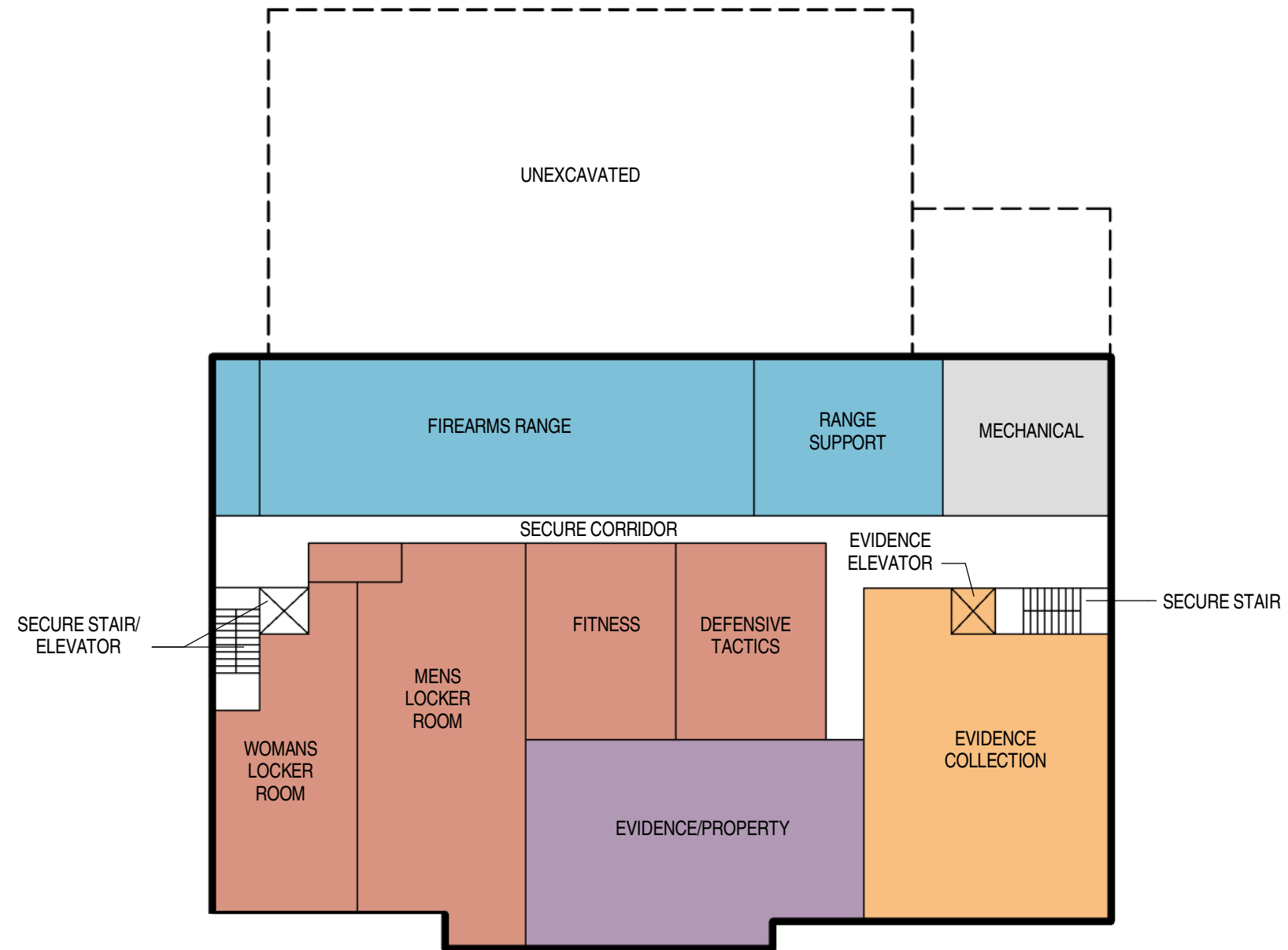

SCALE : 1/32" = 1'-0"

05/13/15

14-1933.01

ARLINGTON HEIGHTS POLICE STATION STUDY

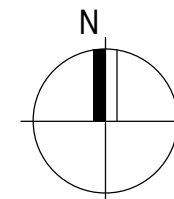
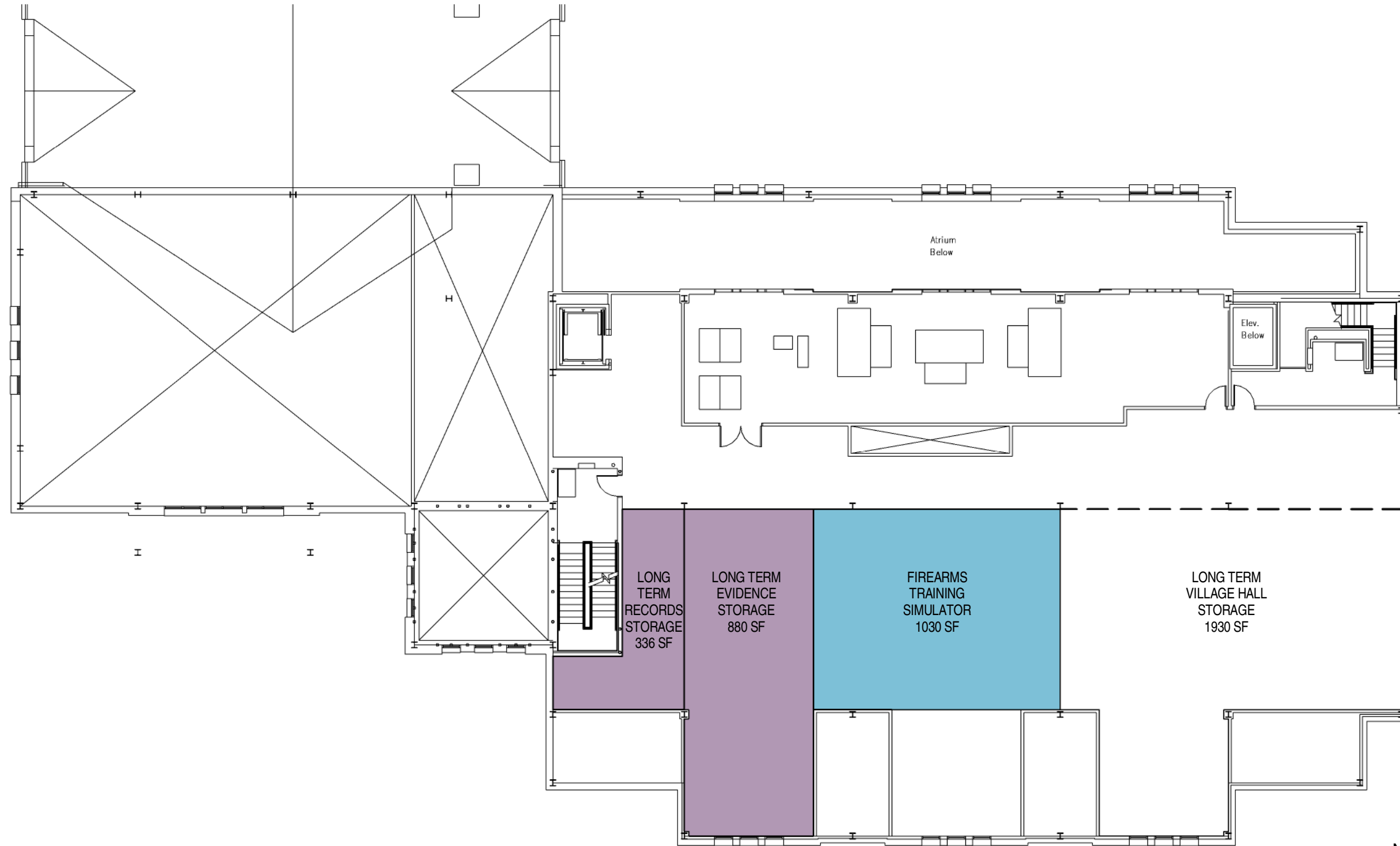

SCALE : 1/16" = 1'-0"

05/13/15

14-1933.01

ARLINGTON HEIGHTS POLICE STATION STUDY

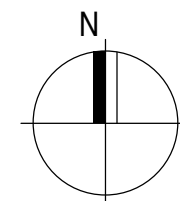

SCALE : 1/32" = 1'-0"

05/13/15

14-1933.01

ARLINGTON HEIGHTS POLICE STATION STUDY

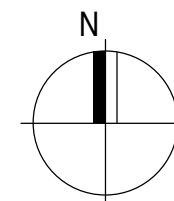

SCALE : 1/32" = 1'-0"

05/13/15

14-1933.01

ARLINGTON HEIGHTS POLICE STATION STUDY

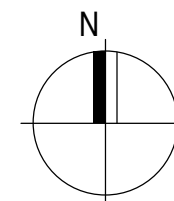
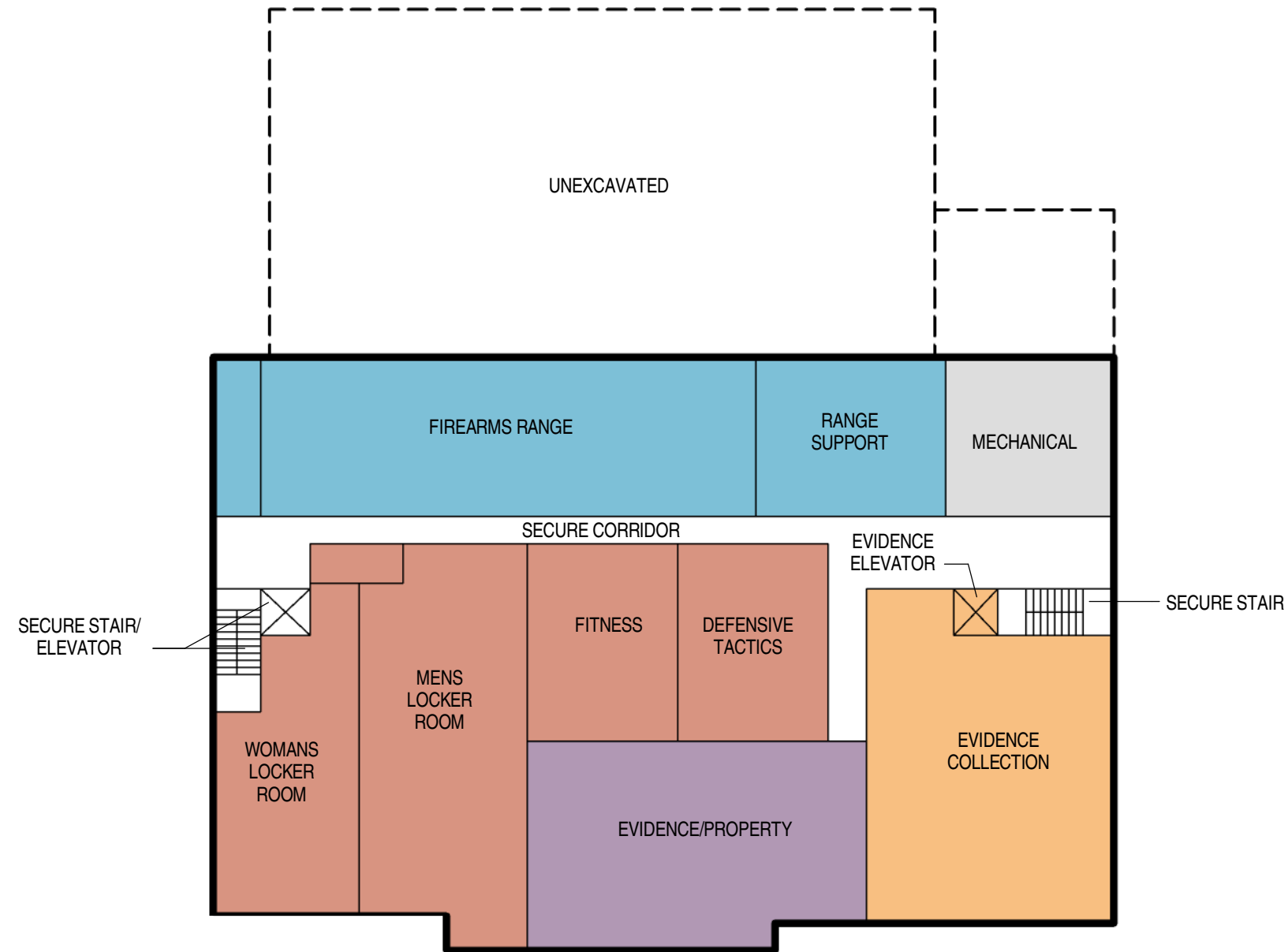

SCALE : 1/32" = 1'-0"

05/13/15

14-1933.01

ARLINGTON HEIGHTS POLICE STATION STUDY

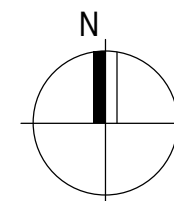
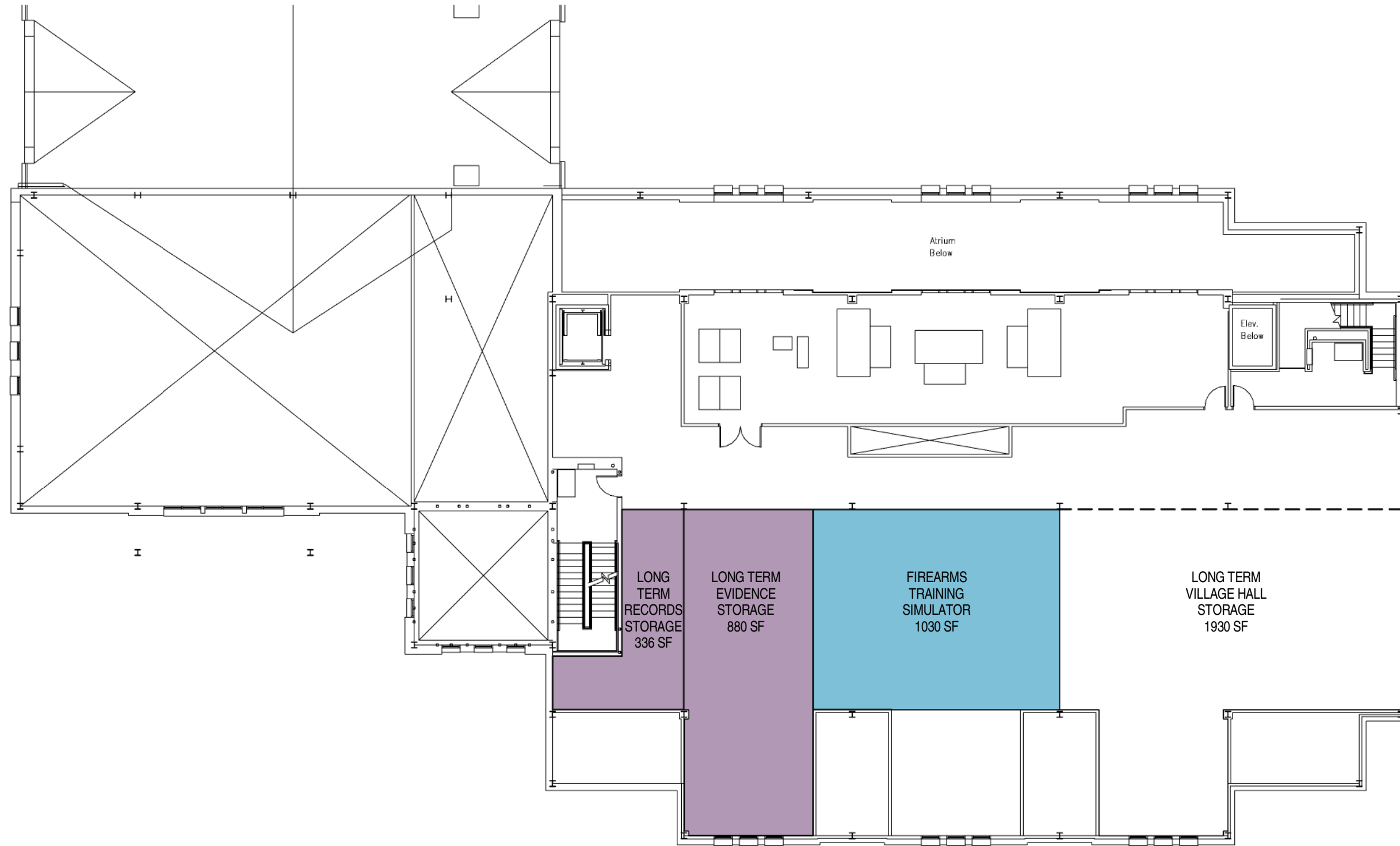

SCALE : 1/16" = 1'-0"

05/13/15

14-1933.01

ARLINGTON HEIGHTS POLICE STATION STUDY

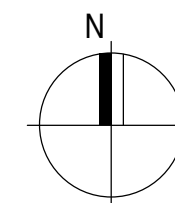
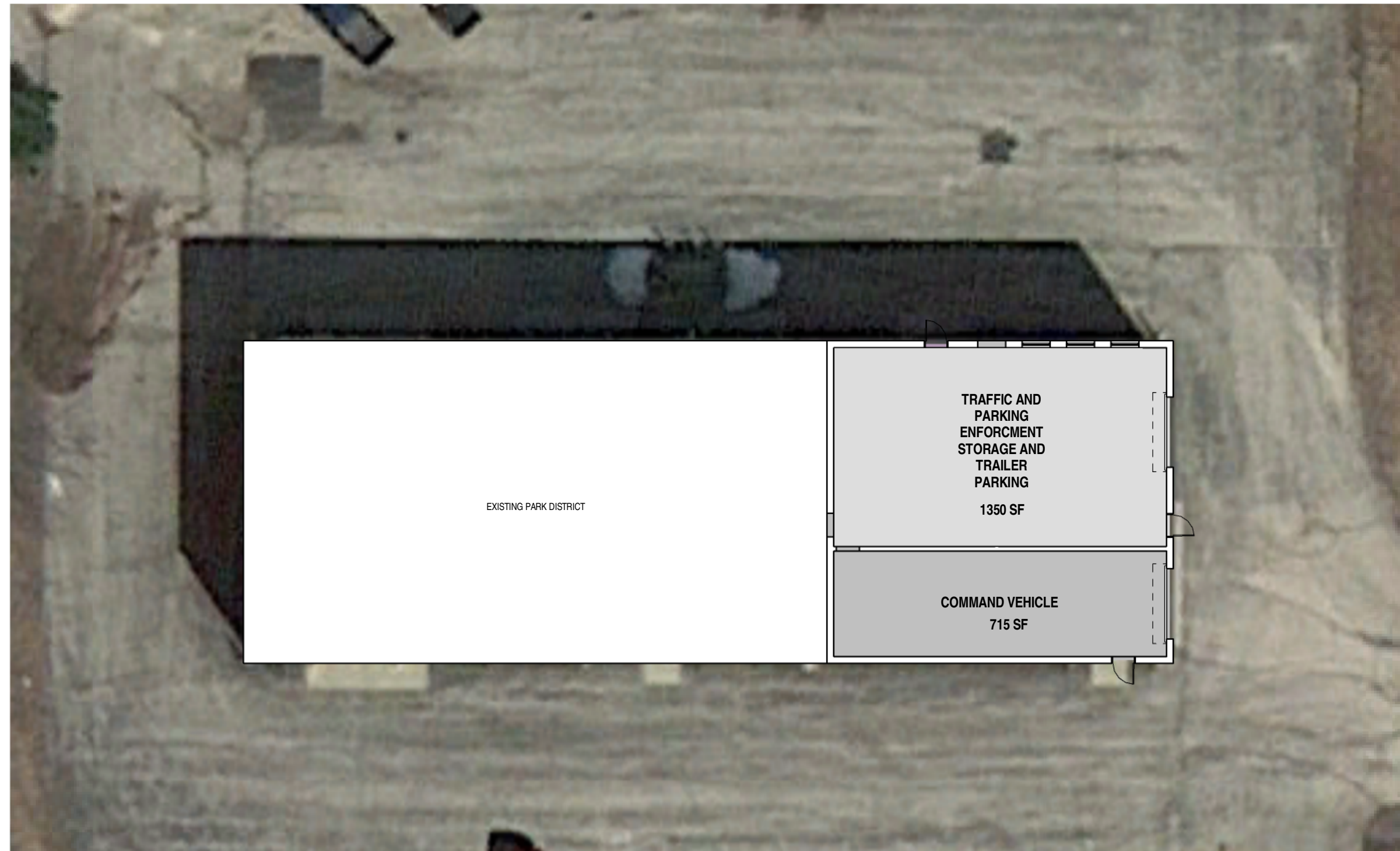

SCALE : 1/16" = 1'-0"

05/13/15

14-1933.01

ARLINGTON HEIGHTS POLICE STATION STUDY



05/13/15

14-1933.01