

1501 SHURE DRIVE
RENOVATED 1 STORY MIXED-USE INDUSTRIAL BUILDING
RENTABLE SF: +/- 318,227 SF
+/- 215,927 SF OFFICE
+/- 64,200 SF STORAGE AND WAREHOUSE
+/- 38,100 SF SERVICE AND SUPPORT AREA
TOTAL PARKING PROVIDED:
+/- 792 SPACES
3.67 SPACES/1,000SF OF OFFICE

1421 SHURE DRIVE
RENOVATED 3 STORY OFFICE
BUILDING WITH 16 INTERIOR
PARKING SPACES
RENTABLE SF:
+/- 209,271 SF
TOTAL PARKING PROVIDED:
+/- 1,715 SPACES
8.12 SPACES/1,000SF

±1,699 PARKING SPACES

±792 PARKING SPACES

EXISTING
LOADING DOCKS

DETENTION
AREA

DETENTION
AREA

1501 PUD	8.21.2015
NO. ISSUED FOR:	DATE:

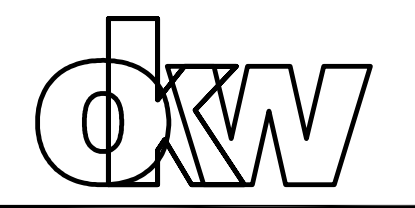

OKW
Architects
600 W. Jackson Blvd.
Chicago, Illinois 60661
T 312.798.7700
F 312.798.7777
www.okwarchitects.com

NORTHWEST CROSSINGS
1421 AND 1501 SHURE DRIVE
ARLINGTON HEIGHTS, ILLINOIS

ARCHITECTURAL
EXISTING
SITE PLAN

DRAWN BY: TJB CHECKED: TJB

DATE:
8.21.2015 SHEET NO:

PROJ. NO:
13043 A001

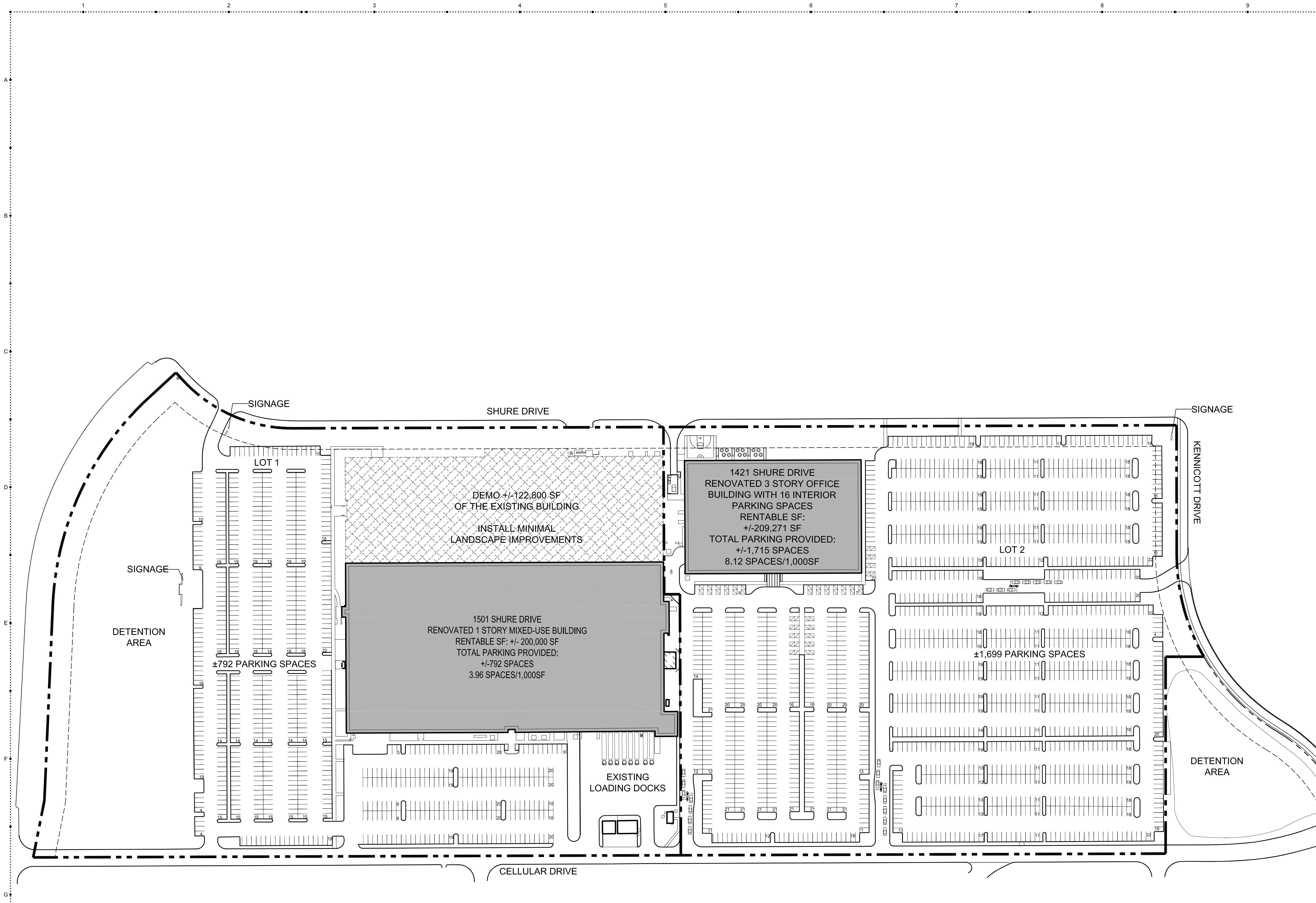

SIGNAGE

SHURE DRIVE

SIGNAGE

SIGNAGE

DETENTION AREA

LOT 1

±792 PARKING SPACES

DEMO +/-122,800 SF OF THE EXISTING BUILDING
INSTALL MINIMAL LANDSCAPE IMPROVEMENTS

1501 SHURE DRIVE
RENOVATED 1 STORY MIXED-USE BUILDING
RENTABLE SF: +/- 200,000 SF
TOTAL PARKING PROVIDED:
+/-792 SPACES
3.96 SPACES/1,000SF

1421 SHURE DRIVE
RENOVATED 3 STORY OFFICE BUILDING WITH 16 INTERIOR PARKING SPACES
RENTABLE SF: +/-209,271 SF
TOTAL PARKING PROVIDED:
+/-1,715 SPACES
8.12 SPACES/1,000SF

LOT 2

±1,699 PARKING SPACES

EXISTING LOADING DOCKS

KENNICOTT DRIVE

DETENTION AREA

CELLULAR DRIVE

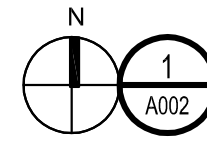

NORTHWEST CROSSINGS PROPOSED SITE PLAN

SCALE: 1" = 80'-0"

SEE CIVIL DRAWINGS FOR MORE DETAILED INFORMATION

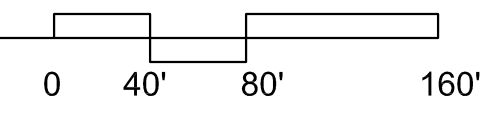

1501 PUD	8.21.2015
NO. ISSUED FOR:	DATE:

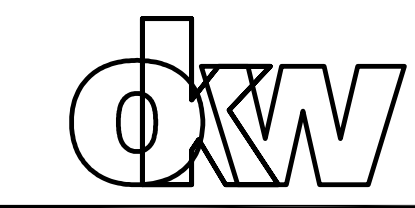

OKW Architects
600 W. Jackson Blvd.
Chicago, Illinois 60661
T 312.798.7700
F 312.798.7777
www.okwarchitects.com

NORTHWEST CROSSINGS
1421 AND 1501 SHURE DRIVE
ARLINGTON HEIGHTS, ILLINOIS

ARCHITECTURAL PROPOSED SITE PLAN

DRAWN BY: TJB CHECKED: TJB

DATE: 8.21.2015 SHEET NO:

PROJ. NO: 13043 A002

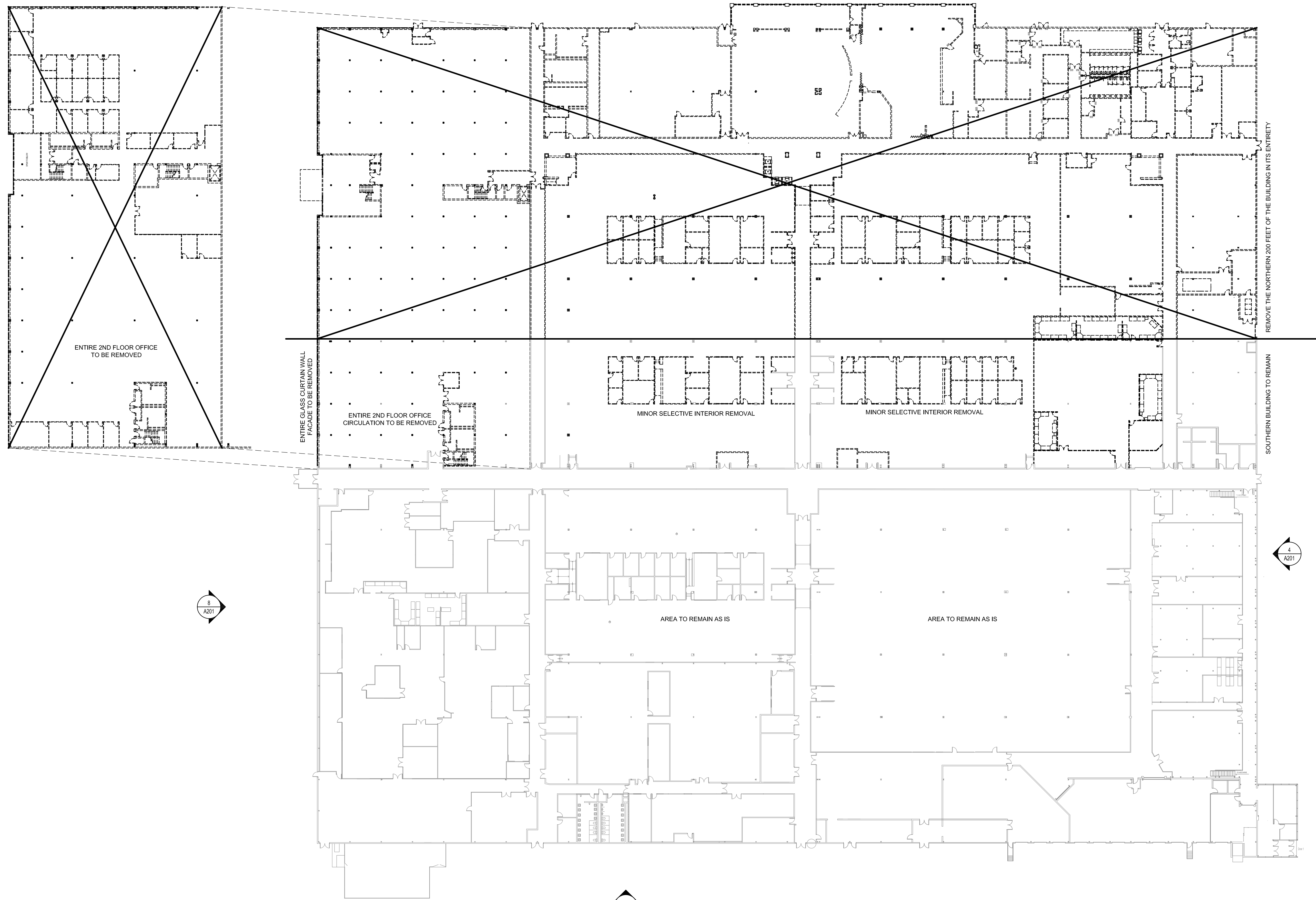

1 1501 REMOVAL PLAN
SCALE: 1" = 30'-0"
0 15' 30' 60'

△		
△		
△		
△		
△		
△	1501 PUD	8.21.2015
△	NO. ISSUED FOR:	DATE:

OKW
Architects
600 W. Jackson Blvd.
Chicago, Illinois 60661
T 312.798.7700
F 312.798.7777
www.okwarchitects.com

NORTHWEST CROSSINGS
1421 AND 1501 SHURE DRIVE
ARLINGTON HEIGHTS, ILLINOIS
1501 REMOVAL PLAN

DRAWN BY:	TJB	CHECKED:	TJB
DATE:	8.21.2015	SHEET NO.:	A100
PROJ. NO.:	13043		

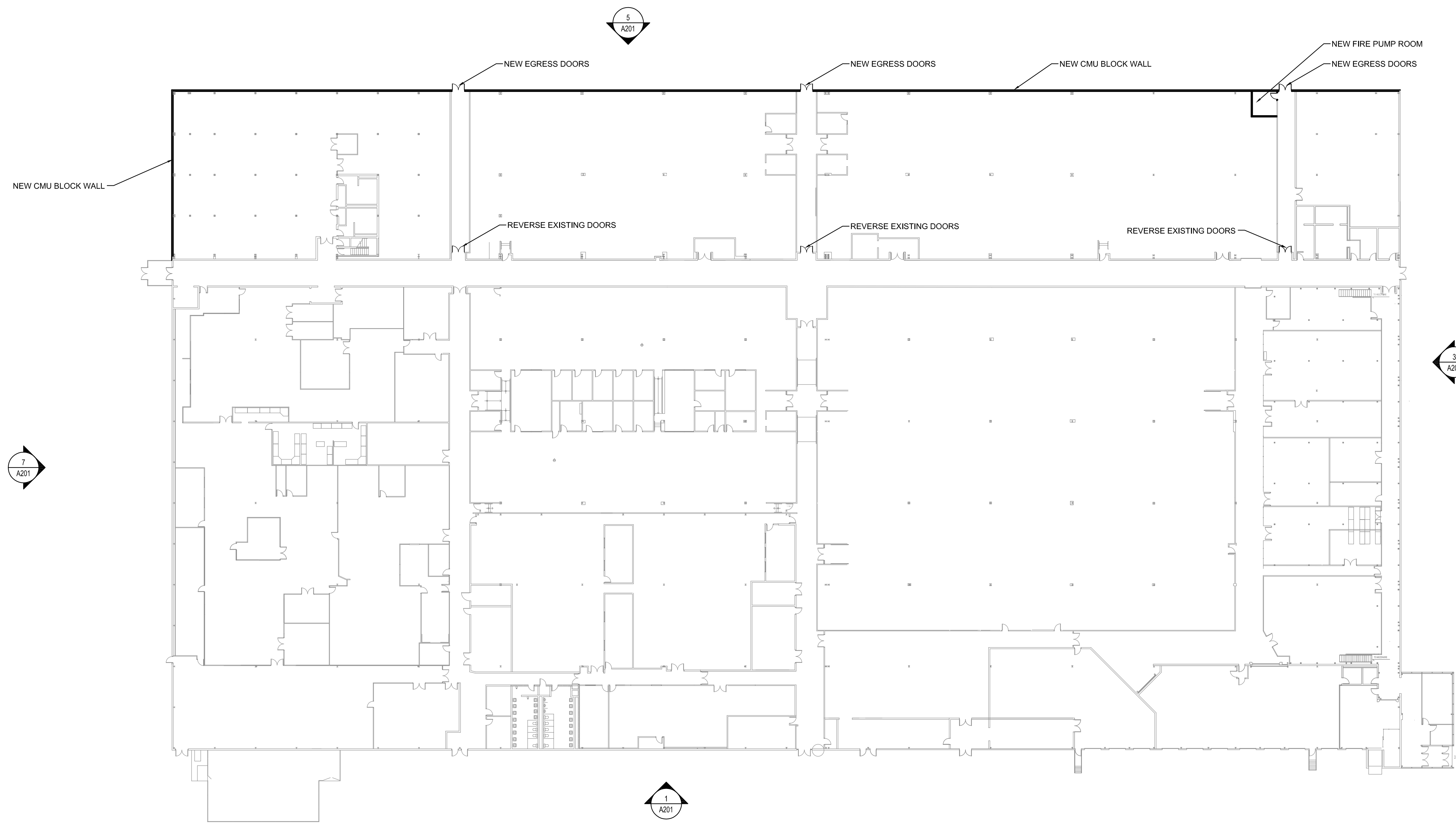

△		
△		
△		
△		
△		
△	1501 PUD	8.21.2015
△	NO. ISSUED FOR:	DATE:

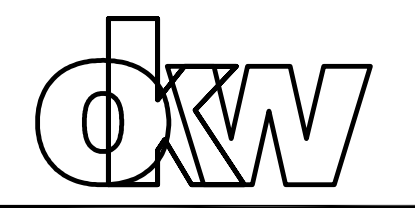

OKW
Architects
600 W. Jackson Blvd.
Chicago, Illinois 60661
T 312.798.7700
F 312.798.7777
www.okwarchitects.com

NORTHWEST CROSSINGS
1421 AND 1501 SHURE DRIVE
ARLINGTON HEIGHTS, ILLINOIS

**1501 INTERIM
FLOOR PLAN**

DRAWN BY: TJB CHECKED: TJB

DATE:
8.21.2015 SHEET NO:

PROJ. NO:
13043 **A101**

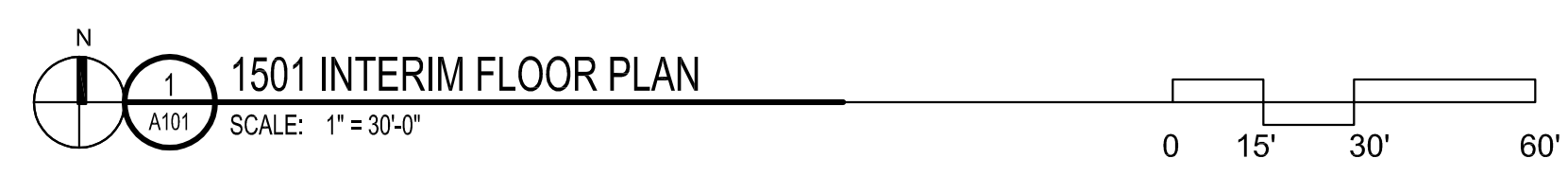

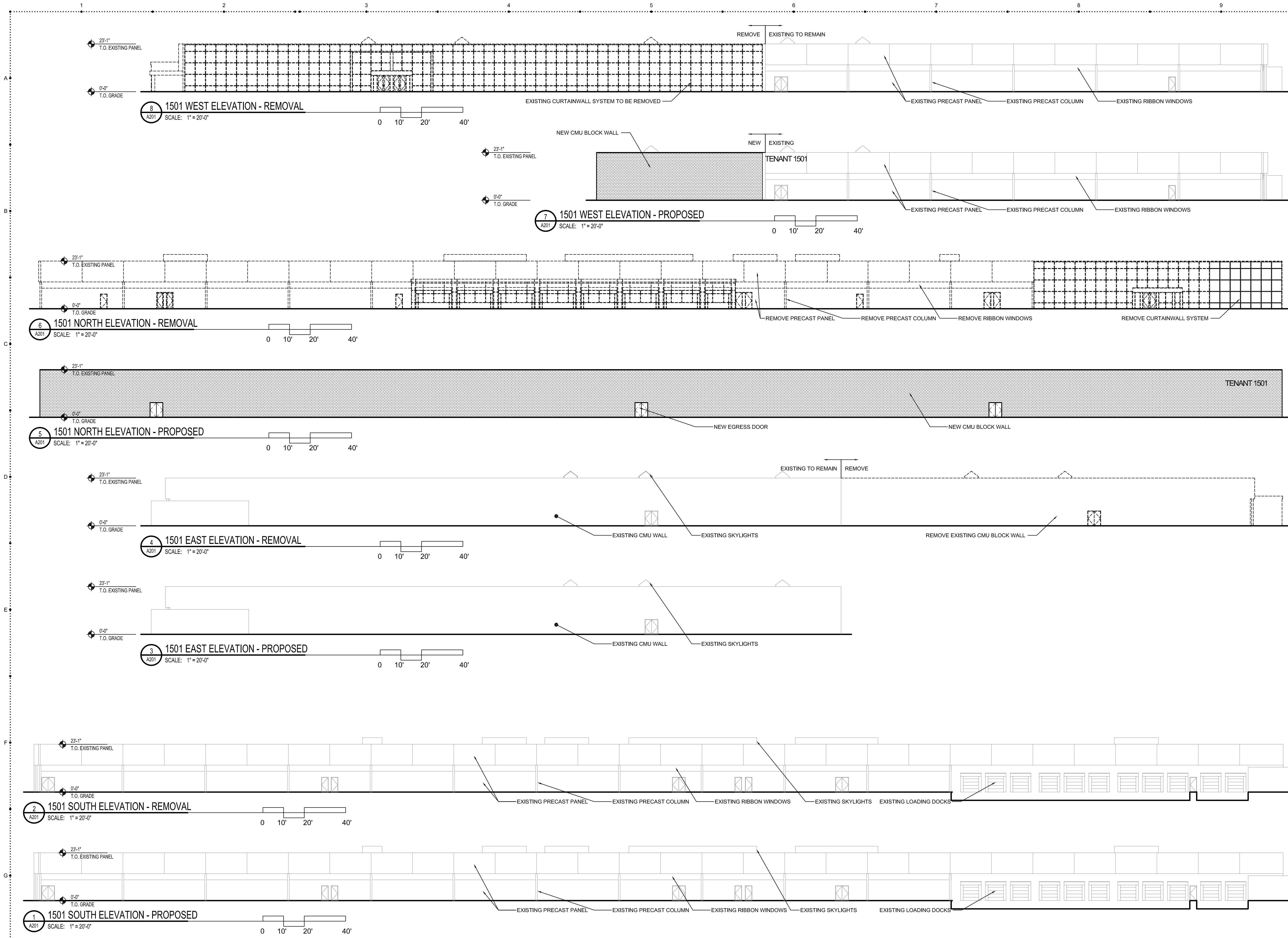

△		
△		
△		
△		
△		
△	1501 PUD	8.21.2015
△	NO. ISSUED FOR:	DATE:

OKW
Architects
600 W. Jackson Blvd.
Chicago, Illinois 60661
T 312.798.7700
F 312.798.7777
www.okwarchitects.com

NORTHWEST CROSSINGS
1421 AND 1501 SHURE DRIVE
ARLINGTON HEIGHTS, ILLINOIS
BUILDING ELEVATIONS

DRAWN BY: TJB CHECKED: TJB
DATE: 8.21.2015 SHEET NO:
PROJ. NO: 13043 **A201**



1 PROPOSED INTERIM IMPROVEMENTS
SCALE: N.T.S.

△		
△		
△		
△		
△		
△		
△	1501 PUD	8.21.2015
△	NO. ISSUED FOR:	DATE:

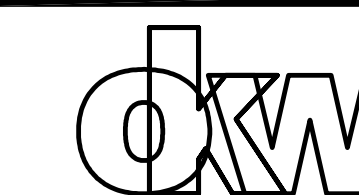

OKW
Architects
600 W. Jackson Blvd.
Chicago, Illinois 60661
T 312.798.7700
F 312.798.7777
www.okwarchitects.com

NORTHWEST CROSSINGS
1421 AND 1501 SHURE DRIVE
ARLINGTON HEIGHTS, ILLINOIS

PROPOSED INTERIM
IMPROVEMENTS
RENDERING

DRAWN BY: TJB CHECKED: TJB

DATE: 8.21.2015 SHEET NO:

PROJ. NO: 13043 A300