

3. Parking Analysis

Staff Comment #2: A Parking analysis should be submitted that included peak parking occupancy data at the Church’s existing location as well as estimates of the parking demand at the proposed location, including future increase to the congregation. The parking analysis should discuss any impacts to the surrounding public streets.

Staff Comment #5: Provide a diagram for possible additional parking on-site.”

In this analysis, we included;

- A. Background
- B. Peak Time Parking Analysis
- C. Estimated Future Parking Analysis
- D. Impacts to the surrounding public streets

A. Background

HNPC (Holy Nation Presbyterian Church) was established in 1987 and up until the sale of the property in 2014 had been located in 3434 W. Foster Ave., Chicago where there were only 4 parking spaces available as depicted below.



Interim to finding a new location, HNPC decided to lease a church property from Community Presbyterian church located in 407 N. Main St., Mt. Prospect to have our normal worship services throughout the week. As depicted below, there are exactly 49 available parking spaces at this location.

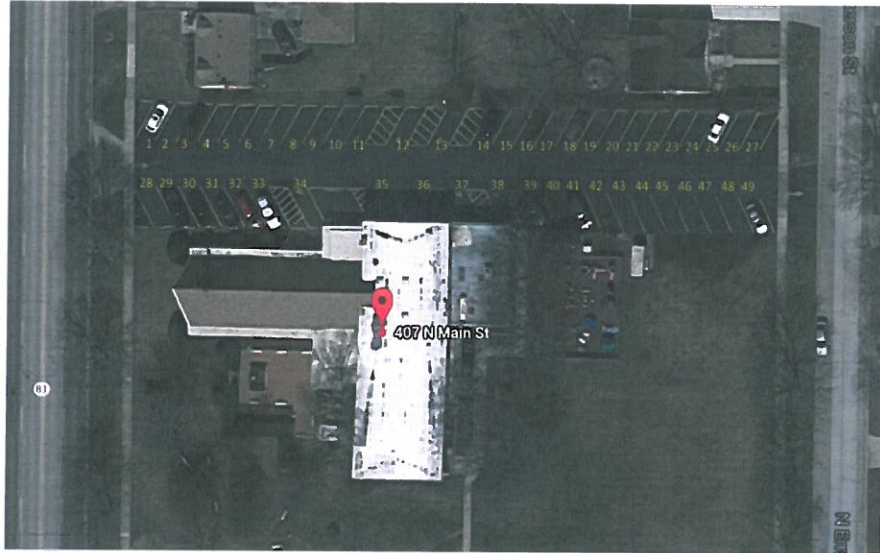

B. Peak Parking Analysis

Requested by the city of Arlington Heights, HNPC conducted a three week (2015-04-08 to 2015-04-28) parking analysis on number of cars parked during peak operating hours. These analysis were done on Wednesdays, Fridays, and Sundays where there would be worship services inviting all members to participate.

In average, there were 9.33 occupied parking spaces on Wednesdays, 13 on Fridays and 21.33 on Sundays.

The tables below show the information and we included some pictures gathered during the analysis.

Wednesday Service: Starts at 8 PM

Time/Date Parking Count was done: 8:30PM on 2015-04-08, 2015-04-15, and 2015-04-22

Service	Date	Total Available Space	Total Occupied Space
Wednesday	2015-04-08	49	9
Wednesday	2015-04-15	49	11
Wednesday	2015-04-22	49	8
Average		49	9.33

Friday Service: Starts at 8 PM

Time/Date Parking Count was done: 8:30PM on 2015-04-10, 2015-04-17, and 2015-04-24

Service	Date	Total Available Space	Total Occupied Space
Friday	2015-04-10	49	13
Friday	2015-04-17	49	15
Friday	2015-04-24	49	11
Average		49	13

Sunday Service: Starts at 1:30 PM

Time/Date Parking Count was done: 2:30PM on 2015-04-12, 2015-04-19, and 2015-04-26

Service	Date	Total Available Space	Total Occupied Space
Sunday	2015-04-12	49	21
Sunday	2015-04-19	49	19
Sunday	2015-04-26	49	24
Average		49	21.33

****Note on Sunday is that we are operating a van to accommodate the elderly and disabled to participate in worship services.*

