

TOTAL PARKING SPACES:
 62 SPACES
 (3 HANDICAPPED SPACES)

EXIST. ONE STORY
 BRICK BUILDING

CHESTNUT AVE.

WAVERLY ROAD

0 10 20 50 FEET



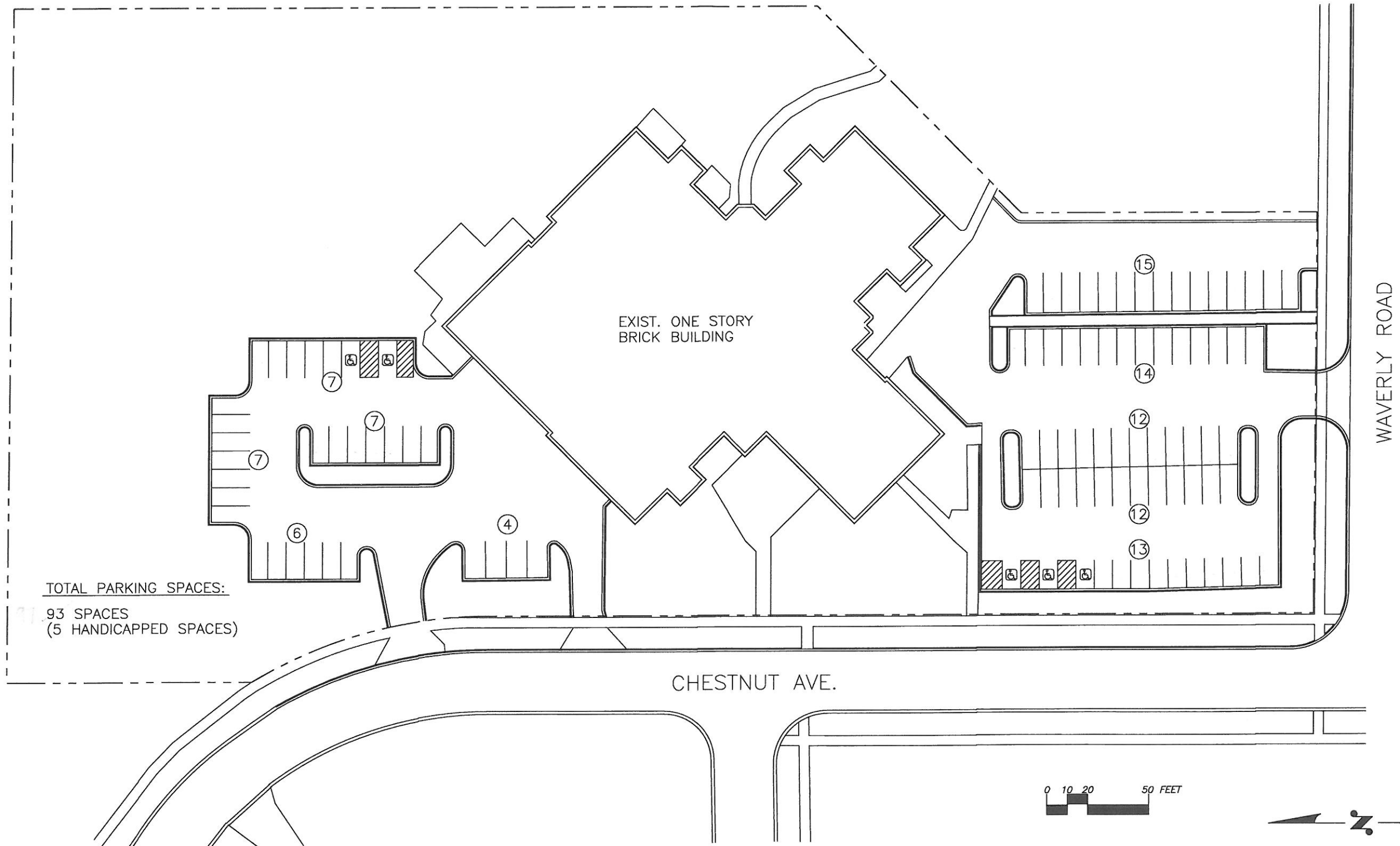

TOTAL PARKING SPACES:
 93 SPACES
 (5 HANDICAPPED SPACES)

D. Impacts to the surrounding public streets

As you have seen in the 'Peak Parking Analysis', all the occupied parking spaces were within the available parking spaces.

There were no impacts to the surrounding public streets during three (3) weeks of parking analysis period.

C. Estimated Future Parking Analysis with Plan

The Church started with less than 10 families (approximately 40 members) in 1988 and current number of congregational member has grown slowly to approximately 80 members. At this rate of growth, the anticipated congregation size would be about 160 members in 10 to 15 years.

As data indicated from peak parking analysis in this documentation the maximum number of parking spaces occupied on our currently leased location was on 2015-04-26, where we had occupied 24 parking spaces out of the 49 available. As seen from data in this documentation, we can conclude that Sundays tend to be our busiest operating day of the week and we are currently utilizing 22 parking spaces on average.

As noted above, HNPC operates a 17 passenger van to pick up and drop off the elderly and the disabled to be able to participate the Sunday worship services. We do have in budget to purchase another van similar to what we have now to accommodate more members to be picked up and dropped off to participate in the worship services.

Additionally, we have also included future parking plans (Land Banking Plan) on the following page to accommodate any need for additional parking spaces in the future for any unexpected reasons.