

VILLAGE OF ARLINGTON HEIGHTS NEW POLICE STATION

200 EAST SIGWALT STREET

ARLINGTON HEIGHTS, ILLINOIS 60005



SCHEDULE OF DRAWINGS

- GENERAL DRAWINGS
- G-001 TITLE SHEET
- CIVIL DRAWINGS
- C-101 SITE PLAN
- LANDSCAPE DRAWINGS
- L-101 LANDSCAPE PLAN
- ARCHITECTURAL DRAWINGS
- A-100 LOWER LEVEL FLOOR PLAN
- A-101 FIRST FLOOR PLAN
- A-102 SECOND FLOOR PLAN
- A-201 EXTERIOR BUILDING ELEVATIONS
- A-311 WALL SECTIONS
- A-R01 PERSPECTIVE VIEWS
- A-R02 AERIAL VIEWS

ARCHITECT

Legat Architects
2015 Spring Road - Suite 175
Oak Brook, Illinois 60523
P. 630.990.3535
F. 630.990.9541
www.legat.com

PUBLIC SAFETY CONSULTANT

McClaren, Wilson & Lawrie
330 S. Naperville Road - Suite 202
Wheaton, Illinois 60187
P. 630.858.3754
www.mwarchitects.com

M/E/P ENGINEER

20/10 Engineering Group
1216 Tower Road
Schaumburg, Illinois 60173
P. 847.882.2010
F. 847.882.2201
www.2010engineering.com

CIVIL ENGINEER

Mackie Consultants
9575 W. Higgins Road - Suite 500
Rosemont, Illinois 60018
P. 847.686.1400
F. 847.686.1410
www.mackieconsult.com

STRUCTURAL ENGINEER

Larson Engineering
1488 Bond Street - Suite 100
Naperville, Illinois 60563
P. 630.357.0540
F. 630.357.0164
www.larsonengr.com

LANDSCAPE ARCHITECT

Upland Design
24042 Lockport Street - Suite 200
Plainfield, Illinois 60544
P. 815.254.0091
F. 815.254.6010
www.uplanddesign.com

ENVIRONMENTAL CONSULTANT

TEM Environmental
443 Duane Street
Glen Ellyn, Illinois 60137
P. 630.790.0880
F. 630.790.0882
www.tem-enc.com

CONSTRUCTION MANAGER

Riley Construction
926 North Shore Drive
Lake Bluff, Illinois 60044
P. 847.457.3909
F. 847.457.3916
www.rileycon.com

SITE LOCATION MAP

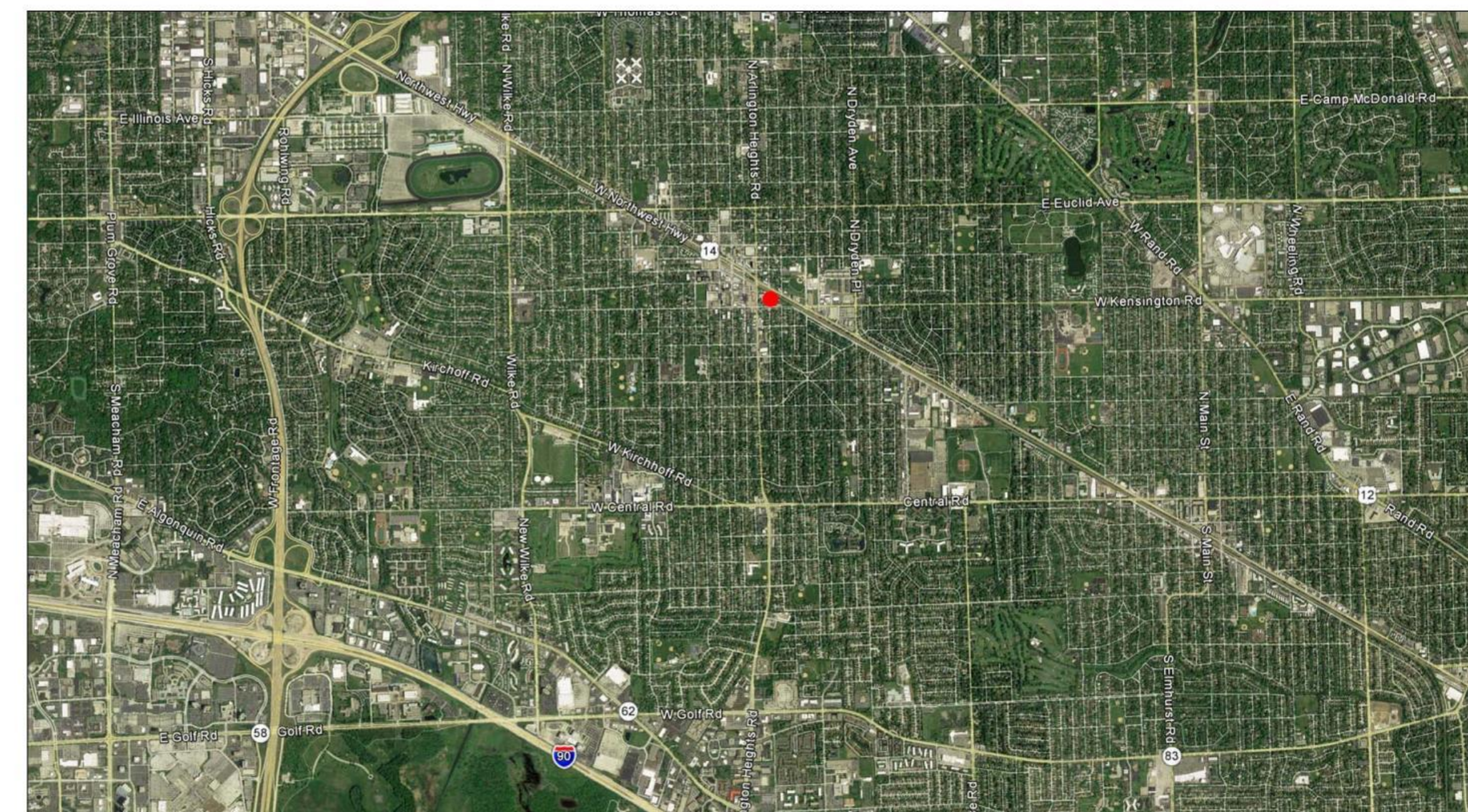

CAMPUS PLAN



VILLAGE BOARD MEMBERS

- THOMAS W. HAYES, Mayor
- CAROL J. BLACKWOOD, Trustee
- JOSEPH C. FARWELL, Trustee
- THOMAS GLASGOW, Trustee
- ROBIN LABEDZ, Trustee
- BERT ROSENBERG, Trustee
- JOHN SCALETTA, Trustee
- MIKE SIDOR, Trustee
- JIM TINAGLIA, Trustee

POLICE DEPARTMENT

- GERALD MOURNING, Chief of Police
- NICHOLAS PECORA, Deputy Chief
- MIGUEL HERNANDEZ, Deputy Chief
- ANDREW WHOWELL, Deputy Chief

POLICE STATION DESIGN TEAM

- CHARLES WITHERINGTON-PERKINS, Director of Planning
- SCOTT SHIRLEY, Director of Public Works
- CRIS PAPIERNIAK, Assistant Director of Public Works
- TOM KUEHNE, Finance Director / Treasurer
- STEVE HAUZINGER, Planning

RELEASE

PLAN COMMISSION

DATE OF ISSUE

NOVEMBER 18, 2016

ARCHITECT'S PROJECT NUMBER

216057.00

SIGNATURE

DATE

REVISIONS

NO.	DESCRIPTION	DATE

PROJECT NUMBER 216057.00
DATE OF ISSUE 11.23.16
DRAWN BY RM
CHECKED BY MCR

TITLE SHEET

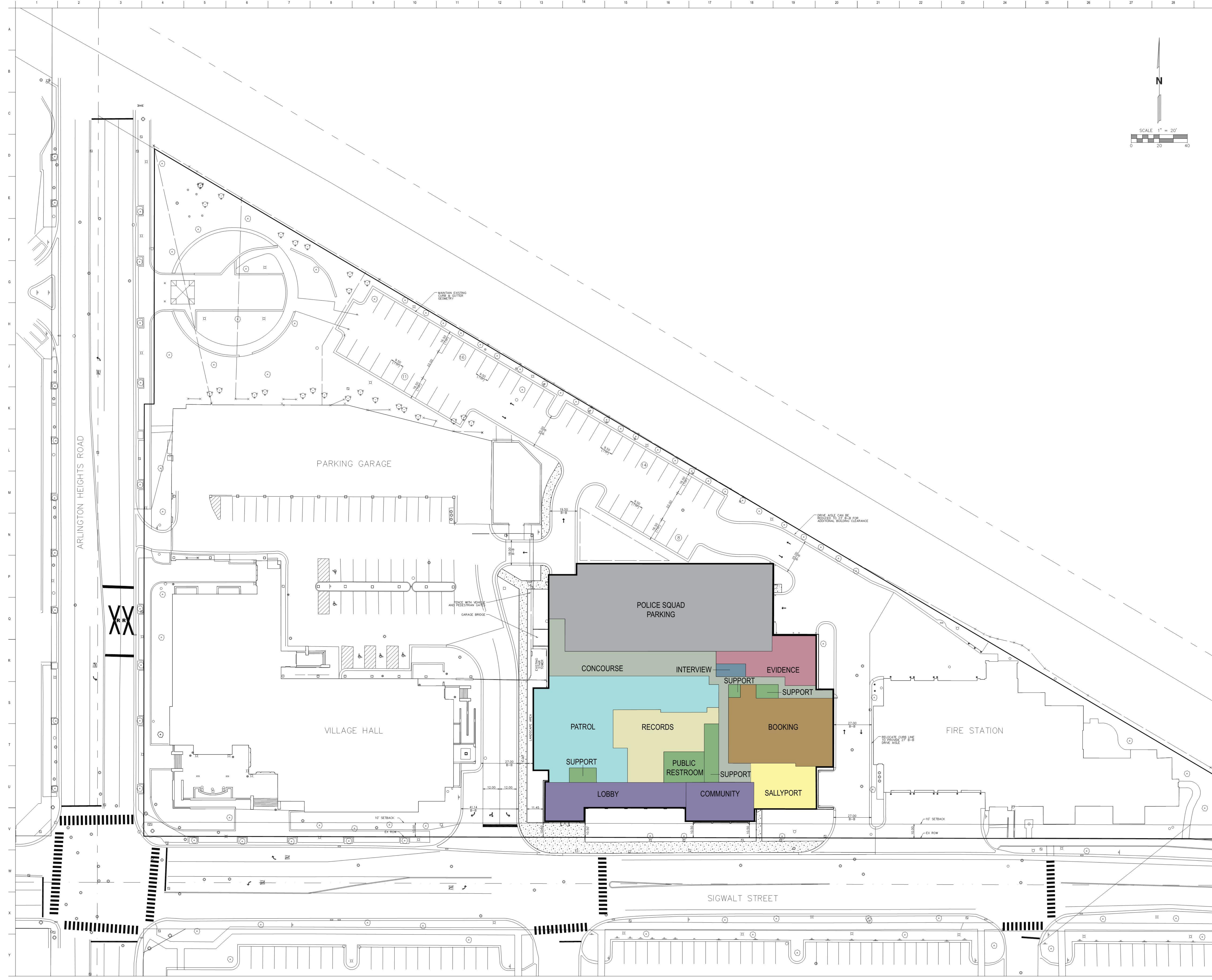

VILLAGE OF ARLINGTON HEIGHTS

NEW POLICE STATION

200 EAST SIGWALT STREET
ARLINGTON HEIGHTS
ILLINOIS 60005

ARCHITECT
Legat Architects
2015 Spring Road - Suite 175
Oak Brook, Illinois 60523
P. 630.990.3535
F. 630.990.9541
www.legat.com

PUBLIC SAFETY CONSULTANT
McClaren, Wilson & Lawrie
330 S. Naperville Road - Suite 202
Wheaton, Illinois 60187
P. 630.888.3784
www.mwlawr.com

MEP ENGINEER
20/10 Engineering Group
1216 Tower Road
Schaumburg, Illinois 60173
P. 847.882.2010
F. 847.882.2201
www.2010engineering.com

CIVIL ENGINEER
Mackie Consultants
9575 W. Higgins Road - Suite 500
Rosemont, Illinois 60018
P. 847.698.1400
F. 847.698.1410
www.mackiecons.com

STRUCTURAL ENGINEER
Larson Engineering
1488 Bond Street - Suite 100
Naperville, Illinois 60563
P. 630.357.0540
F. 630.357.0164
www.larsonengr.com

LANDSCAPE ARCHITECT
Upland Design
24042 Lockport Street - Suite 200
Plainfield, Illinois 60544
P. 815.254.0091
F. 815.254.6010
www.uplanddesign.com

ENVIRONMENTAL CONSULTANT
TEM Environmental
443 Duane Street
Olen Park, Illinois 60137
P. 630.790.0880
F. 630.790.0882
www.tem-inc.com

CONSTRUCTION MANAGER
Riley Construction
926 North Shore Drive
Lake Bluff, Illinois 60044
P. 847.457.3909
F. 847.457.3916
www.rileycon.com

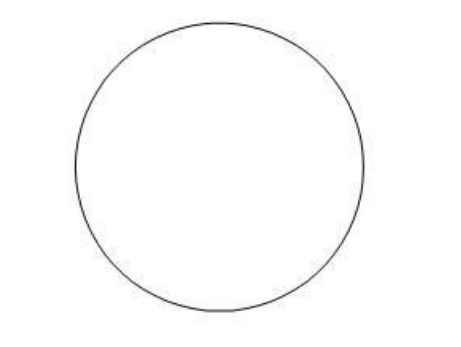

SIGNATURE _____
DATE _____

REVISIONS		
NO.	DESCRIPTION	DATE

PROJECT NUMBER 216057.00
DATE OF ISSUE 11.04.16
DRAWN BY KJM
CHECKED BY Checker

OVERALL SITE PLAN

ARCHITECT

Legat Architects
2015 Spring Road - Suite 175
Oak Brook, Illinois 60523
P. 630.990.3535
F. 630.990.9541
www.legat.com

PUBLIC SAFETY CONSULTANT

McClaren, Wilson & Lawrie
330 S. Naperville Road - Suite 202
Wheaton, Illinois 60187
P. 630.868.3764
www.mwarchitects.com

MEP ENGINEER

20/10 Engineering Group
1216 Tower Road
Schaumburg, Illinois 60173
P. 847.882.2010
F. 847.882.2201
www.2010engineering.com

CIVIL ENGINEER

Mackie Consultants
9575 W. Higgins Road - Suite 500
Rosemont, Illinois 60018
P. 847.696.1400
F. 847.696.1410
www.mackieconsult.com

STRUCTURAL ENGINEER

Larson Engineering
1488 Bond Street - Suite 100
Naperville, Illinois 60563
P. 630.357.0540
F. 630.357.0164
www.larsonengr.com

LANDSCAPE ARCHITECT

Upland Design
24042 Lockport Street - Suite 200
Plainfield, Illinois 60544
P. 815.254.0091
F. 815.254.6010
www.uplanddesign.com

ENVIRONMENTAL CONSULTANT

TEM Environmental
443 Duane Street
Glen Ellyn, Illinois 60137
P. 630.790.0880
F. 630.790.0882
www.tem-inc.com

CONSTRUCTION MANAGER

Riley Construction
926 North Shore Drive
Lake Bluff, Illinois 60044
P. 847.457.3909
F. 847.457.3916
www.rileycon.com

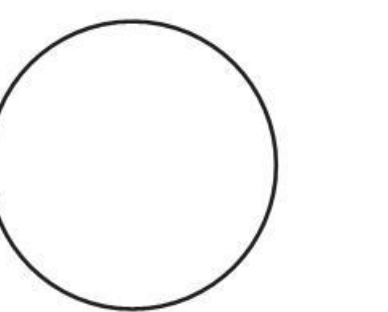

SIGNATURE _____
DATE _____

REVISIONS

NO.	DESCRIPTION	DATE

PROJECT NUMBER: 216057.00
DATE OF ISSUE: 11.23.16
DRAWN BY: M.C.R.
CHECKED BY: M.C.R.

BASEMENT PLAN

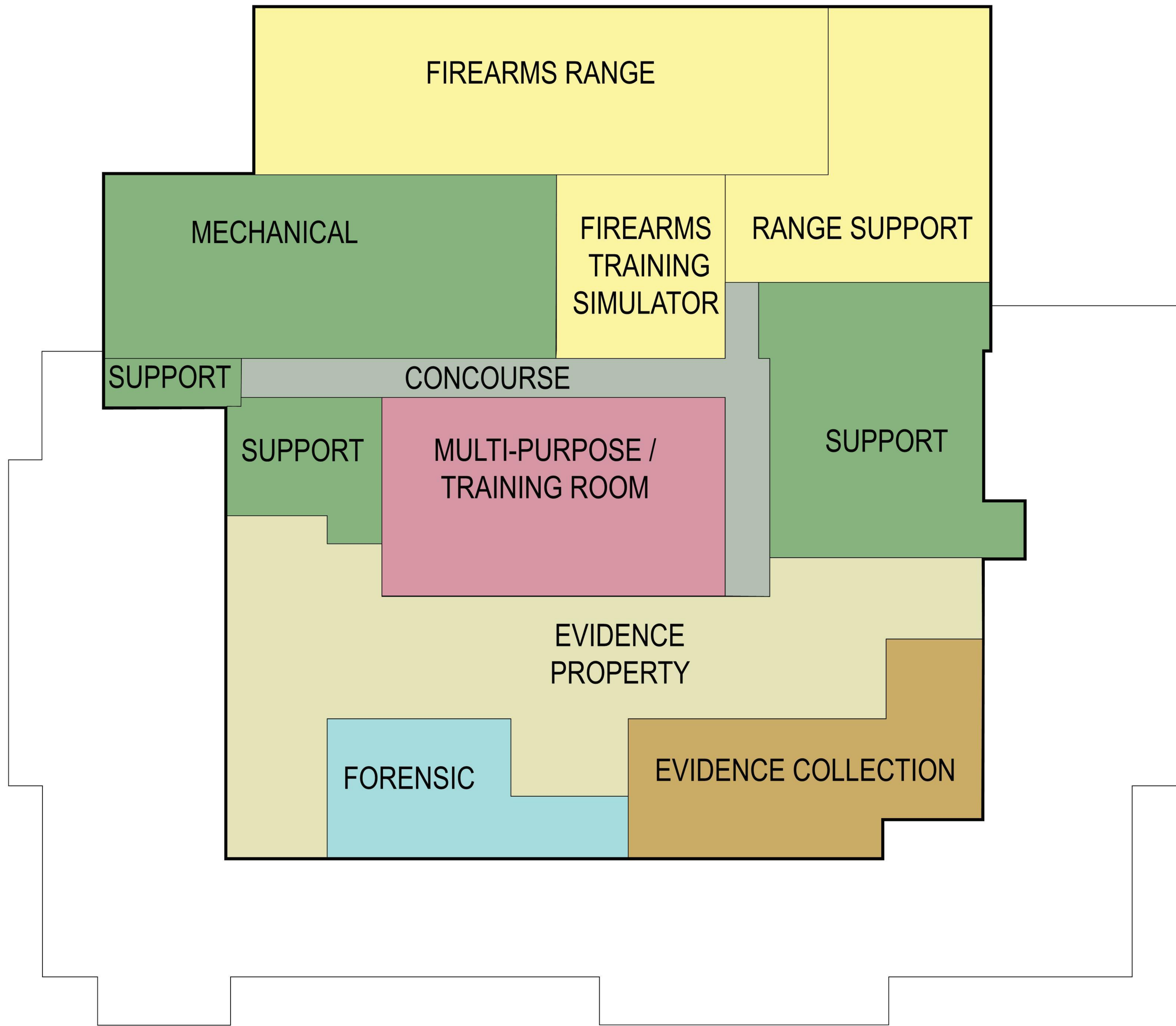

1 BASEMENT PLAN
1/8" = 1'-0"



BASEMENT

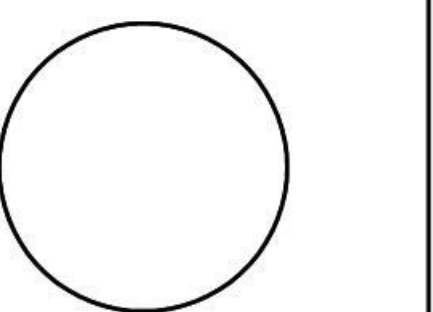

SIGNATURE _____
DATE _____

REVISIONS		
NO.	DESCRIPTION	DATE

PROJECT NUMBER 216057.00
DATE OF ISSUE 11.18.16
DRAWN BY M.C.R.
CHECKED BY M.C.R.

FIRST FLOOR PLAN

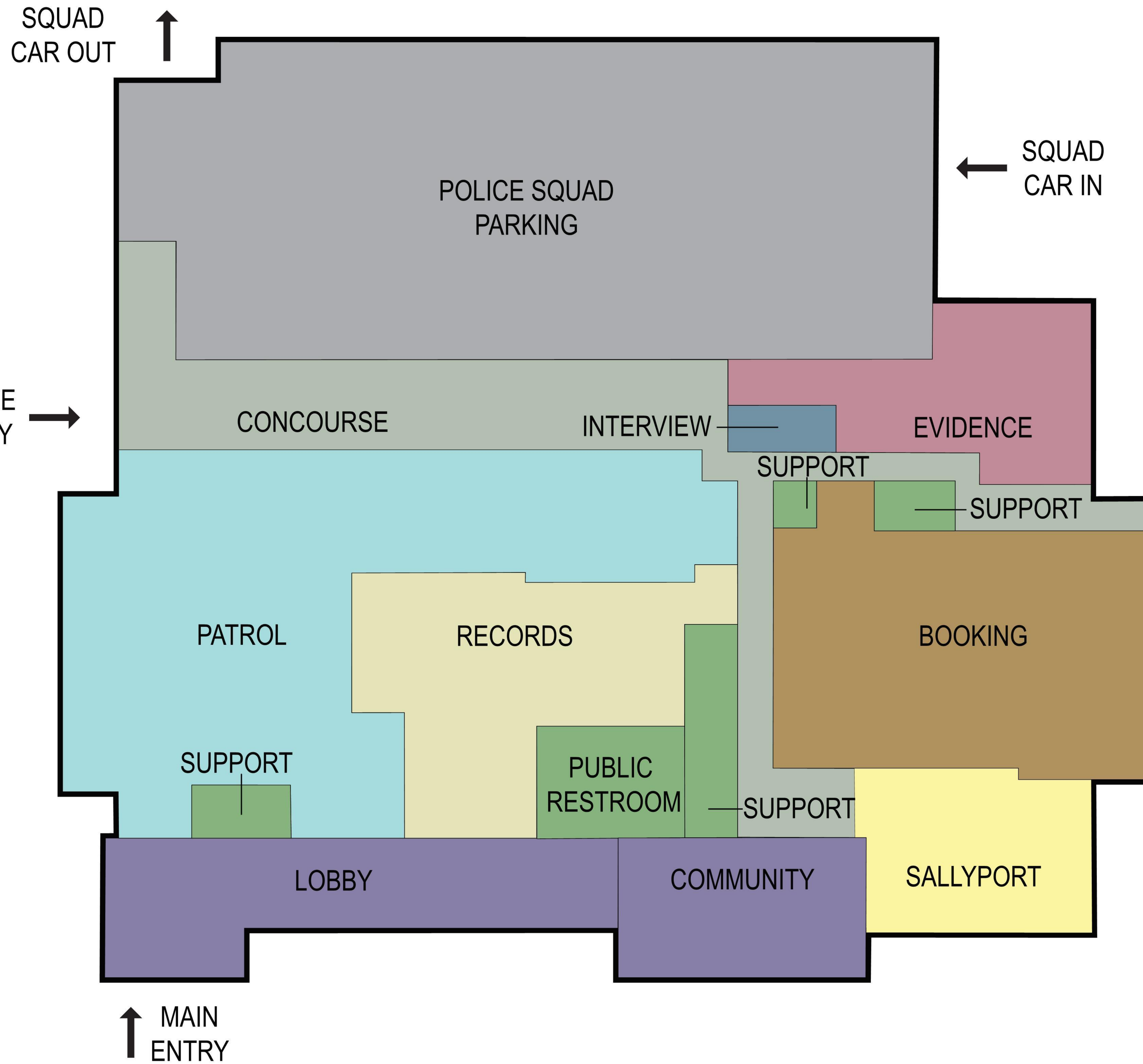

1 FIRST FLOOR PLAN
1/8" = 1'-0"

FIRST FLOOR

ARCHITECT

Legat Architects
2015 Spring Road - Suite 175
Oak Brook, Illinois 60523
P. 630.990.3535
F. 630.990.9541
www.legat.com

PUBLIC SAFETY CONSULTANT

McClaren, Wilson & Lawrie
330 S. Naperville Road - Suite 202
Wheaton, Illinois 60187
P. 630.868.3764
www.mwarchitects.com

MEP ENGINEER

20/10 Engineering Group
1216 Tower Road
Schaumburg, Illinois 60173
P. 847.882.2010
F. 847.882.2201
www.2010engineering.com

CIVIL ENGINEER

Mackie Consultants
9575 W. Higgins Road - Suite 500
Rosemont, Illinois 60018
P. 847.696.1400
F. 847.696.1410
www.mackieconsult.com

STRUCTURAL ENGINEER

Larson Engineering
1488 Bond Street - Suite 100
Naperville, Illinois 60563
P. 630.357.0540
F. 630.357.0164
www.larsonengr.com

LANDSCAPE ARCHITECT

Upland Design
24042 Lockport Street - Suite 200
Plainfield, Illinois 60544
P. 815.254.0091
F. 815.254.6010
www.uplanddesign.com

ENVIRONMENTAL CONSULTANT

TEM Environmental
443 Duane Street
Glen Ellyn, Illinois 60137
P. 630.790.0880
F. 630.790.0882
www.tem-inc.com

CONSTRUCTION MANAGER

Riley Construction
926 North Shore Drive
Lake Bluff, Illinois 60044
P. 847.457.3909
F. 847.457.3916
www.rileycon.com

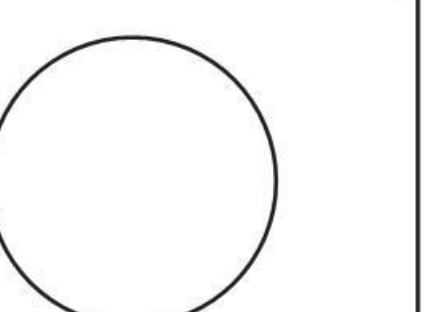

SIGNATURE _____
DATE _____

REVISIONS		
NO.	DESCRIPTION	DATE

PROJECT NUMBER: 216057.00
DATE OF ISSUE: 11.23.16
DRAWN BY: M.C.R.
CHECKED BY: M.C.R.

SECOND FLOOR PLAN

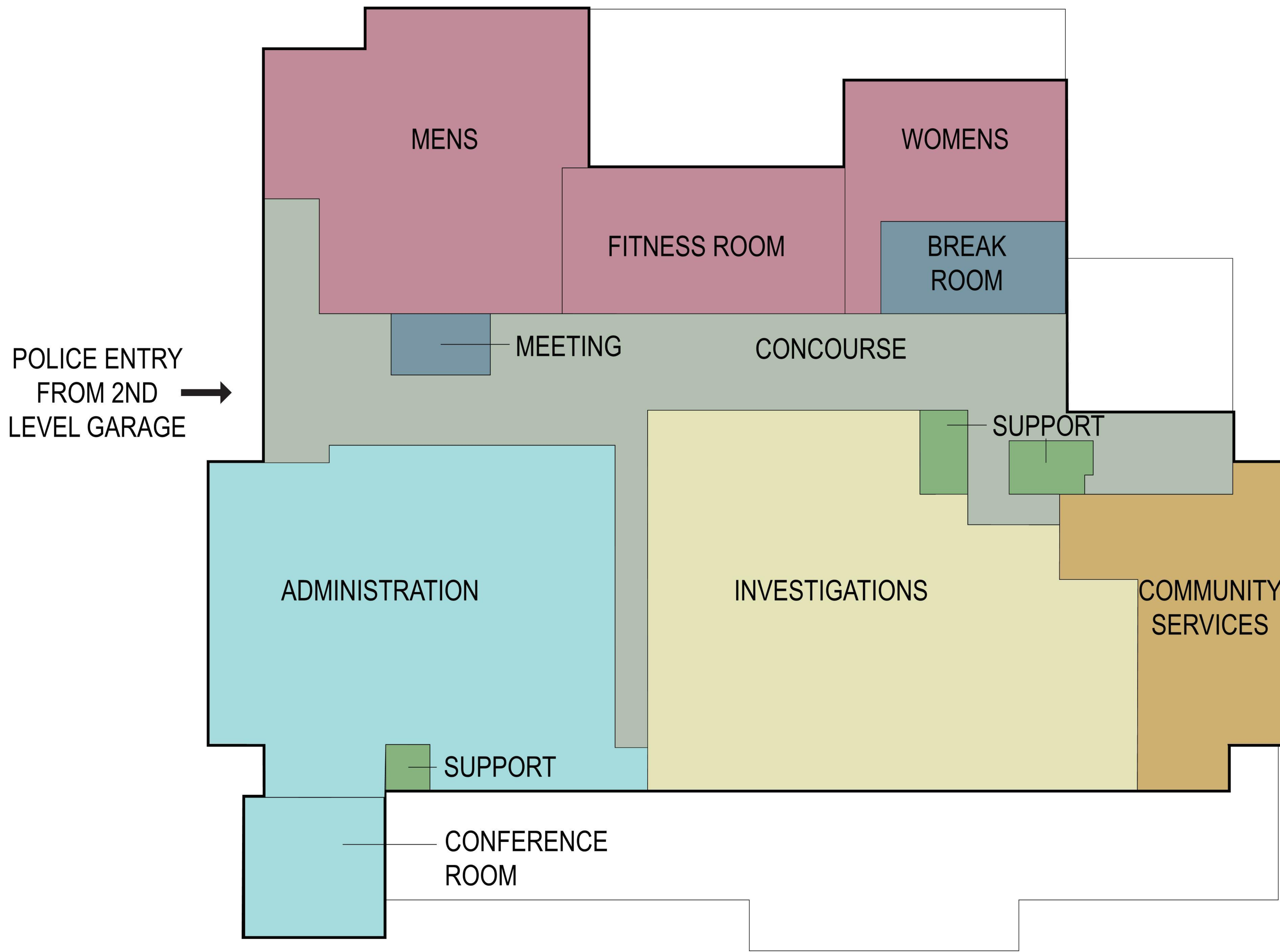

1 SECOND FLOOR PLAN
1/8" = 1'-0"
N

SECOND FLOOR