

PRELIMINARY ENGINEERING PLANS FOR ARLINGTON HEIGHTS POLICE STATION VILLAGE OF ARLINGTON HEIGHTS, ILLINOIS

LEGEND	EXISTING	PROPOSED
SANITARY SEWER		
FORCE MAIN		
STORM SEWER		
UNDERDRAIN		
MANHOLE		
CATCH BASIN		
INLET		
CLEANOUT		
WATER MAIN		
VALVE VAULT		
VALVE BOX		
FIRE HYDRANT		
FLARED END SECTION		
COMBINED SEWER		
STREET LIGHT/PARKING LOT LIGHT		
POWER POLE		
STREET SIGN		
FENCE		
GAS MAIN		
OVERHEAD LINE		
TELEPHONE LINE		
ELECTRIC LINE		
CABLE TV LINE		
HIGH WATER LEVEL		
NORMAL WATER LEVEL		
CONTOUR LINE		
TOP OF CURB ELEVATION		
TOP OF DEPRESSED CURB		
PAVEMENT ELEVATION		
SPOT ELEVATION		
FINISHED FLOOR ELEVATION		
TOP OF FOUNDATION		
GRADE AT FOUNDATION		
HIGH OR LOW POINT		
OVERLAND FLOOD ROUTE		
PAVEMENT FLOW DIRECTION		
SWALE FLOW DIRECTION		
DEPRESSED CURB AND GUTTER		
REVERSE CURB AND GUTTER		

INDEX
C-100 COVER SHEET
C-101 PRELIMINARY OVERALL SITE PLAN
C-102 PRELIMINARY GRADING PLAN
C-103 PRELIMINARY UTILITY PLAN
C-104 PRELIMINARY PAVING PLAN
C-105 AMBULANCE TURNING MOVEMENT PLAN
C-106 FIRE TRUCK TURNING MOVEMENT PLAN
C-107 POLICE INTERCEPTOR TURNING MOVEMENT PLAN
C-108 SU-30 TURNING MOVEMENT PLAN

ABBREVIATIONS			
AC	ACRE	HWL	HIGH WATER ELEVATION
BC	BACK OF CURB	INL	INLET
BTM	BOTTOM	INV	INVERT
CB	CATCH BASIN	LF	LINEAL FEET/FOOT
CFS	CUBIC FEET PER SECOND	LP	LIGHT POLE
CY	CUBIC YARD	LT	LEFT
DIA	DIAMETER	L/W	LOWEST GRADE ADJACENT TO RETAINING WALL
DIWM	DUCTILE IRON WATER MAIN	MAX	MAXIMUM
EL	ELEVATION	MH	STORM MANHOLE
EP	EDGE OF PAVEMENT	MIN	MINIMUM
FF	FINISHED FLOOR	NWL	NORMAL WATER ELEVATION
FES	FLARED END SECTION	OCS	OUTLET CONTROL STRUCTURE
FT	FOOT/FEET	P	PAVEMENT ELEVATION
G	GUTTER ELEVATION	PVC	POLYVINYL CHLORIDE PIPE
GF	GRADE AT FOUNDATION	R	RADIUS
GR	GRADE RING ELEVATION	RCP	REINFORCED CONCRETE PIPE
HDPE	HIGH DENSITY POLYETHYLENE PIPE	RIM	RIM ELEVATION
HYD	FIRE HYDRANT	RT	RIGHT
HMA	HOT MIX ASPHALT	ROW	RIGHT OF WAY
SAN	SANITARY SEWER	SMH	SANITARY MANHOLE
STA	STATION	STM	STORM SEWER
SY	SQUARE YARD	SWPP	STORMWATER POLLUTION PREVENTION PLAN
TDC	TOP OF DEPRESSED CURB	TC	TOP OF CURB
TF	TOP OF FOUNDATION	T/W	TOP OF RETAINING WALL
TYP	TYPICAL	VB	VALVE BOX
VC	VERTICAL CURVE	VV	VALVE VAULT
W	WALK ELEVATION	WM	WATER MAIN
VPI	VERTICAL POINT OF INTERSECTION		

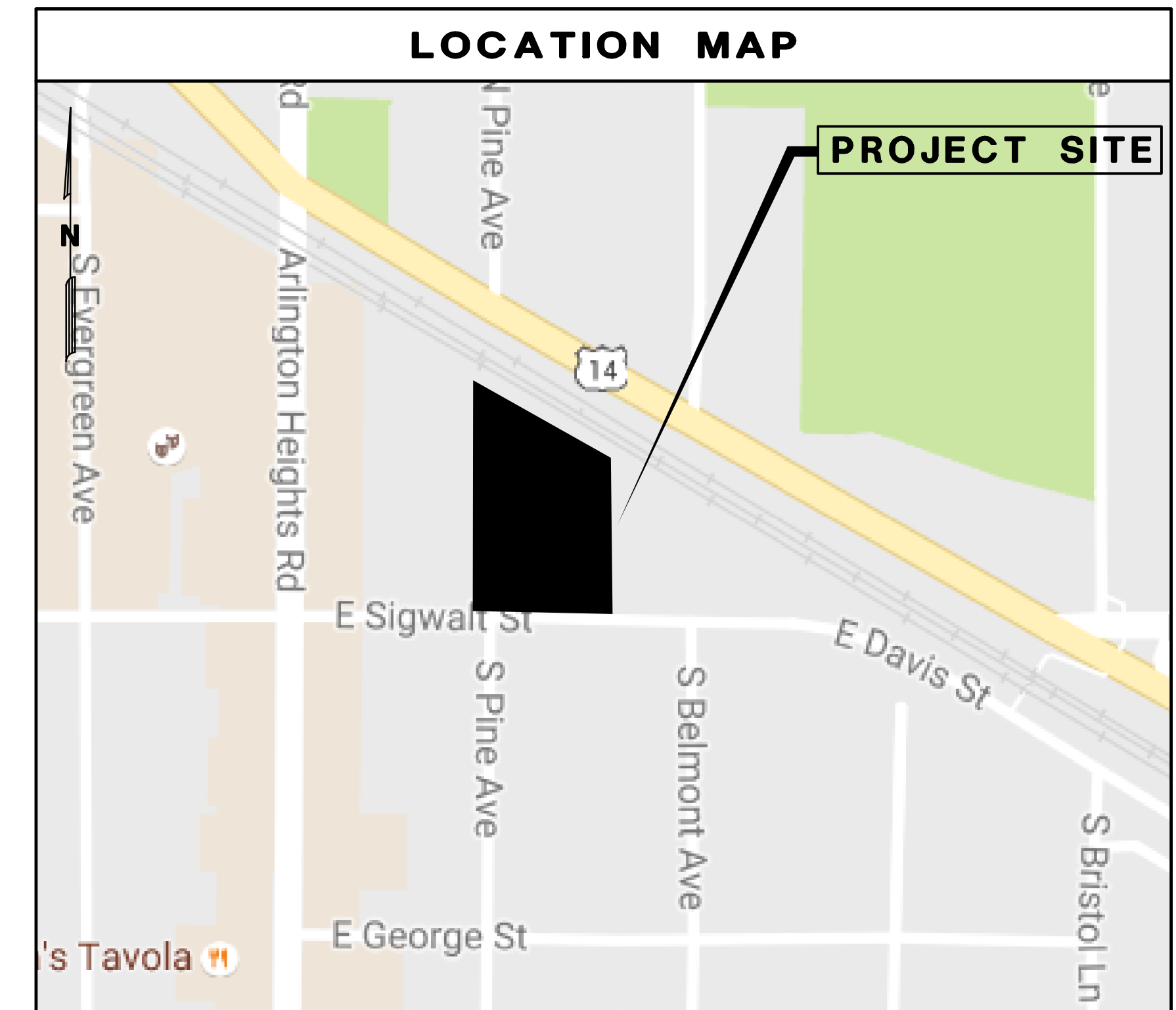

DRAINAGE CERTIFICATION
<p>I HEREBY CERTIFY THAT TO THE BEST OF MY KNOWLEDGE AND BELIEF, THE DRAINAGE OF SURFACE WATERS WILL NOT BE CHANGED BY THE CONSTRUCTION OF SAID IMPROVEMENTS OR ANY PART THEREOF, OR, THAT IF SUCH SURFACE WATER DRAINAGE WILL BE CHANGED, REASONABLE PROVISION HAS BEEN MADE FOR COLLECTION AND DIVERSION OF SUCH SURFACE WATERS INTO PUBLIC AREA, OR DRAINS WHICH THE SUBDIVIDER HAS A RIGHT TO USE AND THAT SUCH SURFACE WATERS WILL BE PLANNED FOR IN ACCORDANCE WITH GENERALLY ACCEPTED ENGINEERING PRACTICES TO REDUCE THE LIKELIHOOD OF DAMAGE TO THE ADJOINING PROPERTY BECAUSE OF THE CONSTRUCTION OF THE IMPROVEMENTS.</p>
 ENGINEER'S SIGNATURE

SOURCE BENCHMARK:
VILLAGE OF ARLINGTON HEIGHTS MONUMENT 57. 3" BRASS DISK IN CONCRETE 35 FEET +/- NORTH OF THE CENTERLINE OF SOUTH STREET AND 23 FEET +/- WEST OF THE CENTERLINE OF HIGHLAND AVENUE AT THE NORTHWEST CORNER OF THE INTERSECTION. ELEVATION = 684.82 (NAVD 1988)

SITE BENCHMARKS:
SITE BENCHMARK #3: NORTHEAST BONNET BOLT OF A FIRE HYDRANT LOCATED ON THE NORTH SIDE OF SIGWALT STREET NEAR THE SOUTHWEST CORNER OF THE MUNICIPAL BUILDING. ELEVATION = 685.99
SITE BENCHMARK #4: NORTHWEST BONNET BOLT OF A FIRE HYDRANT LOCATED ON THE WEST SIDE OF ARLINGTON HEIGHTS ROAD NEAR THE NORTHWEST CORNER OF THE SITE. ELEVATION = 695.93

JOINT UTILITY LOCATING INFORMATION FOR EXCAVATORS

Call 48 hours before you dig
(Excluding Sat, Sun, & Holidays)

1-800-892-0123

11/02/2017 3:24:34 PM M:\2017\Engineering\Photos\Preliminary\1000 - cover.plt

Mackie Consultants, LLC
9575 W. Higgins Road, Suite 500
Rosemont, IL 60018
(847)696-1400
www.mackieconsult.com

CLIENT:
VILLAGE OF ARLINGTON HEIGHTS
200 EAST SIGWALT STREET
ARLINGTON HEIGHTS, ILLINOIS 60005
PHONE: 847-368-5250

DATE	REVISION PER VILLAGE COMMENTS	JAD BY
01-27-17	REVISED PER VILLAGE COMMENTS	JAD
	DESCRIPTION OF REVISION	

DESIGNED	KJM
DRAWN	MSR
APPROVED	KJM
DATE	01/04/2017
SCALE	N.T.S.

COVER SHEET
ARLINGTON HEIGHTS POLICE STATION
ARLINGTON HEIGHTS, ILLINOIS

SHEET
C-100

PROJECT NUMBER: 2930
© MACKIE CONSULTANTS, LLC, 2017
ILLINOIS FIRM LICENSE 184-002694

PARKING STALL SUMMARY	
EXTERIOR PARKING LOT	50 SPACES
INTERIOR PARKING AREA	28 SPACES
TOTAL PARKING SPACES	78 SPACES

- MWRD GENERAL NOTES**
- A. REFERENCED SPECIFICATIONS**
- ALL CONSTRUCTION SHALL BE IN ACCORDANCE WITH THE APPLICABLE SECTIONS OF THE FOLLOWING, EXCEPT AS MODIFIED HEREIN OR ON THE PLANS:
 - STANDARD SPECIFICATIONS FOR ROAD AND BRIDGE CONSTRUCTION (LATEST EDITION), BY THE ILLINOIS DEPARTMENT OF TRANSPORTATION (IDOT SS) FOR ALL IMPROVEMENTS EXCEPT SANITARY SEWER AND WATER MAIN CONSTRUCTION;
 - STANDARD SPECIFICATIONS FOR WATER AND SEWER MAIN CONSTRUCTION IN ILLINOIS, LATEST EDITION (SSWS) FOR SANITARY SEWER AND WATER MAIN CONSTRUCTION;
 - VILLAGE OF ARLINGTON HEIGHTS MUNICIPAL CODE;
 - THE METROPOLITAN WATER RECLAMATION DISTRICT OF GREATER CHICAGO (MWRD) WATERSHED MANAGEMENT ORDINANCE AND TECHNICAL GUIDANCE MANUAL;
 - IN CASE OF CONFLICT BETWEEN THE APPLICABLE ORDINANCES NOTED, THE MORE STRINGENT SHALL TAKE PRECEDENCE AND SHALL CONTROL ALL CONSTRUCTION.

- B. NOTIFICATIONS**
- THE MWRD LOCAL SEWER SYSTEMS SECTION FIELD OFFICE MUST BE NOTIFIED AT LEAST TWO (2) WORKING DAYS PRIOR TO THE COMMENCEMENT OF ANY WORK (CALL 708-588-4055).
 - THE VILLAGE OF ARLINGTON HEIGHTS ENGINEERING DEPARTMENT AND PUBLIC MUST BE NOTIFIED AT LEAST 24 HOURS PRIOR TO THE START OF CONSTRUCTION AND PRIOR TO EACH PHASE OF WORK. CONTRACTOR SHALL DETERMINE ITEMS REQUIRING INSPECTION PRIOR TO START OF CONSTRUCTION OR EACH WORK PHASE.
 - THE CONTRACTOR SHALL NOTIFY ALL UTILITY COMPANIES PRIOR TO BEGINNING CONSTRUCTION FOR THE EXACT LOCATIONS OF UTILITIES AND FOR THEIR PROTECTION DURING CONSTRUCTION. IF EXISTING UTILITIES ARE ENCOUNTERED THAT CONFLICT IN LOCATION WITH NEW CONSTRUCTION, IMMEDIATELY NOTIFY THE ENGINEER SO THAT THE CONFLICT CAN BE RESOLVED. CALL J.U.I.E. AT 1-800-892-0123.

- C. GENERAL NOTES**
- ALL ELEVATIONS SHOWN ON PLANS REFERENCE THE NORTH AMERICAN VERTICAL DATUM OF 1988 (NAVD88).
 - MWRD, THE MUNICIPALITY AND THE OWNER OR OWNER'S REPRESENTATIVE SHALL HAVE THE AUTHORITY TO INSPECT, APPROVE, AND REJECT THE CONSTRUCTION IMPROVEMENTS.
 - THE CONTRACTOR(S) SHALL INDEMNIFY THE OWNER, ENGINEER, MUNICIPALITY, MWRD, AND THEIR AGENTS, ETC., FROM ALL LIABILITY INVOLVED WITH THE CONSTRUCTION, INSTALLATION, OR TESTING OF THIS WORK ON THE PROJECT.
 - THE PROPOSED IMPROVEMENTS MUST BE CONSTRUCTED IN ACCORDANCE WITH THE ENGINEERING PLANS AS APPROVED BY MWRD AND THE MUNICIPALITY UNLESS CHANGES ARE APPROVED BY MWRD, THE MUNICIPALITY, OR AUTHORIZED AGENT. THE CONSTRUCTION DETAILS, AS PRESENTED ON THE PLANS, MUST BE FOLLOWED. PROPER CONSTRUCTION TECHNIQUES MUST BE FOLLOWED ON THE IMPROVEMENTS INDICATED ON THE PLANS.
 - THE LOCATION OF VARIOUS UNDERGROUND UTILITIES WHICH ARE SHOWN ON THE PLANS ARE FOR INFORMATION ONLY AND REPRESENT THE BEST KNOWLEDGE OF THE ENGINEER. VERIFY LOCATIONS AND ELEVATIONS PRIOR TO BEGINNING THE CONSTRUCTION OPERATIONS.
 - ANY EXISTING PAVEMENT, SIDEWALK, DRIVEWAY, ETC., DAMAGED DURING CONSTRUCTION OPERATIONS AND NOT CALLED FOR TO BE REMOVED SHALL BE REPLACED AT THE EXPENSE OF THE CONTRACTOR.

- MATERIAL AND COMPACTION TESTING SHALL BE PERFORMED IN ACCORDANCE WITH THE REQUIREMENTS OF THE MUNICIPALITY, MWRD, AND OWNER.
- THE UNDERGROUND CONTRACTOR SHALL MAKE ALL NECESSARY ARRANGEMENTS TO NOTIFY ALL INSPECTION AGENCIES.
- ALL NEW AND EXISTING UTILITY STRUCTURES ON SITE AND IN AREAS DISTURBED DURING CONSTRUCTION SHALL BE ADJUSTED TO FINISH GRADE PRIOR TO FINAL INSPECTION.
- RECORD DRAWINGS SHALL BE KEPT BY THE CONTRACTOR AND SUBMITTED TO THE ENGINEER AS SOON AS UNDERGROUND IMPROVEMENTS ARE COMPLETED. FINAL PAYMENTS TO THE CONTRACTOR SHALL BE HELD UNTIL THEY ARE RECEIVED. ANY CHANGES IN LENGTH, LOCATION OR ALIGNMENT SHALL BE SHOWN IN RED. ALL WYES OR BENDS SHALL BE LOCATED FROM THE DOWNSTREAM MANHOLE. ALL VALVES, B-BOXES, TEES OR BENDS SHALL BE TIED TO A FIRE HYDRANT.
- DISCHARGING ANY UNPOLLUTED WATER INTO THE SANITARY SEWER SYSTEM FOR THE PURPOSE OF SEWER FLUSHING OF LINES FOR THE DEFLECTION TEST SHALL BE PROHIBITED WITHOUT PRIOR APPROVAL FROM THE MUNICIPALITY AND/OR MWRD.
- NO FINAL CONNECTION SHALL BE MADE TO THE EXISTING WATER MAIN SYSTEM UNTIL THE WATER MAIN HAS BEEN PRESSURE TESTED AND CHLORINATED.
- ALL NON-PAVING CONCRETE USED ON THE PROJECT SHALL BE IDOT CLASS SI.
- ALL FIELD DRAINAGE TILE ENCOUNTERED OR DAMAGED DURING CONSTRUCTION WHICH DRAIN OFFSITE PROPERTY SHALL BE CONNECTED TO THE STORM SEWER SYSTEM. ALL EXISTING FIELD DRAINAGE TILE ENCOUNTERED OR DAMAGED DURING CONSTRUCTION THAT SERVES ON-SITE PROPERTY CAN BE CAPPED AND/OR REMOVED FROM THE SITE.
- TRAFFIC CONTROL SIGNS SHALL BE INSTALLED DURING CONSTRUCTION IN ACCORDANCE WITH THE IDOT SS AND IN ACCORDANCE WITH THE MANUAL OF UNIFORM TRAFFIC CONTROL DEVICES. THE SAFE AND ORDERLY PASSAGE OF TRAFFIC AND PEDESTRIANS SHALL BE MAINTAINED AT ALL TIMES.

SITE PLAN GENERAL NOTES

- ALL DIMENSIONS ARE TO BACK OF CURB OR FACE OF BUILDING, UNLESS OTHERWISE NOTED.
- ALL RADII ARE TO BACK OF CURB, UNLESS OTHERWISE NOTED.
- ALL BUILDING DIMENSIONS ARE BASED ON ARCHITECTURAL PLANS. CONTRACTOR SHALL REFER TO ARCHITECTURAL PLANS FOR EXACT BUILDING DIMENSIONS AND CONTACT THE ARCHITECT FOR ANY DISCREPANCIES.
- ALL ONSITE PAVEMENT MARKINGS SHALL BE PAINTED, UNLESS OTHERWISE NOTED.
- ALL PROPOSED CURB AND GUTTER SHALL BE B6-12 AND SHALL BE DEPRESSED CURB WHERE SIDEWALK MEETS A STREET, UNLESS OTHERWISE INDICATED. CURB DEPRESSIONS SHALL MEET ADA REQUIREMENTS AS NOTED IN THE CONSTRUCTION DETAILS.
- ALL JOINTS MADE WITH EXISTING PAVEMENT, CURB, WALK OR CURB AND GUTTER ARE TO BE SAWCUT FULL DEPTH WITHIN 24 HOURS OF PLACEMENT.
- SEE ARCHITECTURAL PLANS FOR DETAILS OF SALLY PORT, EXAM BAY, EVIDENCE BAY, PARKING GARAGE AND SIDEWALK PLAN. SEE LANDSCAPE PLANS FOR HARDSCAPE AND PLANTING DETAILS.
- ALL CURB ISLANDS TO HAVE 1-FOOT MINIMUM RADIUS ON CORNERS, UNLESS OTHERWISE SHOWN.
- EXISTING CONDITIONS DEPICTED IN PLANS ARE BASED ON ALTA/SPS LAND TITLE SURVEY DATED AUGUST 10, 2016 BY MACKIE CONSULTANTS, LLC.

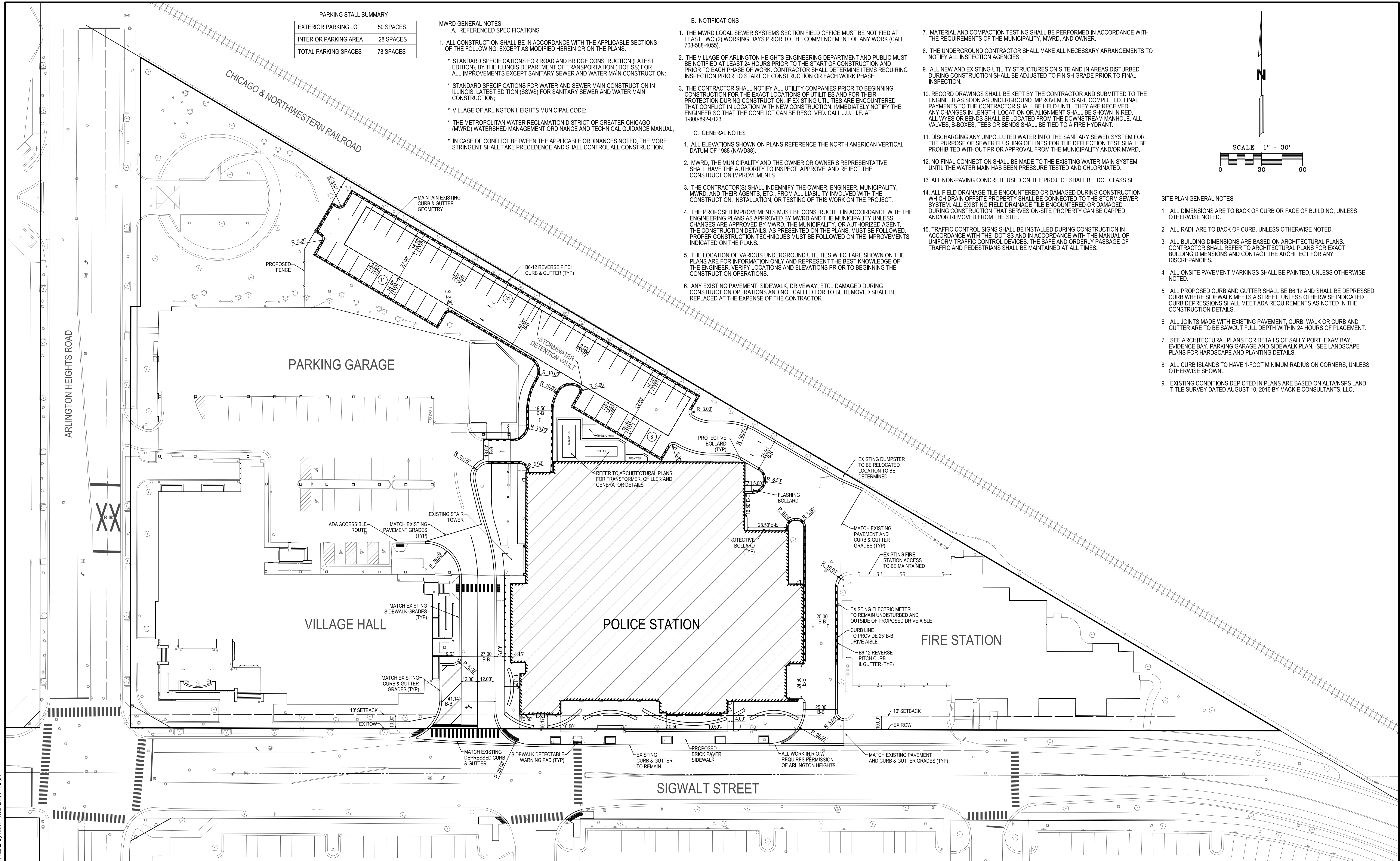
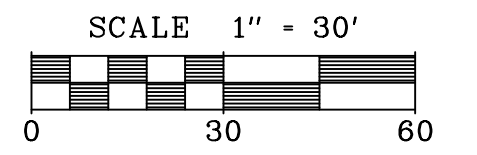

1/10/2017 2:56:12 PM M:\2017\Engineering\Photos\Drawings\1001 - Overall Site Plan.dwg

Mackie Consultants, LLC
 9575 W. Higgins Road, Suite 500
 Rosemont, IL 60018
 (847)696-1400
 www.mackieconsult.com

CLIENT:
VILLAGE OF ARLINGTON HEIGHTS
 200 EAST SIGWALT STREET
 ARLINGTON HEIGHTS, ILLINOIS 60005
 PHONE: 847-368-5250

DATE	DESCRIPTION OF REVISION	DATE	BY
01-27-17	REVISED PER VILLAGE COMMENTS	JAD	

DESIGNED	KJM
DRAWN	MSR
APPROVED	KJM
DATE	01/04/2017
SCALE	1" = 30'

PRELIMINARY OVERALL SITE PLAN
ARLINGTON HEIGHTS POLICE STATION
ARLINGTON HEIGHTS, ILLINOIS

SHEET	
C-101	
PROJECT NUMBER:	2930
© MACKIE CONSULTANTS, LLC, 2017	
ILLINOIS FIRM LICENSE 184-002694	

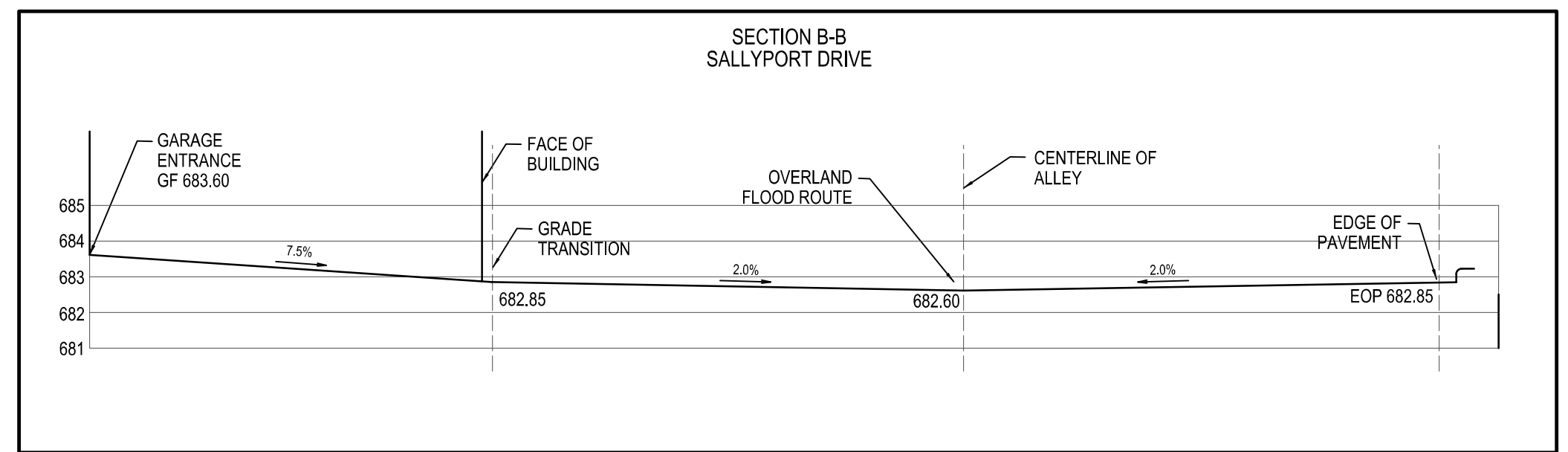
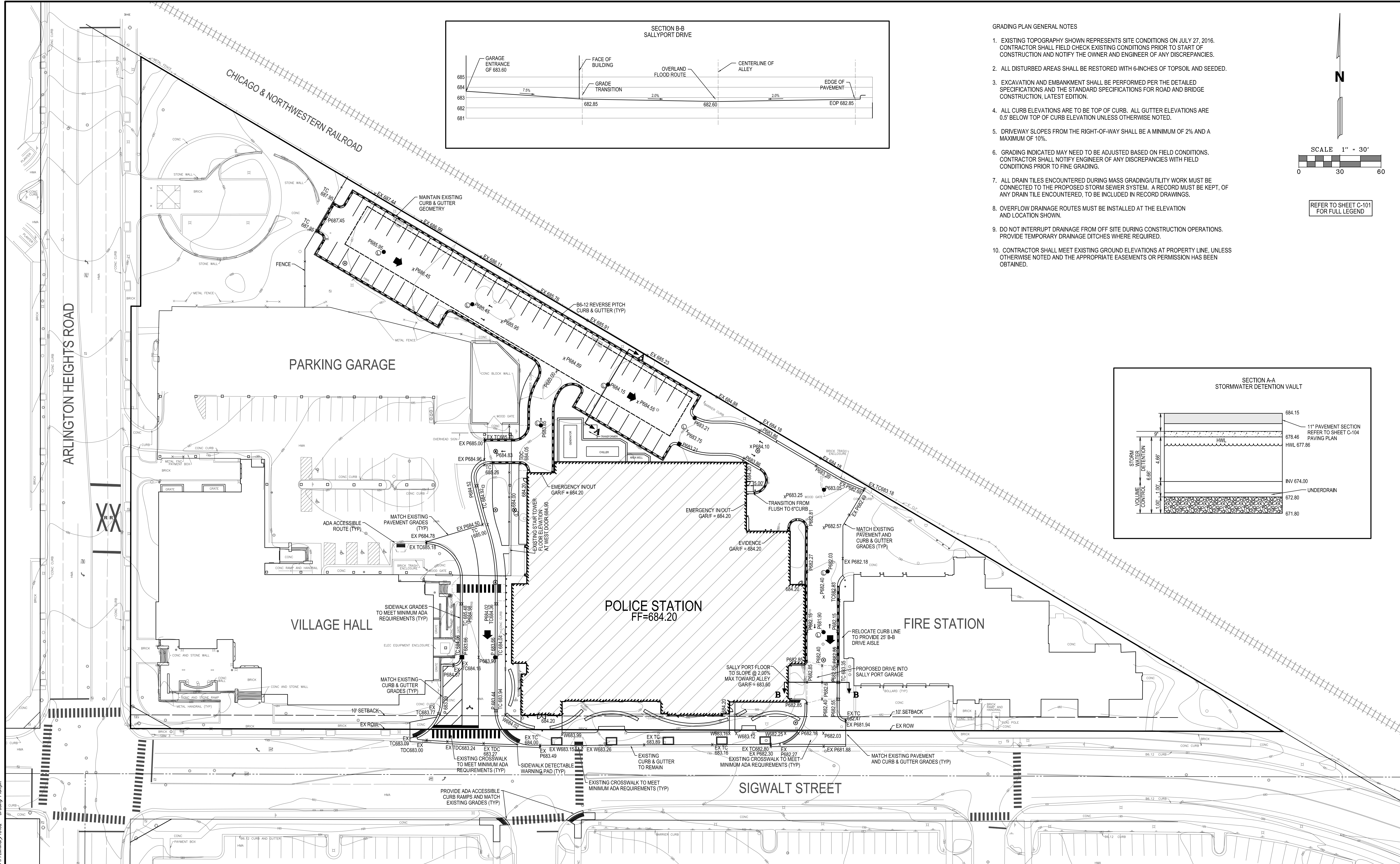

- GRADING PLAN GENERAL NOTES
- EXISTING TOPOGRAPHY SHOWN REPRESENTS SITE CONDITIONS ON JULY 27, 2016. CONTRACTOR SHALL FIELD CHECK EXISTING CONDITIONS PRIOR TO START OF CONSTRUCTION AND NOTIFY THE OWNER AND ENGINEER OF ANY DISCREPANCIES.
 - ALL DISTURBED AREAS SHALL BE RESTORED WITH 6-INCHES OF TOPSOIL AND SEEDED.
 - EXCAVATION AND EMBANKMENT SHALL BE PERFORMED PER THE DETAILED SPECIFICATIONS AND THE STANDARD SPECIFICATIONS FOR ROAD AND BRIDGE CONSTRUCTION, LATEST EDITION.
 - ALL CURB ELEVATIONS ARE TO BE TOP OF CURB. ALL GUTTER ELEVATIONS ARE 0.5' BELOW TOP OF CURB ELEVATION UNLESS OTHERWISE NOTED.
 - DRIVEWAY SLOPES FROM THE RIGHT-OF-WAY SHALL BE A MINIMUM OF 2% AND A MAXIMUM OF 10%.
 - GRADING INDICATED MAY NEED TO BE ADJUSTED BASED ON FIELD CONDITIONS. CONTRACTOR SHALL NOTIFY ENGINEER OF ANY DISCREPANCIES WITH FIELD CONDITIONS PRIOR TO FINE GRADING.
 - ALL DRAIN TILES ENCOUNTERED DURING MASS GRADING/UTILITY WORK MUST BE CONNECTED TO THE PROPOSED STORM SEWER SYSTEM. A RECORD MUST BE KEPT, OF ANY DRAIN TILE ENCOUNTERED, TO BE INCLUDED IN RECORD DRAWINGS.
 - OVERFLOW DRAINAGE ROUTES MUST BE INSTALLED AT THE ELEVATION AND LOCATION SHOWN.
 - DO NOT INTERRUPT DRAINAGE FROM OFF SITE DURING CONSTRUCTION OPERATIONS. PROVIDE TEMPORARY DRAINAGE DITCHES WHERE REQUIRED.
 - CONTRACTOR SHALL MEET EXISTING GROUND ELEVATIONS AT PROPERTY LINE, UNLESS OTHERWISE NOTED AND THE APPROPRIATE EASEMENTS OR PERMISSION HAS BEEN OBTAINED.

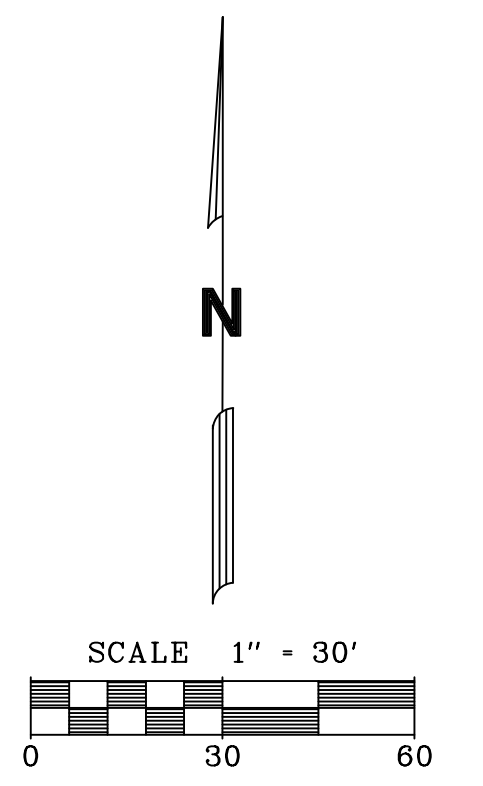

REFER TO SHEET C-101 FOR FULL LEGEND

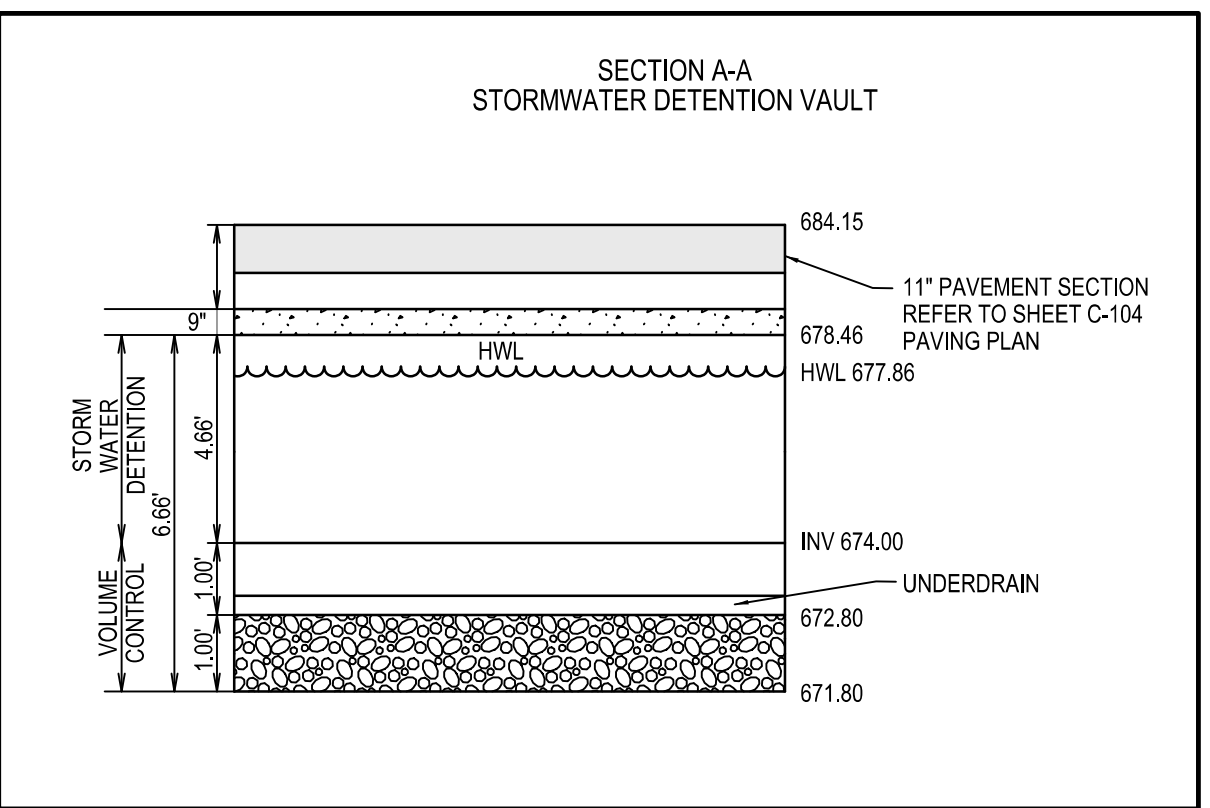

11/02/2017 11:55:16 AM M:\12520\Engineering\Photos\Preliminary\10102 - Grading Plan.dwg

Mackie Consultants, LLC
 9575 W. Higgins Road, Suite 500
 Rosemont, IL 60018
 (847)696-1400
 www.mackieconsult.com

CLIENT:
VILLAGE OF ARLINGTON HEIGHTS
 200 EAST SIGWALT STREET
 ARLINGTON HEIGHTS, ILLINOIS 60005
 PHONE: 847-368-5250

DESIGNED	KJM	DATE	01/27-17
DRAWN	MSR	REVISION	REVISED PER VILLAGE COMMENTS
APPROVED	KJM	DESCRIPTION OF REVISION	
DATE	01/04/2017		
SCALE	1" = 30'		

PRELIMINARY GRADING PLAN
ARLINGTON HEIGHTS POLICE STATION
ARLINGTON HEIGHTS, ILLINOIS

SHEET
C-102
 PROJECT NUMBER: 2930
 © MACKIE CONSULTANTS, LLC, 2017
 ILLINOIS FIRM LICENSE 184-002694

STORMWATER DETENTION SUMMARY	
100-YEAR /24-HR	
STORMWATER VOLUME REQUIRED	= 0.69 AC-FT
STORMWATER VOLUME PROVIDED	= 0.77 AC-FT
VAULT OUTLET INVERT	= 674.00
VOLUME CONTROL REQUIRED	= 0.16 AC-FT
VOLUME CONTROL PROVIDED	= 0.16 AC-FT

- UNDERGROUND UTILITY GENERAL NOTES
1. ALL MANHOLES AND CATCH BASINS SHALL BE 48-INCH DIAMETER, UNLESS OTHERWISE INDICATED.
 2. ALL SANITARY SEWER, LESS THAN 15 FEET DEEP, SHALL BE PVC, SDR 26, UNLESS OTHERWISE INDICATED. ALL SANITARY SEWERS GREATER THAN 15-FEET DEEP, SHALL BE DUCTILE IRON, CLASS 52, UNLESS OTHERWISE INDICATED. PVC SANITARY SEWER SHALL HAVE ELASTOMERIC JOINTS IN CONFORMANCE WITH ASTM D-3212.
 3. ALL WATER MAIN SHALL BE DUCTILE IRON PIPE, CLASS 52, AWWA C-600 WITH "PUSH-ON" TYPE JOINTS, UNLESS OTHERWISE INDICATED. ALL WATER MAIN SHALL HAVE A MINIMUM OF 5'-6" OF COVER FROM TOP OF WATERMAIN TO FINISHED GRADE.
 4. ALL STORM SEWERS SHALL BE REINFORCED CONCRETE PIPE, MINIMUM CLASS III, WITH ASTM C76 PIPE AND C443 JOINTS, UNLESS OTHERWISE INDICATED. ALL STORM SEWERS WHICH ARE LOCATED IN THE SIDE YARD SHALL HAVE "O"-RING GASKETED JOINTS. ALL OTHER SEWERS SHALL HAVE BITUMINOUS MASTIC JOINTS.
 5. GRANULAR TRENCH BACKFILL (CA-6) SHALL BE PROVIDED FOR ALL SANITARY, WATER AND STORM UTILITIES WHEN THE TRENCH LIMITS FALL WITHIN TWO FEET OF STREETS, SIDEWALKS, DRIVEWAYS AND AS NOTED ON THE SANITARY TRENCH DETAIL ON PAGE X. ALL TRENCHES WITHIN COOK COUNTY RIGHT-OF-WAY MUST BE TRENCH BACKFILLED WITH FA-6 SAND IN ACCORDANCE WITH ARTICLE 550.07 OF THE STANDARD SPECIFICATIONS FOR ROAD AND BRIDGE CONSTRUCTION, LATEST EDITION.
 6. ALL WATERMAIN AND WATER SERVICE LINES SHALL BE PROTECTED FROM OTHER UTILITIES IN ACCORDANCE WITH SECTION 41-2.01 OF THE STANDARD SPECIFICATIONS FOR WATER AND SEWER CONSTRUCTION IN ILLINOIS.
 7. ALL UNDERGROUND UTILITY INFORMATION NOTED ON THE PLANS IS BASED ON INFORMATION OBTAINED FROM THE MUNICIPALITY, UTILITY COMPANIES OR FIELD MEASUREMENTS. THIS INFORMATION, WHILE BELIEVED TO BE COMPLETE AND ACCURATE, CANNOT BE GUARANTEED.
 8. CONTRACTOR SHALL VERIFY ALL BUILDING SERVICE LOCATIONS AND SIZES WITH ARCHITECTURAL PLANS PRIOR TO START OF CONSTRUCTION AND NOTIFY THE ENGINEER OR OWNER OF ANY DISCREPANCIES.
 9. CONTRACTOR TO VERIFY CANOPY AND ROOF DRAIN CONNECTION LOCATIONS AND SIZES WITH ARCHITECTURAL PLANS BEFORE CONSTRUCTION.
 10. SEE ARCHITECTURAL DRAWINGS FOR TRENCH DRAIN DETAILS AND SEWER CONNECTION LOCATIONS.
 11. CONTRACTOR SHALL CONTACT JULIE (1-800-892-0123) PRIOR TO START OF CONSTRUCTION TO LOCATE ALL UTILITIES WITHIN THE RIGHT-OF-WAY.
 12. CONTRACTOR SHALL VERIFY LOCATION AND DEPTH OF EXISTING UTILITIES AT ALL PROPOSED CONNECTIONS PRIOR TO START OF CONSTRUCTION AND NOTIFY THE ENGINEER AND OWNER OF ANY DISCREPANCIES.
 13. A TEN (10) FOOT MINIMUM SEPARATION SHALL BE PROVIDED BETWEEN THE WATERMAIN SERVICE AND THE SANITARY OR STORM SEWER SERVICES.
 14. IN CASE OF CONFLICTS, THE MUNICIPALITY STANDARDS AND NOTES SHALL TAKE PRECEDENCE.
 15. PLUMBING CONTRACTOR TO MAKE ALL CONNECTIONS WITH BUILDING SERVICES CONSTRUCTED BY UTILITY CONTRACTOR. SITE UTILITY CONTRACTOR TO CONSTRUCT SERVICES TO WITHIN 5-FEET OF BUILDING, EXCEPT WATER INTO BUILDING 1-FOOT ABOVE FLOOR WITH BLIND FLANGE AND PROVIDE TESTING.
 16. EXISTING PAVEMENT REMOVED FOR UTILITY CONSTRUCTION SHALL BE DONE BY THE RESPECTIVE UTILITY COMPANY AND PAID FOR SEPARATELY BY THE OWNER. CONTRACTOR SHALL BE RESPONSIBLE FOR THE COORDINATION OF THIS WORK INCIDENTAL TO THE CONTRACT.
 17. EXISTING OR PROPOSED MANHOLES, CATCH BASINS, INLETS AND VALVE VAULTS REQUIRING OVER 12-INCHES OF ADJUSTMENT RINGS SHALL USE AN ADDITIONAL BARREL SECTION TO MAINTAIN A MAXIMUM OF 12-INCH TOTAL ADJUSTMENT RING DEPTH.

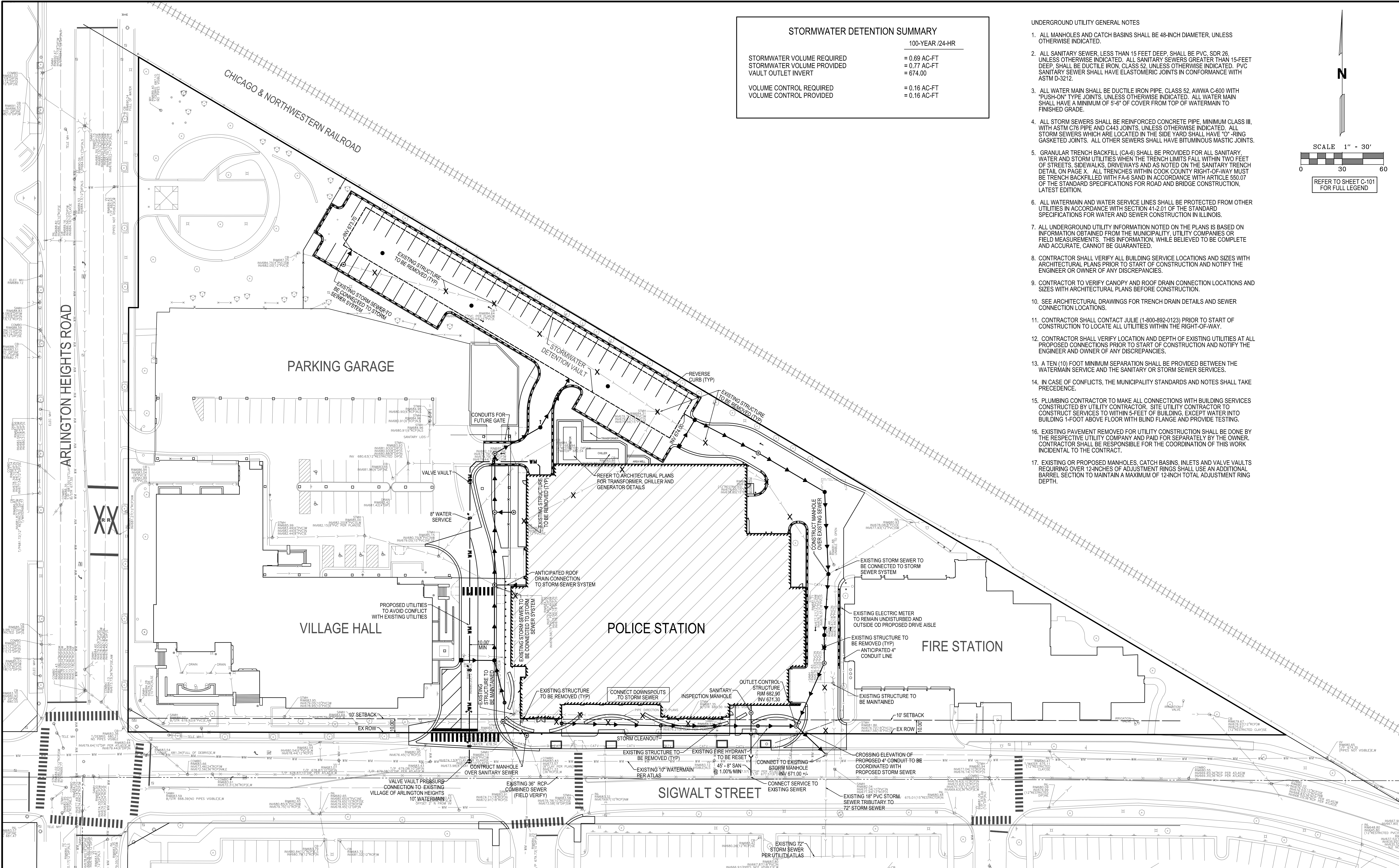
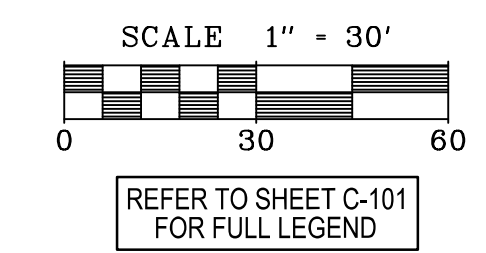

1/10/2017 11:41:54 AM M:\2017\Engineering\Police Station Preliminary\CD03 - Utility Plan.dwg

Mackie Consultants, LLC
 9575 W. Higgins Road, Suite 500
 Rosemont, IL 60018
 (847)696-1400
 www.mackieconsult.com

CLIENT:
VILLAGE OF ARLINGTON HEIGHTS
 200 EAST SIGWALT STREET
 ARLINGTON HEIGHTS, ILLINOIS 60005
 PHONE: 847-368-5250

DATE	DESCRIPTION OF REVISION	BY
01-27-17	REVISED PER VILLAGE COMMENTS	JAD

DESIGNED	KJM
DRAWN	MSR
APPROVED	KJM
DATE	01/04/2017
SCALE	1" = 30'

PRELIMINARY UTILITY PLAN
ARLINGTON HEIGHTS POLICE STATION
ARLINGTON HEIGHTS, ILLINOIS

SHEET	
C-103	
PROJECT NUMBER:	2930
© MACKIE CONSULTANTS LLC, 2017	
ILLINOIS FIRM LICENSE 184-002694	

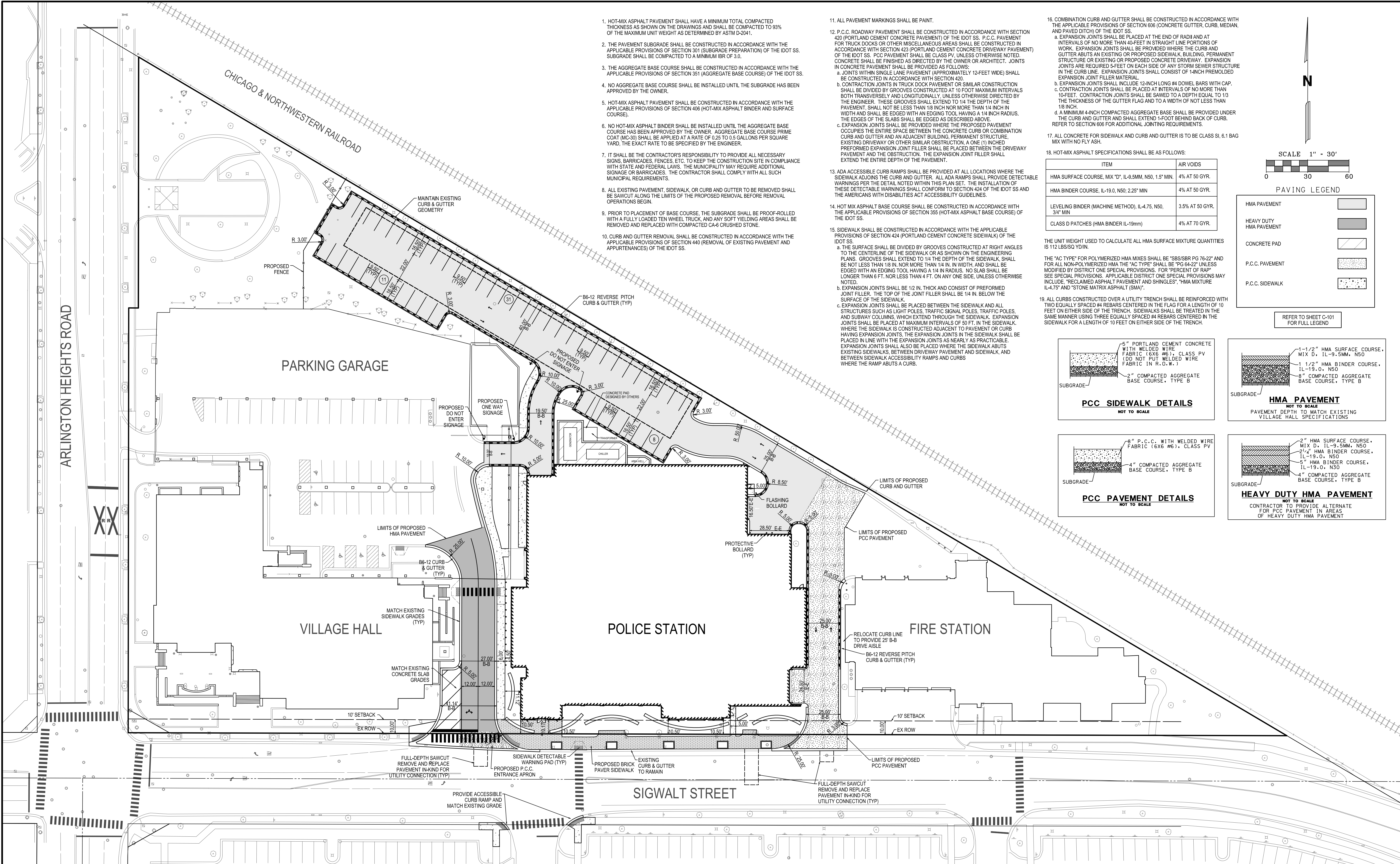

- HOT-MIX ASPHALT PAVEMENT SHALL HAVE A MINIMUM TOTAL COMPACTED THICKNESS AS SHOWN ON THE DRAWINGS AND SHALL BE COMPACTED TO 93% OF THE MAXIMUM UNIT WEIGHT AS DETERMINED BY ASTM D-2041.
- THE PAVEMENT SUBGRADE SHALL BE CONSTRUCTED IN ACCORDANCE WITH THE APPLICABLE PROVISIONS OF SECTION 301 (SUBGRADE PREPARATION) OF THE IDOT SS. SUBGRADE SHALL BE COMPACTED TO A MINIMUM IIR OF 3.0.
- THE AGGREGATE BASE COURSE SHALL BE CONSTRUCTED IN ACCORDANCE WITH THE APPLICABLE PROVISIONS OF SECTION 351 (AGGREGATE BASE COURSE) OF THE IDOT SS.
- NO AGGREGATE BASE COURSE SHALL BE INSTALLED UNTIL THE SUBGRADE HAS BEEN APPROVED BY THE OWNER.
- HOT-MIX ASPHALT PAVEMENT SHALL BE CONSTRUCTED IN ACCORDANCE WITH THE APPLICABLE PROVISIONS OF SECTION 406 (HOT-MIX ASPHALT BINDER AND SURFACE COURSE).
- NO HOT-MIX ASPHALT BINDER SHALL BE INSTALLED UNTIL THE AGGREGATE BASE COURSE HAS BEEN APPROVED BY THE OWNER. AGGREGATE BASE COURSE PRIME COAT (MC-30) SHALL BE APPLIED AT A RATE OF 0.25 TO 0.5 GALLONS PER SQUARE YARD, THE EXACT RATE TO BE SPECIFIED BY THE ENGINEER.
- IT SHALL BE THE CONTRACTOR'S RESPONSIBILITY TO PROVIDE ALL NECESSARY SIGNS, BARRICADES, FENCES, ETC. TO KEEP THE CONSTRUCTION SITE IN COMPLIANCE WITH STATE AND FEDERAL LAWS. THE MUNICIPALITY MAY REQUIRE ADDITIONAL SIGNAGE OR BARRICADES. THE CONTRACTOR SHALL COMPLY WITH ALL SUCH MUNICIPAL REQUIREMENTS.
- ALL EXISTING PAVEMENT, SIDEWALK, OR CURB AND GUTTER TO BE REMOVED SHALL BE SAWCUT ALONG THE LIMITS OF THE PROPOSED REMOVAL BEFORE REMOVAL OPERATIONS BEGIN.
- PRIOR TO PLACEMENT OF BASE COURSE, THE SUBGRADE SHALL BE PROOF-ROLLED WITH A FULLY LOADED TEN WHEEL TRUCK, AND ANY SOFT YIELDING AREAS SHALL BE REMOVED AND REPLACED WITH COMPACTED 6-8 CRUSHED STONE.
- CURB AND GUTTER REMOVAL SHALL BE CONSTRUCTED IN ACCORDANCE WITH THE APPLICABLE PROVISIONS OF SECTION 440 (REMOVAL OF EXISTING PAVEMENT AND APPURTENANCES) OF THE IDOT SS.

- ALL PAVEMENT MARKINGS SHALL BE PAINT.
- P.C.C. ROADWAY PAVEMENT SHALL BE CONSTRUCTED IN ACCORDANCE WITH SECTION 420 (PORTLAND CEMENT CONCRETE PAVEMENT) OF THE IDOT SS. P.C.C. PAVEMENT FOR TRUCK DOCKS OR OTHER MISCELLANEOUS AREAS SHALL BE CONSTRUCTED IN ACCORDANCE WITH SECTION 423 (PORTLAND CEMENT CONCRETE DRIVEWAY PAVEMENT) OF THE IDOT SS. P.C.C. PAVEMENT SHALL BE CLASS PY UNLESS OTHERWISE NOTED. CONCRETE SHALL BE FINISHED AS DIRECTED BY THE OWNER OR ARCHITECT. JOINTS IN CONCRETE PAVEMENT SHALL BE PROVIDED AS FOLLOWS:
 - JOINTS WITHIN SINGLE LANE PAVEMENT (APPROXIMATELY 12-FOOT WIDE) SHALL BE CONSTRUCTED IN ACCORDANCE WITH SECTION 420.
 - CONTRACTION JOINTS IN TRUCK DOCK PAVEMENT OR SIMILAR CONSTRUCTION SHALL BE DIVIDED BY GROOVES CONSTRUCTED AT 10 FOOT MAXIMUM INTERVALS BOTH TRANSVERSELY AND LONGITUDINALLY, UNLESS OTHERWISE DIRECTED BY THE ENGINEER. THESE GROOVES SHALL EXTEND TO 1/4 THE DEPTH OF THE PAVEMENT, SHALL NOT BE LESS THAN 1/8 INCH NOR MORE THAN 1/4 INCH IN WIDTH AND SHALL BE EDGED WITH AN EDGING TOOL HAVING A 1/4 INCH RADIUS. THE EDGES OF THE SLABS SHALL BE EDGED AS DESCRIBED ABOVE.
 - EXPANSION JOINTS SHALL BE PROVIDED WHERE THE PROPOSED PAVEMENT OCCUPIES THE ENTIRE SPACE BETWEEN THE CONCRETE CURB OR COMBINATION CURB AND GUTTER AND AN ADJACENT BUILDING, PERMANENT STRUCTURE, EXISTING DRIVEWAY OR OTHER SIMILAR OBSTRUCTION. A ONE (1) INCH DEEP PREFORMED EXPANSION JOINT FILLER SHALL BE PLACED BETWEEN THE DRIVEWAY PAVEMENT AND THE OBSTRUCTION. THE EXPANSION JOINT FILLER SHALL EXTEND THE ENTIRE DEPTH OF THE PAVEMENT.
- ADA ACCESSIBLE CURB RAMPS SHALL BE PROVIDED AT ALL LOCATIONS WHERE THE SIDEWALK ADJOINS THE CURB AND GUTTER. ALL ADA RAMPS SHALL PROVIDE DETECTABLE WARNINGS PER THE DETAIL NOTED WITHIN THIS PLAN SET. THE INSTALLATION OF THESE DETECTABLE WARNINGS SHALL CONFORM TO SECTION 424 OF THE IDOT SS AND THE AMERICANS WITH DISABILITIES ACT ACCESSIBILITY GUIDELINES.
- HOT MIX ASPHALT BASE COURSE SHALL BE CONSTRUCTED IN ACCORDANCE WITH THE APPLICABLE PROVISIONS OF SECTION 355 (HOT-MIX ASPHALT BASE COURSE) OF THE IDOT SS.

- COMBINATION CURB AND GUTTER SHALL BE CONSTRUCTED IN ACCORDANCE WITH THE APPLICABLE PROVISIONS OF SECTION 606 (CONCRETE GUTTER, CURB, MEDIAN, AND PAVED DITCH) OF THE IDOT SS.
 - EXPANSION JOINTS SHALL BE PLACED AT THE END OF RADII AND AT INTERVALS OF NO MORE THAN 40 FEET IN STRAIGHT LINE PORTIONS OF WORK. EXPANSION JOINTS SHALL BE PROVIDED WHERE THE CURB AND GUTTER ABUTS AN EXISTING OR PROPOSED SIDEWALK, BUILDING, PERMANENT STRUCTURE OR EXISTING OR PROPOSED CONCRETE DRIVEWAY. EXPANSION JOINTS ARE REQUIRED 5 FEET ON EACH SIDE OF ANY STORM SEWER STRUCTURE IN THE CURB LINE. EXPANSION JOINTS SHALL CONSIST OF 1-INCH PREFORMED EXPANSION JOINT FILLER MATERIAL.
 - EXPANSION JOINTS SHALL INCLUDE 12-INCH LONG #4 DOWEL BARS WITH CAP.
 - CONTRACTION JOINTS SHALL BE PLACED AT INTERVALS OF NO MORE THAN 10 FEET. CONTRACTION JOINTS SHALL BE SAWS TO A DEPTH EQUAL TO 1/3 THE THICKNESS OF THE GUTTER FLAG AND TO A WIDTH OF NOT LESS THAN 1/8 INCH.
 - A MINIMUM 4-INCH COMPACTED AGGREGATE BASE SHALL BE PROVIDED UNDER THE CURB AND GUTTER AND SHALL EXTEND 1-FOOT BEHIND BACK OF CURB. REFER TO SECTION 606 FOR ADDITIONAL JOINTING REQUIREMENTS.
- ALL CONCRETE FOR SIDEWALK AND CURB AND GUTTER IS TO BE CLASS SI, 6.1 BAG MIX WITH NO FLY ASH.
- HOT-MIX ASPHALT SPECIFICATIONS SHALL BE AS FOLLOWS:

ITEM	AIR VOIDS
HMA SURFACE COURSE, MIX "D", IL-9.5MM, N50, 1.5" MIN	4% AT 50 GYR.
HMA BINDER COURSE, IL-19.0, N50, 2.25" MIN	4% AT 50 GYR.
LEVELING BINDER (MACHINE METHOD), IL-4.75, N50, 3/4" MIN	3.5% AT 50 GYR.
CLASS D PATCHES (HMA BINDER IL-19mm)	4% AT 70 GYR.

THE UNIT WEIGHT USED TO CALCULATE ALL HMA SURFACE MIXTURE QUANTITIES IS 112 LBS/SQ YD/IN.

THE "AC TYPE" FOR POLYMERIZED HMA MIXES SHALL BE "SBS/SBR PG 76-22" AND FOR ALL NON-POLYMERIZED HMA THE "AC TYPE" SHALL BE "PG 64-22" UNLESS MODIFIED BY DISTRICT ONE SPECIAL PROVISIONS. FOR "PERCENT OF RAP" SEE SPECIAL PROVISIONS. APPLICABLE DISTRICT ONE SPECIAL PROVISIONS MAY INCLUDE: "RECLAIMED ASPHALT PAVEMENT AND SHINGLES", "HMA MIXTURE IL-4.75" AND "STONE MATRIX ASPHALT (SMA)".

- ALL CURBS CONSTRUCTED OVER A UTILITY TRENCH SHALL BE REINFORCED WITH TWO EQUALLY SPACED #4 REBARS CENTERED IN THE FLAG FOR A LENGTH OF 10 FEET ON EITHER SIDE OF THE TRENCH. SIDEWALKS SHALL BE TREATED IN THE SAME MANNER USING THREE EQUALLY SPACED #4 REBARS CENTERED IN THE SIDEWALK FOR A LENGTH OF 10 FEET ON EITHER SIDE OF THE TRENCH.

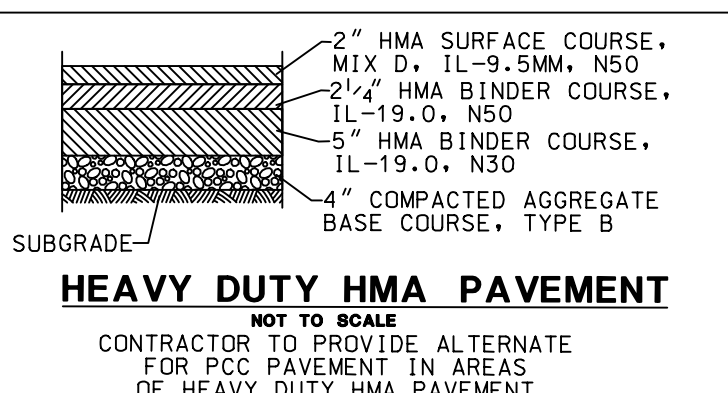
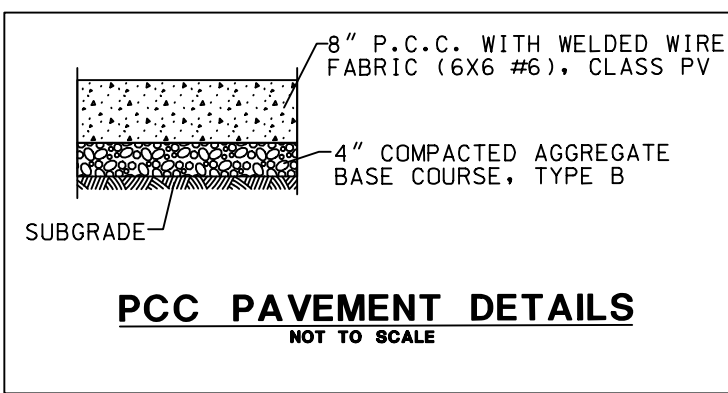
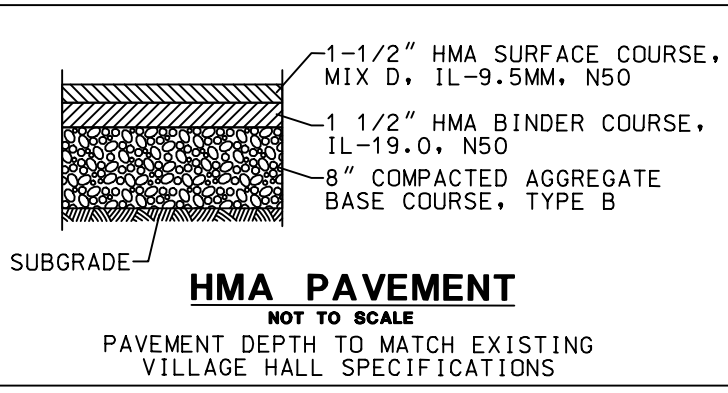
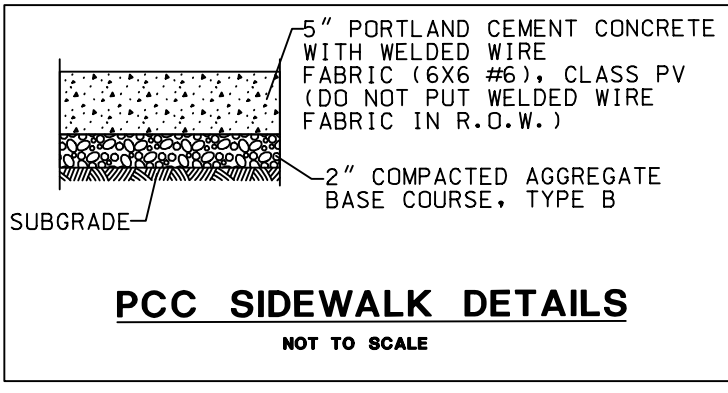
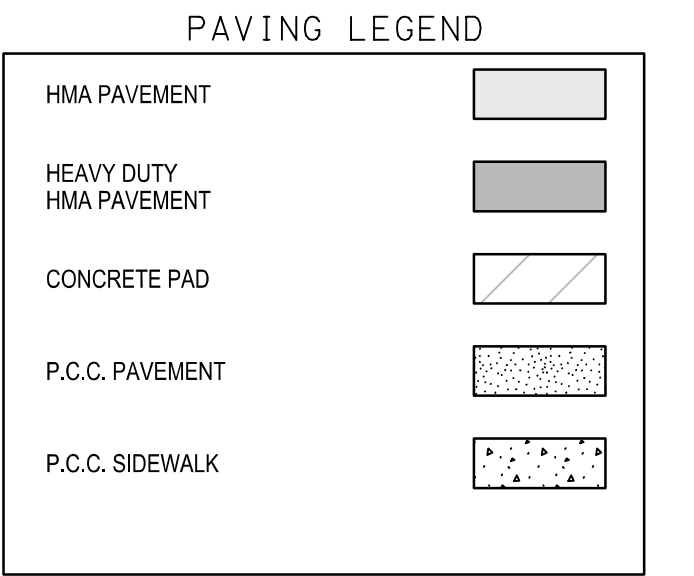
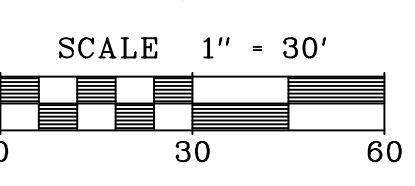

Mackie Consultants, LLC
 9575 W. Higgins Road, Suite 500
 Rosemont, IL 60018
 (847)696-1400
 www.mackieconsult.com

CLIENT:
VILLAGE OF ARLINGTON HEIGHTS
 200 EAST SIGWALT STREET
 ARLINGTON HEIGHTS, ILLINOIS 60005
 PHONE: 847-368-5250

DATE	DESCRIPTION OF REVISION	BY
01-27-17	REVISED PER VILLAGE COMMENTS	JAD
	DESCRIPTION OF REVISION	

DESIGNED	KJM
DRAWN	MSR
APPROVED	KJM
DATE	01/04/2017
SCALE	1" = 30'

PRELIMINARY PAVING PLAN
ARLINGTON HEIGHTS POLICE STATION
ARLINGTON HEIGHTS, ILLINOIS

SHEET
C-104
 PROJECT NUMBER: 2930
 © MACKIE CONSULTANTS LLC, 2017
 ILLINOIS FIRM LICENSE 184-002694

1/10/2017 11:40:50 AM M:\2017\Engineering\Photos\Drawings\1004 - Paving Plan.dwg

AMBULANCE TURNING MOVEMENTS

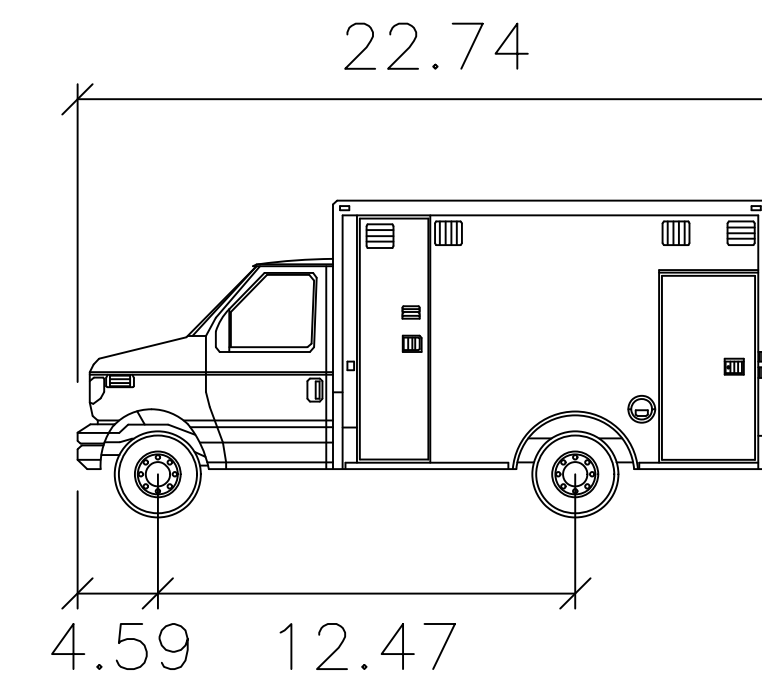
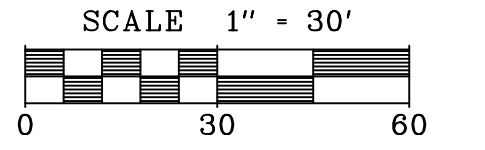

AMBULANCE	FEET
Width	: 7.71
Track	: 7.71
Lock to Lock Time	: 6.0
Steering Angle	: 47.8

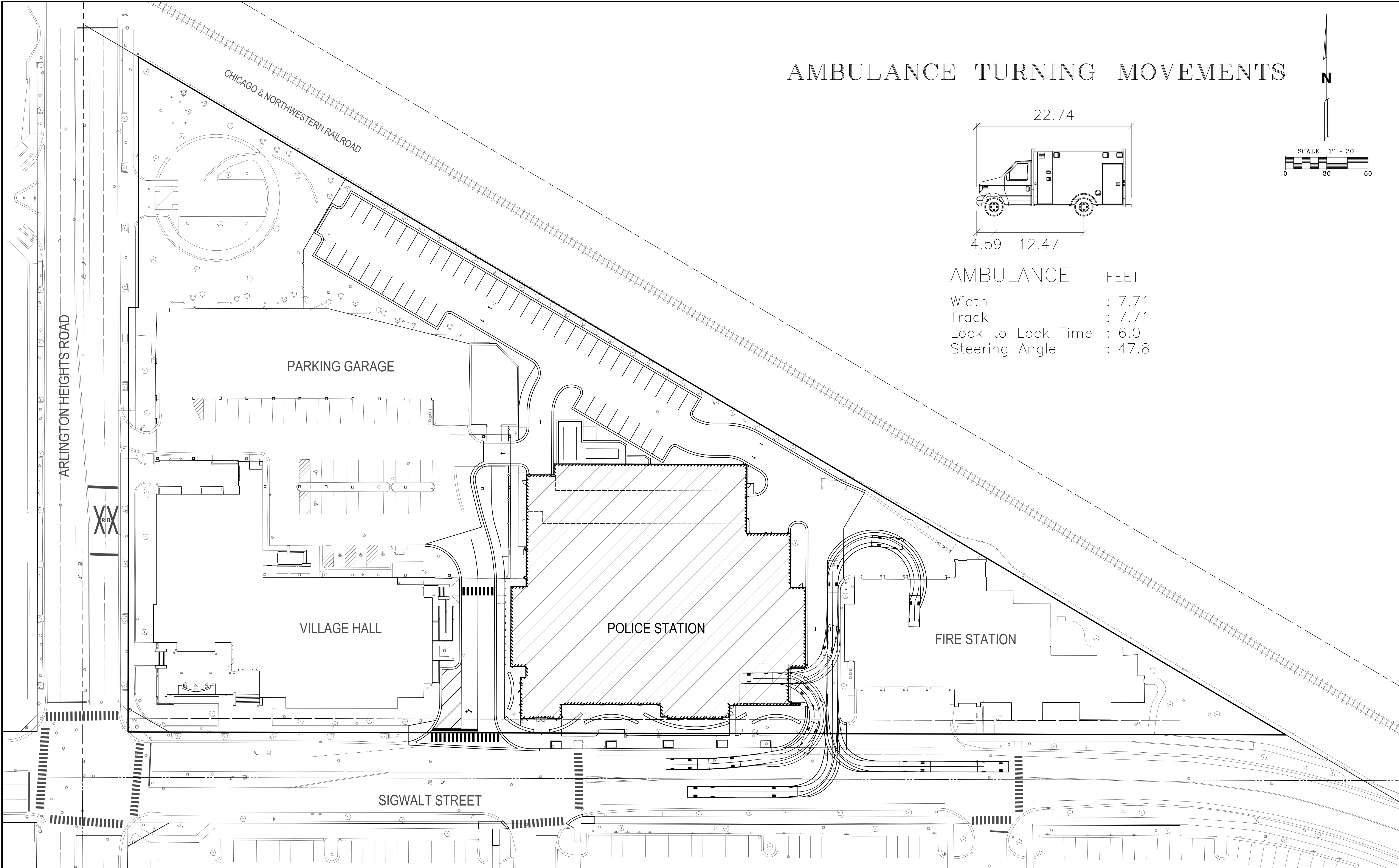

1/10/2017 11:09:26 AM M:\2017\Engineering\Projects\Arlington Heights - Ambulance\Arlington Heights - Ambulance.dwg

Mackie Consultants, LLC
 9575 W. Higgins Road, Suite 500
 Rosemont, IL 60018
 (847)696-1400
 www.mackieconsult.com

CLIENT:
VILLAGE OF ARLINGTON HEIGHTS
 200 EAST SIGWALT STREET
 ARLINGTON HEIGHTS, ILLINOIS 60005

DATE	DESCRIPTION OF REVISION	BY
01-27-17	REVISED PER VILLAGE COMMENTS	JAD

DESIGNED	KJM
DRAWN	MSR
APPROVED	KJM
DATE	01/04/2017
SCALE	1" = 30'

AMBULANCE TURNING MOVEMENT PLAN
ARLINGTON HEIGHTS POLICE STATION
ARLINGTON HEIGHTS, ILLINOIS

SHEET
C-105
 PROJECT NUMBER: 2930
 © MACKIE CONSULTANTS, LLC, 2017
 ILLINOIS FIRM LICENSE 184-002694

FIRE TRUCK TURNING MOVEMENTS

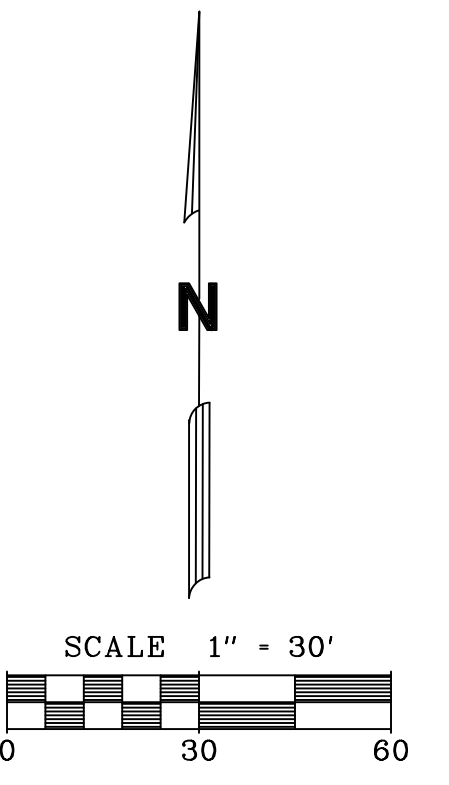
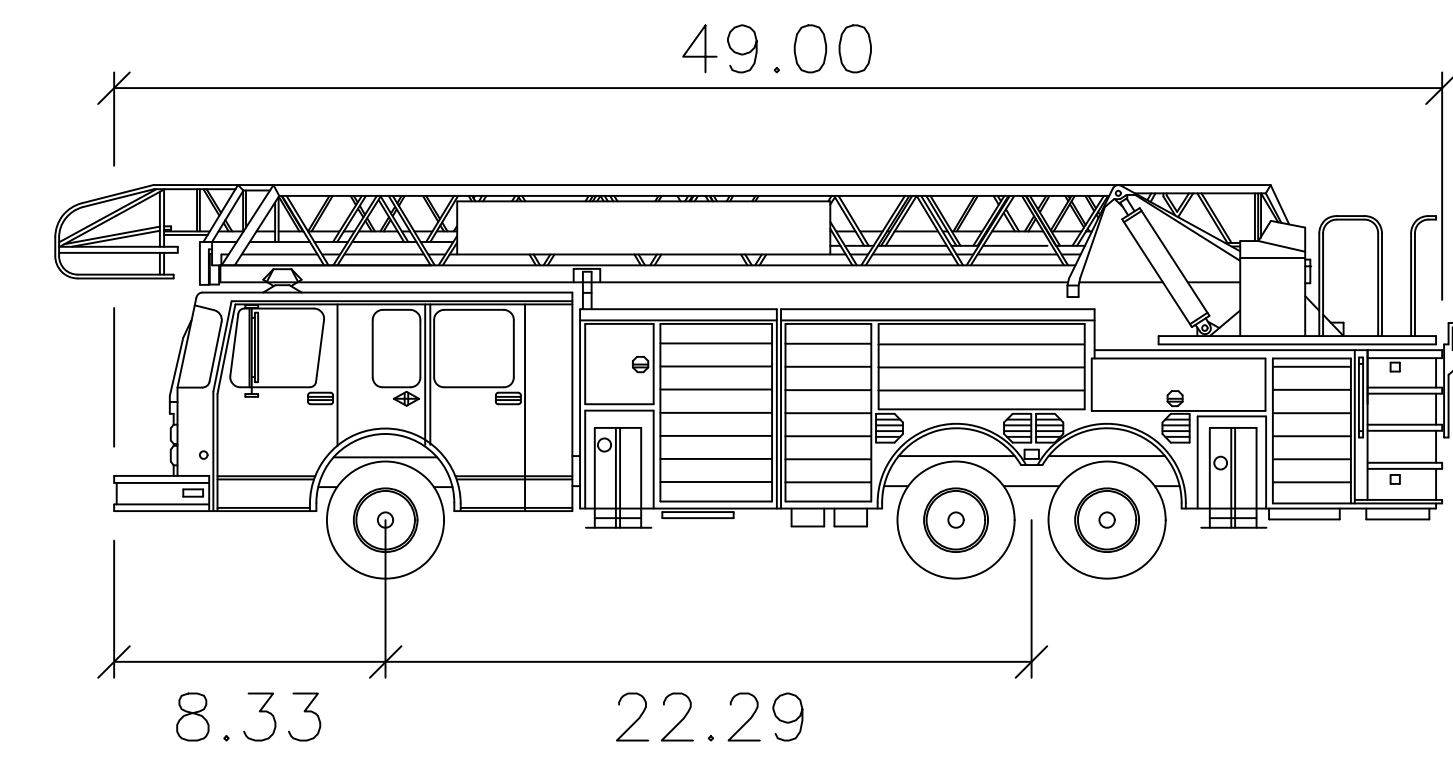

Arlington Heights Fire Truck 133 Feet

- Width : 8.66
- Track : 8.00
- Lock to Lock Time : 6.0 s
- Steering Angle : 40.0°

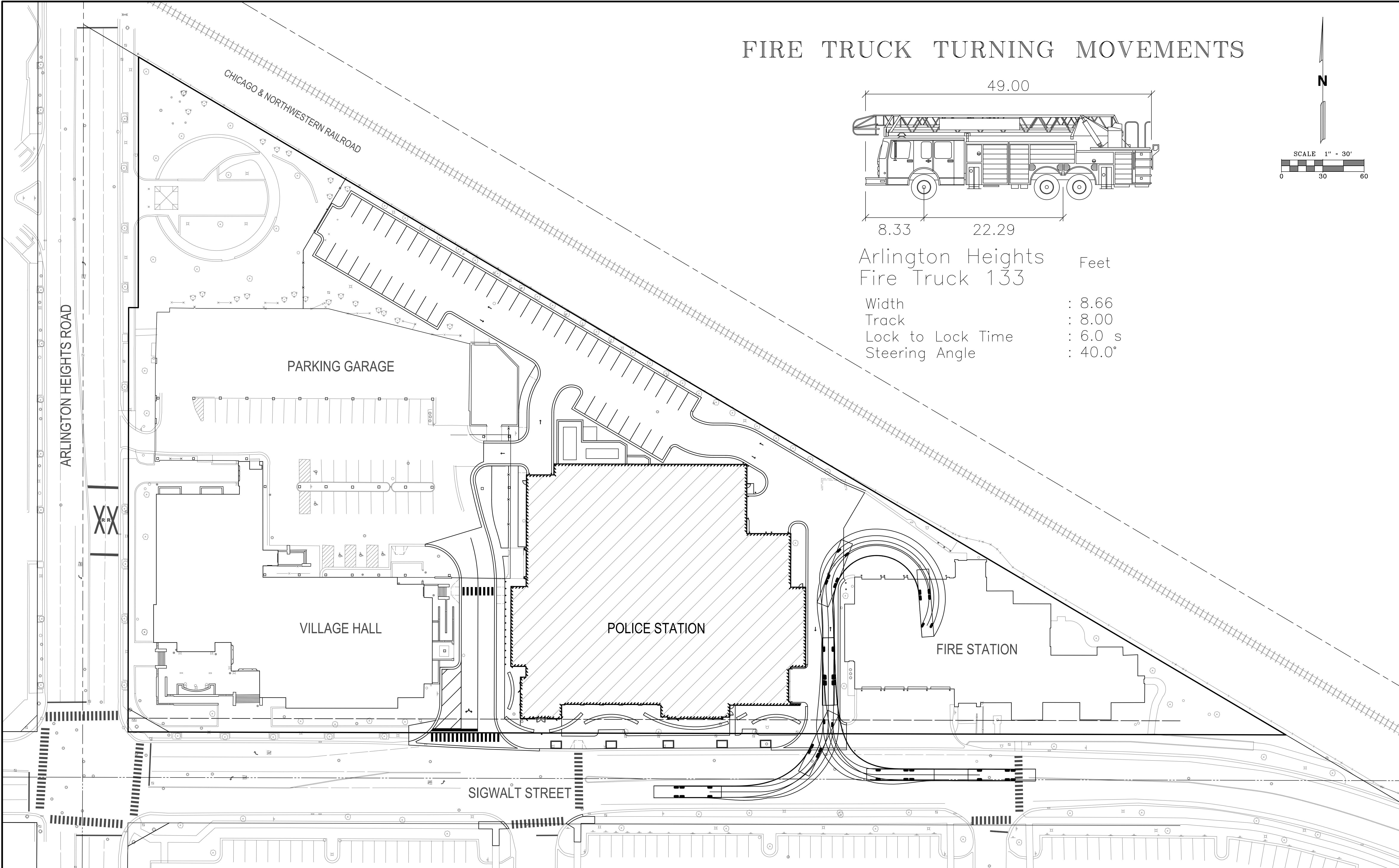

1/20/2017 11:01:11 AM M:\2017\Engineering\Projects\Arlington Heights - Fire Truck\ - Fire Truck.dwg

Mackie Consultants, LLC
 9575 W. Higgins Road, Suite 500
 Rosemont, IL 60018
 (847) 696-1400
 www.mackieconsult.com

CLIENT:
VILLAGE OF ARLINGTON HEIGHTS
 200 EAST SIGWALT STREET
 ARLINGTON HEIGHTS, ILLINOIS 60005

DATE	DESCRIPTION OF REVISION	BY
01-27-17	REVISED PER VILLAGE COMMENTS	JAD

DESIGNED	KJM
DRAWN	MSR
APPROVED	KJM
DATE	01/04/2017
SCALE	1" = 30'

FIRE TRUCK TURNING MOVEMENT PLAN
ARLINGTON HEIGHTS POLICE STATION
ARLINGTON HEIGHTS, ILLINOIS

SHEET
C-106
 PROJECT NUMBER: 2930
 © MACKIE CONSULTANTS, LLC, 2017
 ILLINOIS FIRM LICENSE 184-002694

POLICE INTERCEPTOR TURNING MOVEMENTS

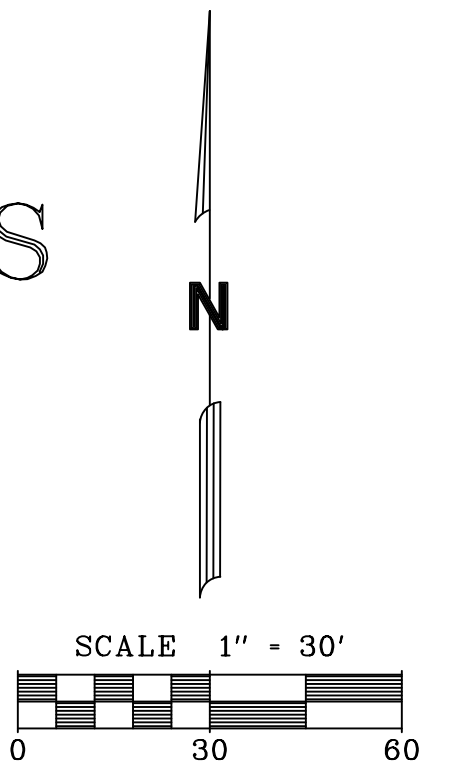
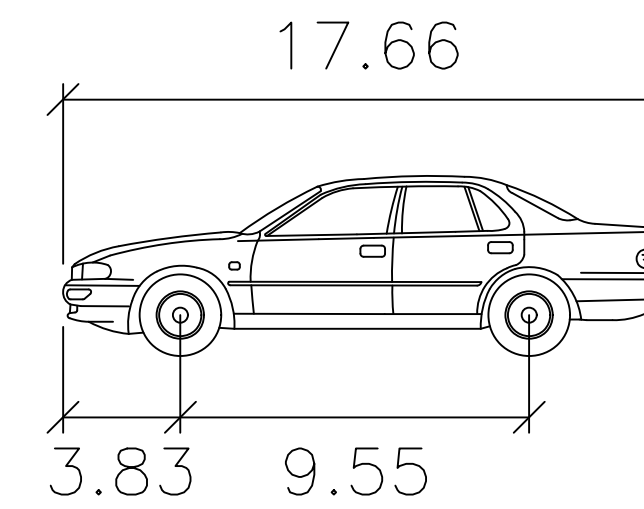

Arlington Heights	Feet
Police Interceptor	
Width	: 7.52
Track	: 6.52
Lock to Lock Time	: 6.0 s
Steering Angle	: 31.6°

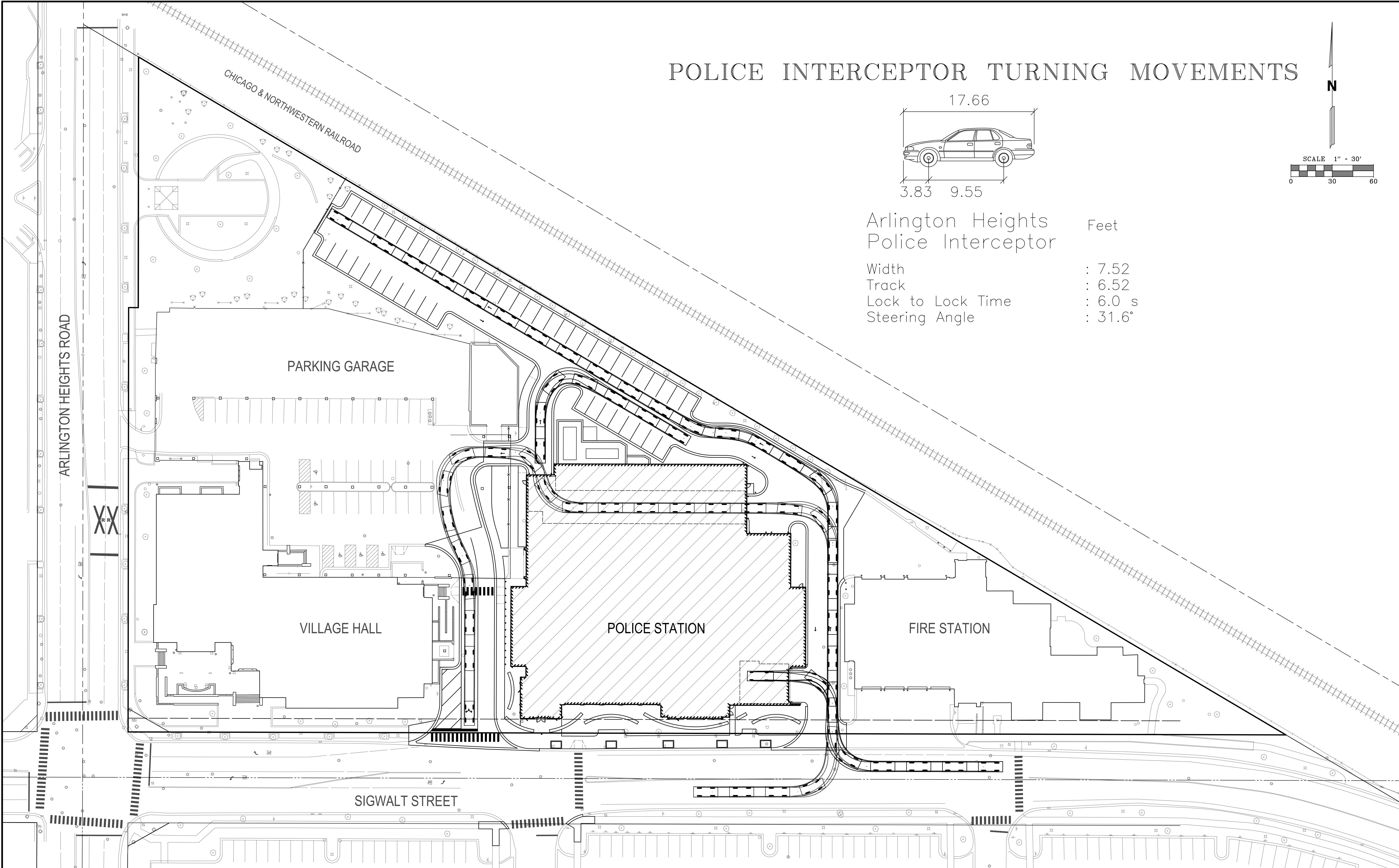

1/20/2017 11:20:45 AM M:\2017\Engineering\Photos\Drawings\1007 - Vehicle Turning Movement Exhibit - Speed Control

Mackie Consultants, LLC
 9575 W. Higgins Road, Suite 500
 Rosemont, IL 60018
 (847)696-1400
 www.mackieconsult.com

CLIENT:
VILLAGE OF ARLINGTON HEIGHTS
 200 EAST SIGWALT STREET
 ARLINGTON HEIGHTS, ILLINOIS 60005
 PHONE: 847-368-5250

DATE	DESCRIPTION OF REVISION	JAD BY
01-27-17	REVISED PER VILLAGE COMMENTS	JAD

DESIGNED	KJM
DRAWN	MSR
APPROVED	KJM
DATE	01/04/2017
SCALE	1" = 30'

POLICE INTERCEPTOR TURNING MOVEMENT PLAN
ARLINGTON HEIGHTS POLICE STATION
ARLINGTON HEIGHTS, ILLINOIS

SHEET
C-107
 PROJECT NUMBER: 2930
 © MACKIE CONSULTANTS, LLC, 2017
 ILLINOIS FIRM LICENSE 184-002694

SU-30 TRUCK TURNING MOVEMENTS

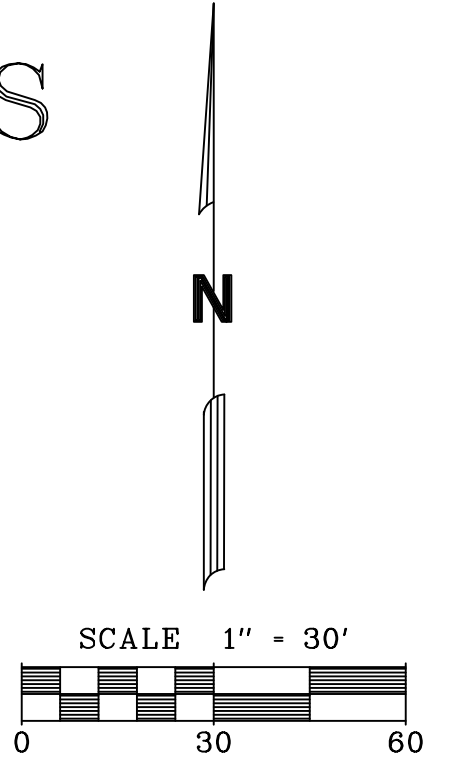
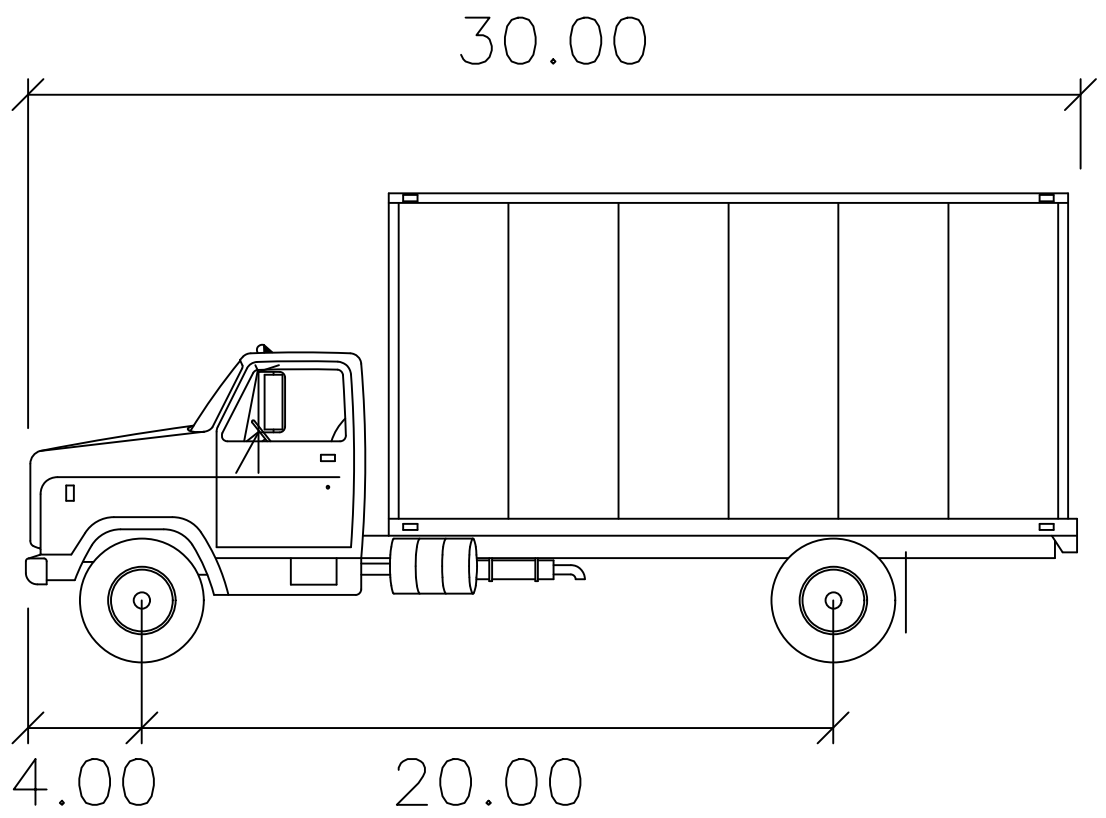

SU-30	feet
Width	: 8.00
Track	: 8.00
Lock to Lock Time	: 6.0 S
Steering Angle	: 31.6°

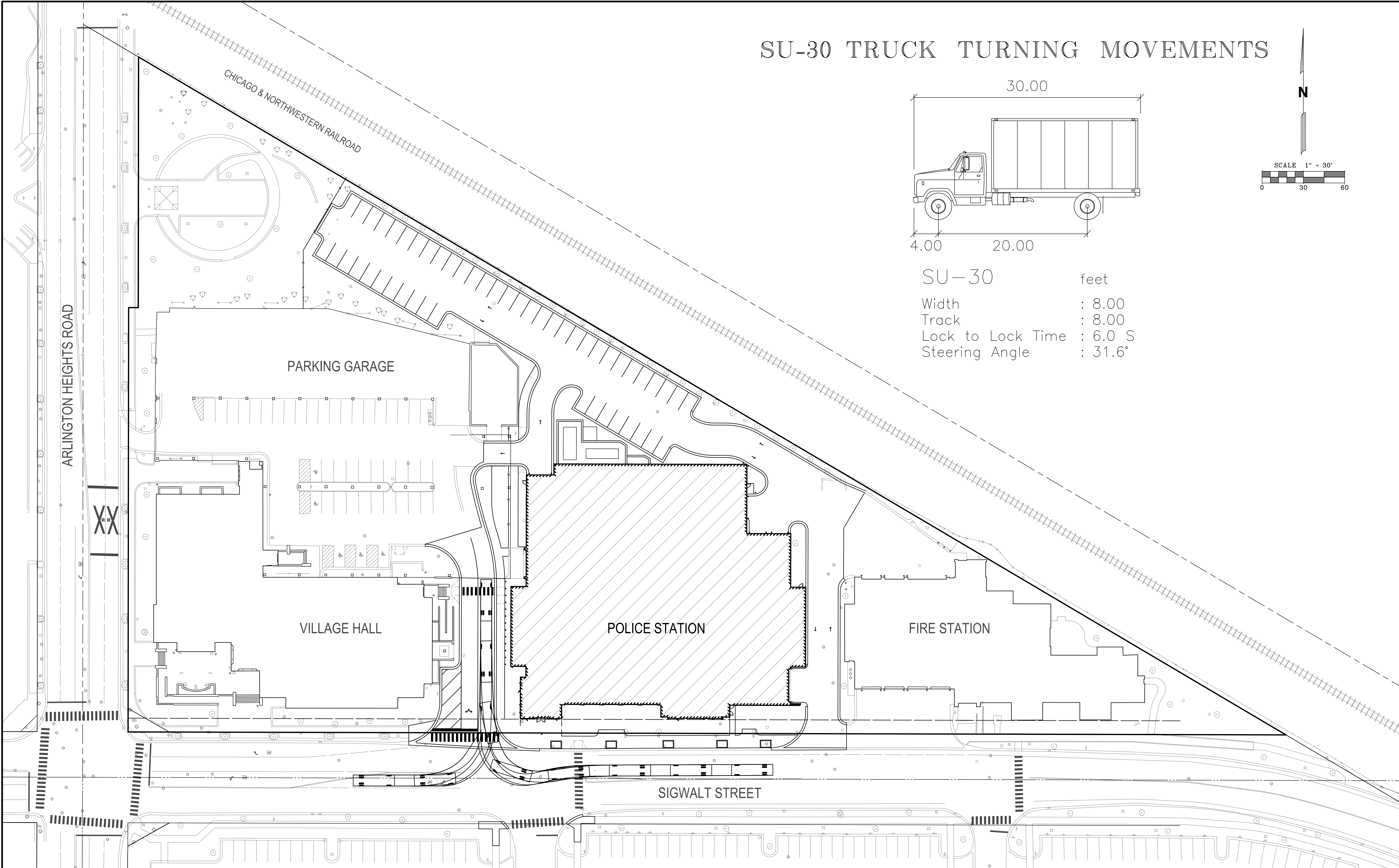

1/20/2017 TPT/MS_MW 141252017 Engineering Photo Preliminary LC08 - Vehicle Turning Movement Exhibit - SU-30.dwg

Mackie Consultants, LLC
 9575 W. Higgins Road, Suite 500
 Rosemont, IL 60018
 (847)696-1400
 www.mackieconsult.com

CLIENT:
VILLAGE OF ARLINGTON HEIGHTS
 200 EAST SIGWALT STREET
 ARLINGTON HEIGHTS, ILLINOIS 60005
 PHONE: 847-368-5250

DESIGNED	KJM	DATE	01/04/2017
DRAWN	MSR	BY	JAD
APPROVED	KJM	DATE	01/04/2017
DATE	01-27-17	DESCRIPTION OF REVISION	REVISED PER VILLAGE COMMENTS
SCALE	1" = 30'		

SU-30 TURNING MOVEMENT PLAN
ARLINGTON HEIGHTS POLICE STATION
ARLINGTON HEIGHTS, ILLINOIS

SHEET
C-108
 PROJECT NUMBER: 2930
 © MACKIE CONSULTANTS, LLC, 2017
 ILLINOIS FIRM LICENSE 184-002694