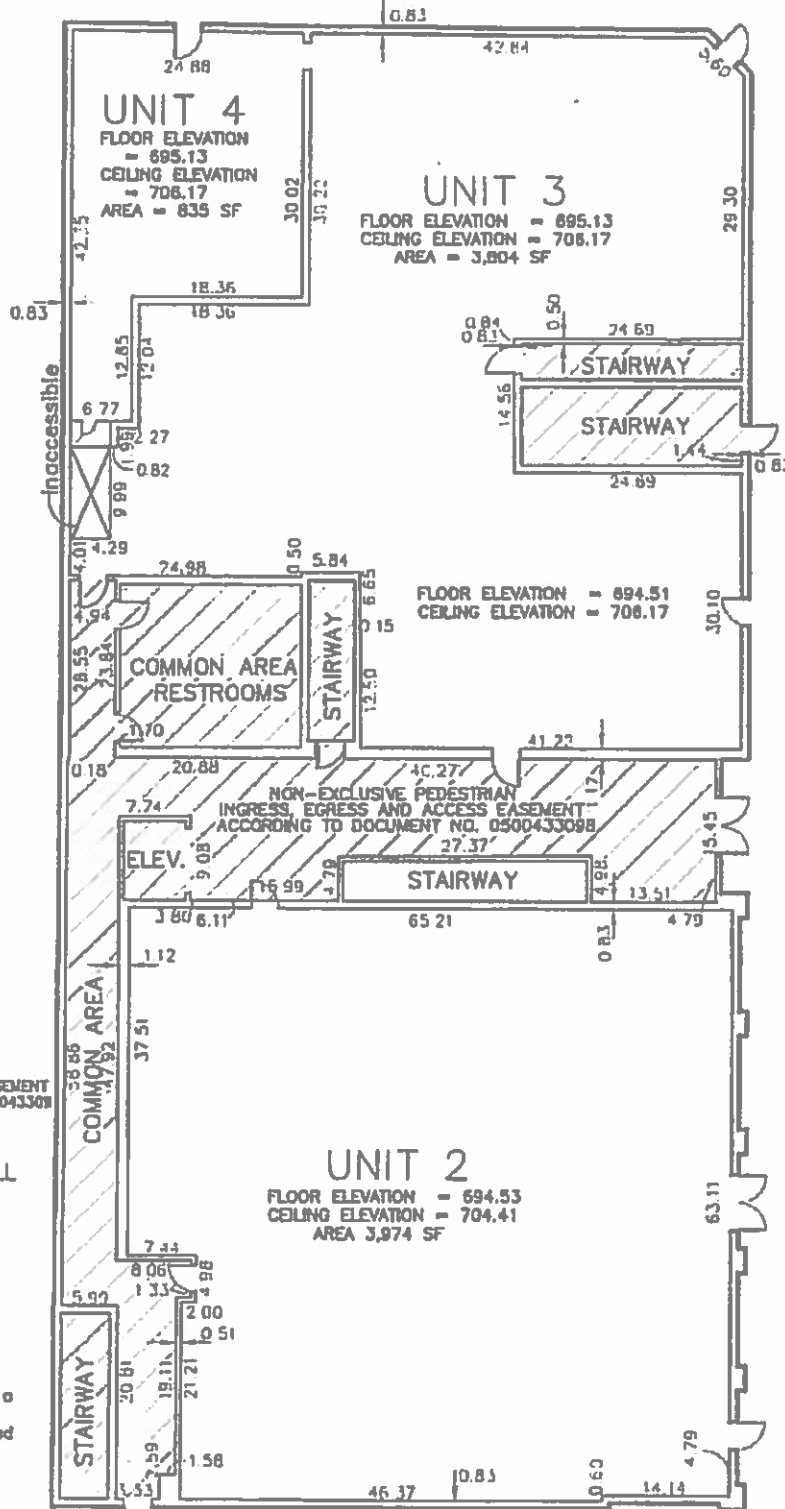

Exhibit C to Declaration of Condominium Ownership for Metropolis-Hagenbring Condominium



RECEIVED
SEP 18 2017
PLANNING & COMMUNITY
DEVELOPMENT DEPARTMENT



COMMON AREA
NON-EXCLUSIVE PEDESTRIAN
INGRESS, EGRESS AND ACCESS EASEMENT
ACCORDING TO DOCUMENT NO. 050043308

HORIZONTAL MEASUREMENTS
ARE FROM FACE OF DRYWALL
TO FACE OF DRYWALL

VERTICAL MEASUREMENTS
ARE FROM FINISHED FLOOR
TO FINISHED CEILING.

NOTE: Only those Building Line
Restrictions or Easements shown on a
Recorded Subdivision Plot are shown
hereon unless the descriptions ordered
to be surveyed contains a proper
description of the required building
lines or easements.

ALL DISTANCES IN FEET AND DECIMAL
PARTS THEREOF. NO DIMENSIONS TO
BE ASSUMED FROM SCALING.

Compare your description and site markings
with this plot and AT ONCE report any
discrepancies which you may find.

FIRST FLOOR

UPDATED: 12/13/06 UPDATED: 01/21/2013
 UPDATED: 05/09/06 UPDATED: 2/08/07
 DATE PREPARED: 05/08/05 SHEET 3 OF 4



STATE OF ILLINOIS
COUNTY OF COOK SS
 THIS PROFESSIONAL SERVICE conforms to the
 CANONICAL STANDARDS, ETHICS AND CONDUCT OF SURVEYORS
 APPLICABLE FOR A SURVEYOR SURVEY.
 WHEELING, ILLINOIS, AUG 2013
 BY: *[Signature]*
 ILLINOIS PROFESSIONAL LAND SURVEYOR
 LICENSE EXPIRES AUGUST 31, 2014
 PLS# 03 184-091132

EXHIBIT C
DECLARATION OF CONDOMINIUM OWNERSHIP
METROPOLIS LOT 3 COMMERCIAL CONDOMINIUM
ARLINGTON HEIGHTS, ILLINOIS

CONSULTING, INC.
INFRACON & GEOCON e-mail: info@geocoinc.com
 CONSULTING CIVIL ENGINEERS & LAND SURVEYORS
 200 WILSON DRIVE, WHEELING, ILLINOIS 60090-1914 (847) 218-1133 FAX (847) 218-1177
 DIRECTOR: FIELD CHIEF: DJ & CJ DRAWING: JF, JCK
 SHERRY PROPERTIES, LLC FIELD WORK: 04/01/05 SCALE: 1"=20'

PROJECT NO.
87-304