

120-122 Boeger Drive Construction Phasing Plan

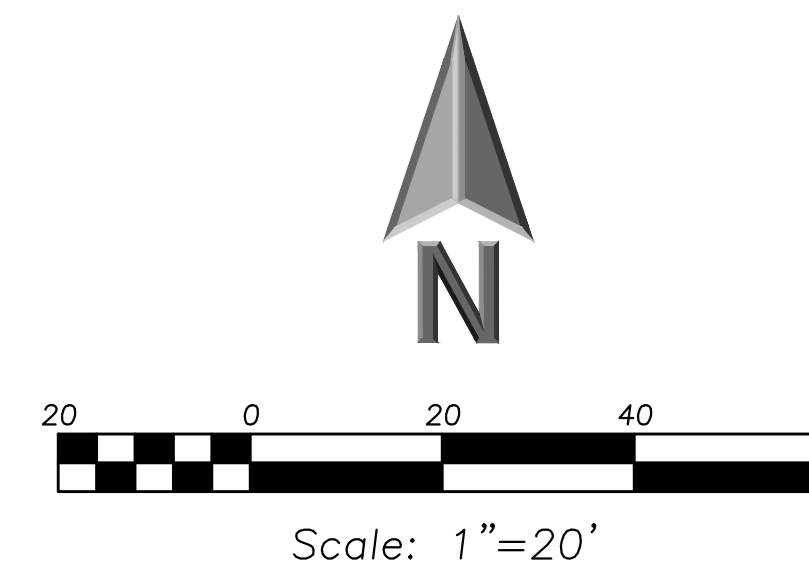

GEOMETRY NOTES

- All Dimensions Contained Herein Reference Back Of Curb, Face Of Retaining Wall, Edge Of Pavement, Center Of Structure And Outside Face Of Building Foundation Unless Otherwise Noted.
- All Pavement Striping Shall Be 4" Wide Yellow Paint Per Specifications. All Cross Hatch Striping Shall Be 45" At 2'-0" Centers.
- All Accessible Parking Signs (R7-B) Must Be Placed at the Center of the Space and Within 5 Feet of the Space.
- Refer to Architectural Drawings for Exact Locations of All Buildings.
- Traffic Sign Posts Shall Be Breakaway Green U-Channel Posts, 2-lb/ft, 11 Gauge Steel, Embedded 42" Minimum Into Ground.

LEGEND

EXISTING	PROPOSED
Manhole	Manhole
Catch Basin	Catch Basin
Inlet	Inlet
Area Drain	Area Drain
Clean Out	Clean Out
Flared End Section	Flared End Section
Storm Sewer	Storm Sewer
Sanitary Sewer	Sanitary Sewer
Combined Sewer	Combined Sewer
Water Main	Water Main
Gas Line	Gas Line
Overhead Wires	Overhead Wires
Electrical Cable (Buried)	Electrical Cable (Buried)
Telephone Line	Telephone Line
Fire Hydrant	Fire Hydrant
Valve Vault	Valve Vault
Buffalo Box	Buffalo Box
Downspout	Downspout
Bollard	Bollard
Gas Valve	Gas Valve
Gas Meter	Gas Meter
Electric Meter	Electric Meter
ComEd Manhole	ComEd Manhole
Hand Hole	Hand Hole
Light Pole	Light Pole
Light Pole w/ Mast Arm	Light Pole w/ Mast Arm
Utility Pole	Utility Pole
Telephone Pedestal	Telephone Pedestal
Telephone Manhole	Telephone Manhole
Sign	Sign
Fence	Fence
Accessible Parking Stall	Accessible Parking Stall
Curb & Gutter	Curb & Gutter
Depressed Curb	Depressed Curb
Curb Elevation	Curb Elevation
Gutter Elevation	Gutter Elevation
Pavement Elevation	Pavement Elevation
Sidewalk Elevation	Sidewalk Elevation
Ground Elevation	Ground Elevation
Top of Retaining Wall Elevation	Top of Retaining Wall Elevation
Swale	Swale
Contour Line	Contour Line
Deciduous Tree	Deciduous Tree
Coniferous Tree	Coniferous Tree
Brushline	Brushline
Tree Protection Fencing at Drip Line	Tree Protection Fencing at Drip Line

GENERAL NOTES

- The Location of Existing Underground Utilities, Such As Watermains, Sewers, Gas Lines, Etc., As Shown On The Plans, Has Been Determined From The Best Available Information and is Given For The Convenience of The Contractor. However, The Owner and The Engineer Do Not Assume Responsibility In The Event That During Construction, Utilities Other Than Those Shown May Be Encountered, and That The Actual Location of Those Which Are Shown May Be Different From The Location As Shown On The Drawings. Contact Engineer Immediately If Surface and/or Subsurface Features Are Different Than Shown On The Drawings.
- Notify The Engineer Without Delay of Any Discrepancies Between The Drawings and Existing Field Conditions.
- Notify The Owner, Engineer and The Village of Arlington Heights A Minimum of 48 Hours in Advance of Performing Any Work.
- All Areas, On or Off Site, Disturbed During Construction Operations and Not Part of the Work As Shown Hereon Shall Be Restored to Original Condition to the Satisfaction of the Owner at No Additional Cost to the Owner. It is Incumbent Upon the Contractor to Show That Damaged Areas Were Not Disturbed By Construction Operations.
- These Drawings Assume That the Contractor Will Utilize An Electronic Drawing File (DWG) and Stake All Site Improvements Accordingly.
- No Person May Utilize The Information Contained Within These Drawings Without Written Approval From Eriksson Engineering Associates, Ltd.
- The Engineer is Furnishing These Drawings For Construction Purposes As A Convenience To The Owner, Architect, Surveyor, or Contractor. Prior To The Use Of These Drawings For Construction Purposes, The User Of This Media Shall Verify All Dimensions And Locations Of Buildings With The Foundation Drawings And Architectural Site Plan, and Coordinate All Dimensions and Locations of All Site Items. If Conflicts Exist The User Of This Information Shall Contact The Engineer Immediately.
- Provide An As-built Survey Prepared By A Licensed Professional Land Surveyor In Accordance With The Authorities Having Jurisdiction Which Shall Include As a Minimum All Detention Basins and Best Management Practices, Include All Storm and Sanitary Sewers, Structure Locations, Sizes, Rim and Invert Elevations, Watermain and Valve and Appurtenance Locations.
- The Illinois Department Of Transportation Standard Specifications For Road And Bridge Construction Latest Edition, And All Addenda Thereto, Shall Govern The Earthwork And Paving Work Under This Contract Unless Noted Otherwise.

1st Phase - Sewer & Water, Underground Detention, and Asphalt Parking

2nd Phase - Building Construction to commence upon completion of the 1st Phase.

Construction Parking - 2 to 20 vehicles depending on stage of construction. 1st Phase of construction includes establishing the on-site parking lot which will be used for worker parking during the 2nd Phase of construction. During the 2nd Phase, some offsite parking will be required while wall panels and trusses are staged and a crane is used to install said materials

Construction Material Staging - Materials will generally be brought to the site on an as needed basis. For the 1st Phase, necessary materials will be staged in the 2nd Phase area. In the 2nd Phase, the wood framed building will utilize panelized wall construction and prefabricated floor and roof trusses that will be craned into place. 3 to 4 construction storage trailers are expected for onsite material storage and will be placed in the parking lot.

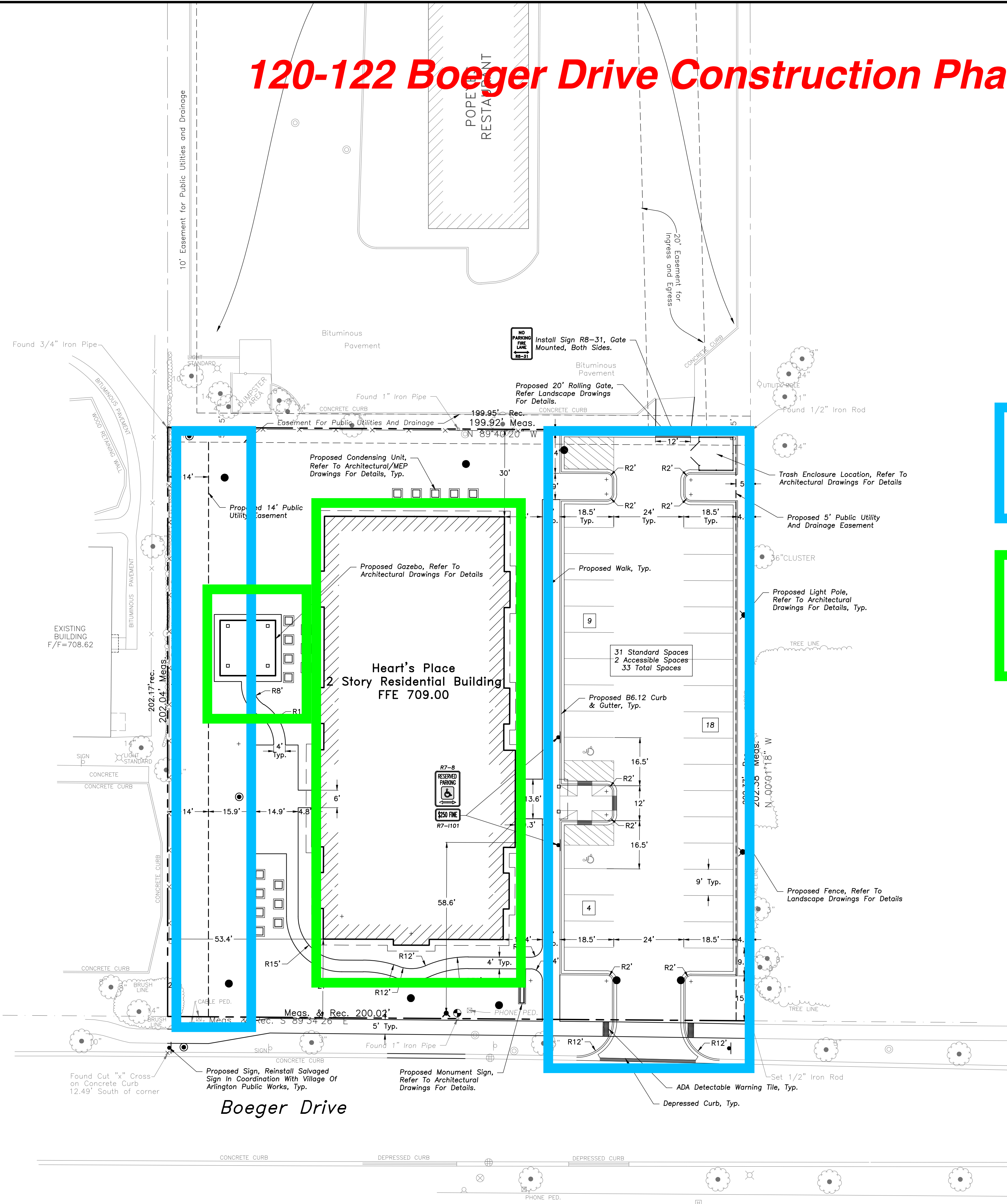

ERIKSSON ENGINEERING ASSOCIATES, LTD.
 145 COMMERCE DRIVE, SUITE A
 GRAYSLAKE, ILLINOIS 60030
 PHONE (847) 223-4804
 FAX (847) 223-4864
 EMAIL INFO@EEA-LTD.COM
 PROFESSIONAL DESIGN FIRM
 LICENSE NO. 184-003220
 EXPIRES: 04/30/2017

HEART'S PLACE
2 STORY RESIDENTIAL BUILDING
 120 & 122 W Boeger Drive
 Arlington Heights, Illinois

Reserved for Seal:
 Expiration Date: _____

No.	Date	Description
1	1/30/17	PUD SUBMITTAL
2	3/23/17	PUD REVIEW COMMENTS
3	4/07/17	PUD REVIEW COMMENTS 2
4	12/12/17	FINAL PUD SUBMITTAL

© ERIKSSON ENGINEERING ASSOCIATES, LTD., 2017
 ALL RIGHTS RESERVED. THIS DRAWING IS THE PROPERTY OF ERIKSSON ENGINEERING ASSOCIATES, LTD. NO REPRODUCTION OR PART OF THIS DRAWING IS PERMITTED WITHOUT THE WRITTEN CONSENT OF ERIKSSON ENGINEERING ASSOCIATES, LTD.
 Design By: CDF Date: 01/13/17
 Approved By: MR Project No. _____

Sheet Title:
SITE GEOMETRY PLAN

Sheet No:
C2.0